



Thornkip Place  
Coatbridge  
ML5 4JZ

2   
1   
1 

## Offers Over £110,000

Located in a quiet estate this two bed semi detached property at Thornkip Place Coatbridge would make an ideal purchase for any first time buyer or someone looking to enter the buy to let market.



Home Report Valuation  
£115,000

Council Tax Band

EPC Rating C





The property offers accommodation over two levels, on entering the property from entrance vestibule you will find bright spacious lounge which allows access to dining kitchen with French doors leading to enclosed low maintenance rear garden. On the upper level you will find two bedrooms and family bathroom, the property has been freshly decorated and new carpets throughout.

The property also benefits from driveway to the side which is accessed via double metal leaf gates also allowing access to the rear garden, The property also has monoblock area to the front which would allow further parking if needed.



## Vendor Comments

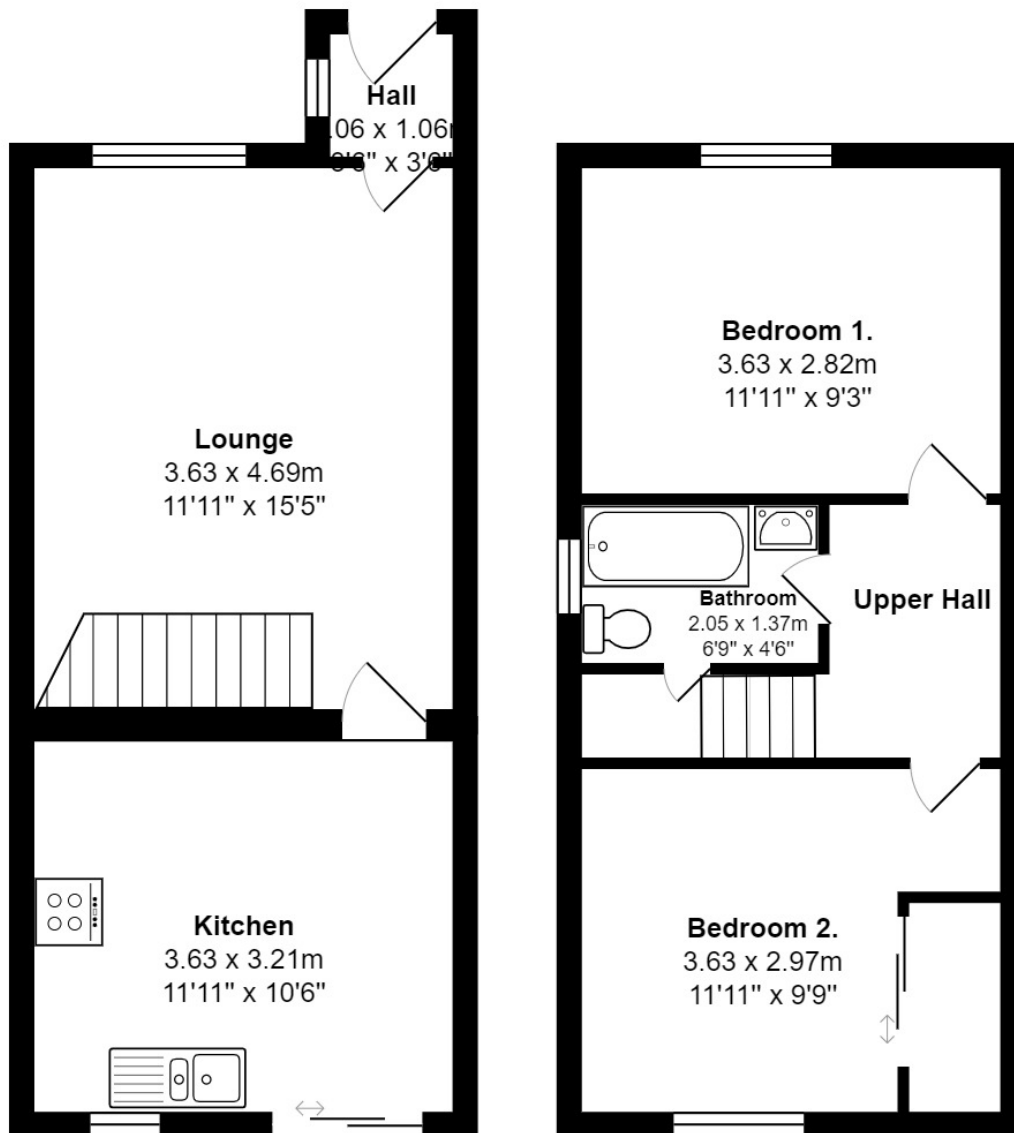

## Location

Thornkip Place is located within a private estate close to local amenities and new primary school and Sports Centre are within walking distance, there are local shops nearby and Coatbridge Town Centre is a short drive away.

Links to the Motorway are nearby which allows direct travel east, west and throughout the central belt.





[www.propertybureau.co.uk](http://www.propertybureau.co.uk)

Glasgow   Stirling   Helensburgh   **Lanarkshire**

**13 Broomknoll Street, Lanarkshire, ML6 6BN**

**[enquiries@propertybureau.co.uk](mailto:enquiries@propertybureau.co.uk)  
01236 758111**

Whilst this brochure has been prepared with care, it is not a report on the condition of the property. Its terms are not warranted and do not constitute an offer to sell. All area and room measurements are approximate only. Floorplans may not be to scale.

