



Mauchline Drive
Coatbridge
ML5 4RT

2 
1 
2 

Offers Over £145,000

A tastefully presented modern mid-terraced house, quietly situated, with open aspects to the front. This walk-in condition home would be an ideal First Time Buy.



Home Report Valuation
£150,000

Council Tax Band C

EPC Rating B



Situated with open aspects to the front this fabulous two bedroom home provides an easily maintained modern property with a bright, spacious feel.

The accommodation consists of well proportioned lounge, fabulous kitchen diner with an array of floor and wall units, stylish WC, two bedrooms and contemporary styled bathroom with over bath shower.

All rooms are tastefully decorated and fixtures and fittings are to an excellent standard.



Warmth is provided by gas fired central heating and double glazing has been installed.

To the rear of the home are gardens designed for ease of maintenance. the gardens are fully enclosed by substantial timber fencing to provide a child and pet safe environment.

Coatbridge has a good selection of shops, restaurants and schools at both Primary and Secondary level within 2 miles. Carnbroe is ideally placed giving quick and easy access to all major motorway networks for commuting throughout the central belt and beyond.



Vendor Comments

12, Mauchline Drive, Coatbridge, ML5 4RT

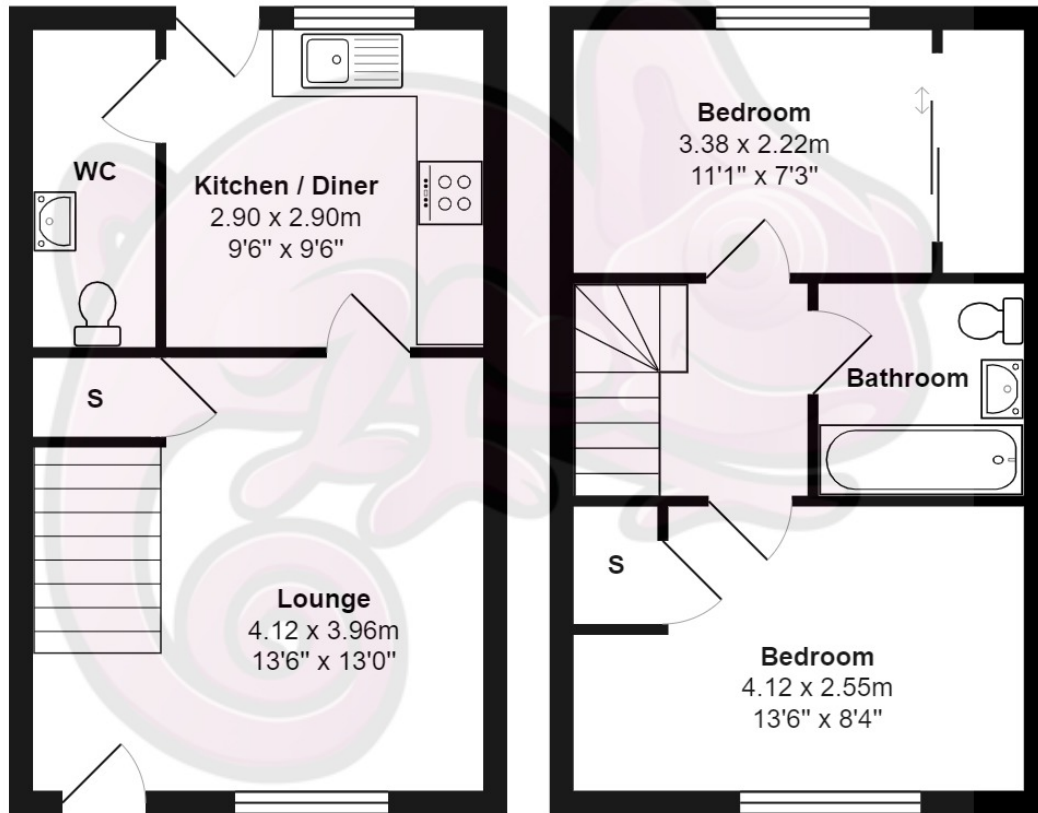

All measurements are approximate and for display purposes only

Location

Coatbridge has a good selection of shops, restaurants and schools at both Primary and Secondary level within 2 miles.

Carnbroe is ideally placed giving quick and easy access to all major motorway networks for commuting throughout the central belt and beyond.





Property
Bureau

www.propertybureau.co.uk

Glasgow

Stirling

Helensburgh

Lanarkshire

13 Broomknoll Street, Lanarkshire, ML6 6BN

enquiries@propertybureau.co.uk
01236 758111

Whilst this brochure has been prepared with care, it is not a report on the condition of the property. Its terms are not warranted and do not constitute an offer to sell. All area and room measurements are approximate only. Floorplans may not be to scale.

