



Neasden Lane, NW10

£325,000



- Two bedrooms
- Communal gardens
- Ground floor flat
- Open plan kitchen/reception
- Close to Jubilee Line
- Gladstone Park nearby

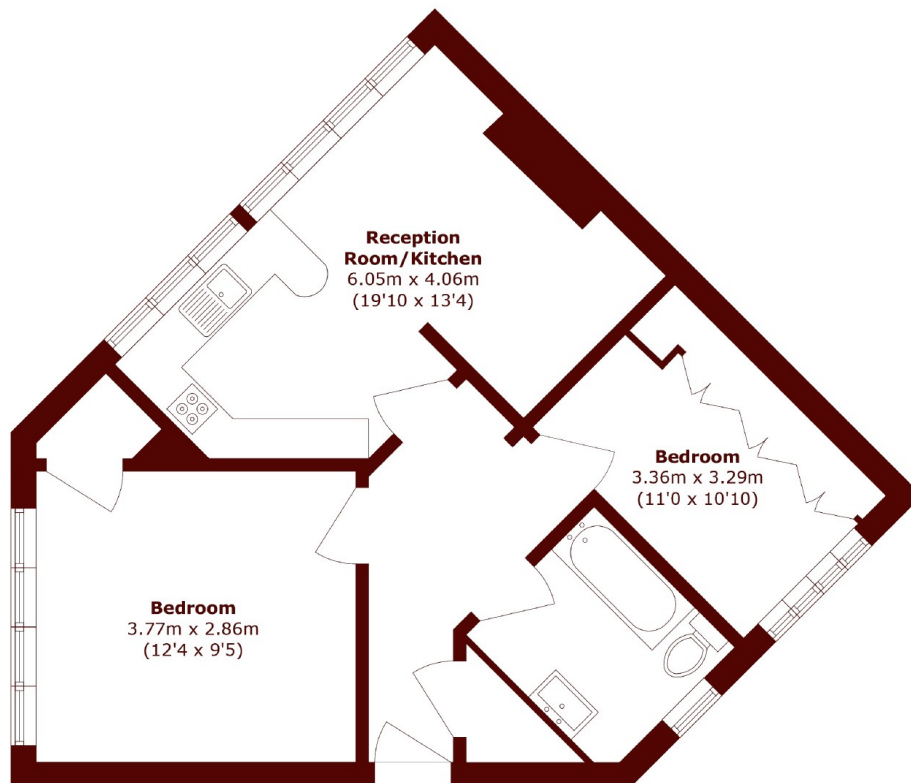

Total area (approx.): 54.7 sq. m (588.7 sq. ft)

Marsh & Parsons Willesden Green

291-293 Willesden Lane,
London, NW2 5HY
020 8451 0420