



**Shanta  
Residential**  
11 Muirend Road  
Glasgow  
G44 3QR  
**0141 255 2828**



## Garry Street, Cathcart, G44 4AY

Shanta Residential is proud to present this gorgeous one bedroom, upper floor flat in Cathcart, Glasgow. You are welcomed into the building via the secure entry system and the flat itself is found on the third floor. This property is presented to the market in not only walk-in condition but true show home condition. The spacious and bright living room boasts lovely bay windows, high ceilings and original cornicing, all sought after features in these traditional tenement homes. Lovingly decorated, the room is stunning and flooded with light which makes for a beautiful sitting area. The living space flows seamlessly into the kitchen, making it ideal for entertaining. The kitchen is modern in design, featuring stylish neutral green wall and floor cabinets, along with integrated appliances that offer a sleek, contemporary finish. The bedroom is generously sized and beautifully decorated, offering ample storage opportunities. A large window allows the natural light to pour in creating a bright, airy atmosphere that's perfect for relaxation. Completing the home is the modern bathroom which features crisp white tiling, a three-piece suite and modern black fixtures for a striking contrast. Garry Street is ideally situated in a prime location on Glasgow's vibrant Southside. A wealth of local amenities is just a short walk away, including shops, bakeries, cafes, and bars. Transport links are enviable with numerous bus routes and being within walking to both Mount Florida and Cathcart train stations - offering quick and convenient travel to the city centre. The area also benefits from close proximity to Hampden Park, which hosts major sporting and music events. For outdoor enthusiasts, the beautiful Queen's Park is just a stroll away, perfect for exercise, picnics, or relaxing in the summer sun. With this property's walk-in condition and prime location, we expect it to be popular and would advise early viewing. For council tax purposes this property sits in band B.

- **One Bedroom**

- **Third Floor Flat**

- **Walk-in Condition**

- **Original Features**

- **Sought After Location**

- **Nearby Amenities**

- **Gas Central Heating**

- **Double Glazing**



Offers Over £120,000



## Floorplan

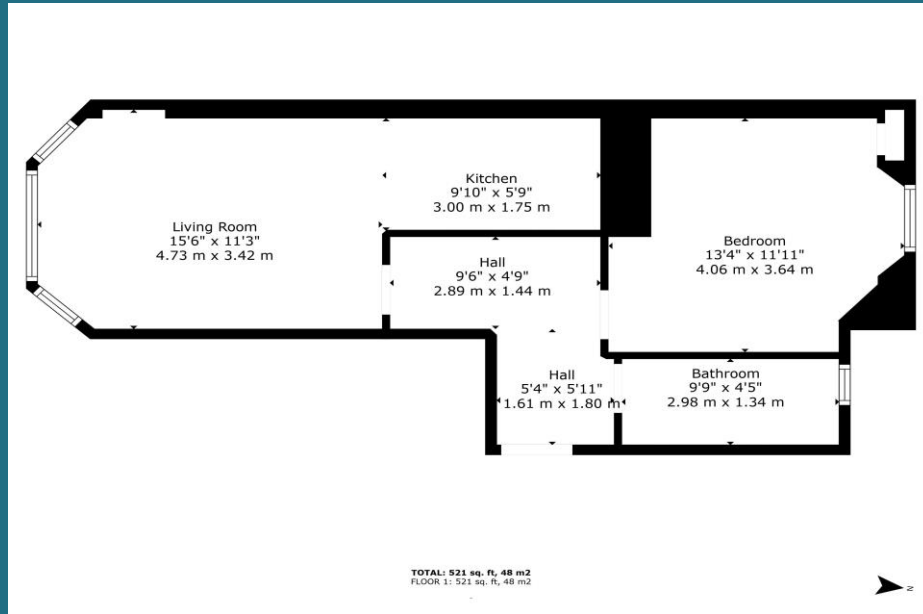

## Map

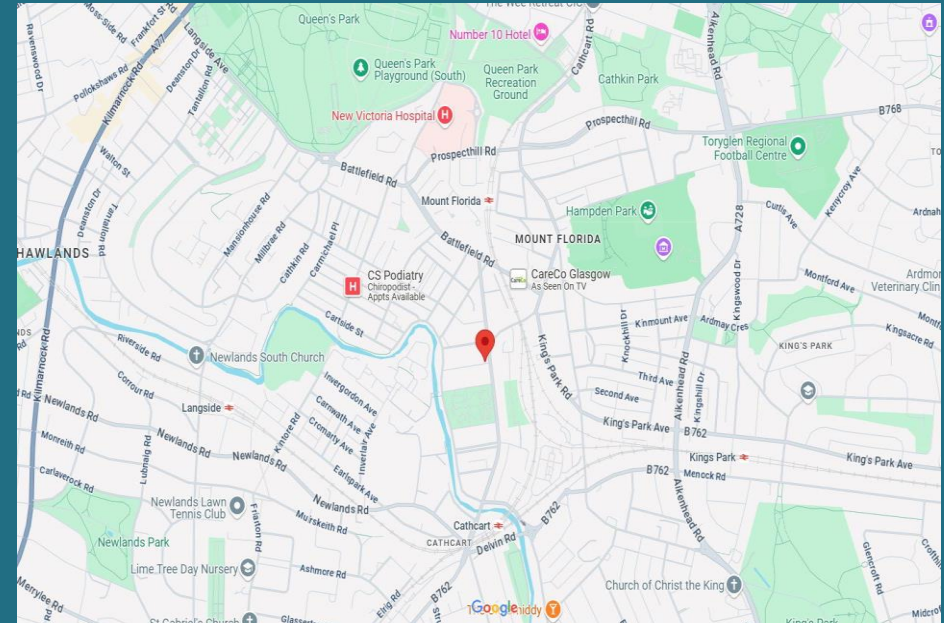

DISCLAIMER: Whilst we try really hard to make our sales details accurate and reliable they should not be relied on as statements or representations of fact. They do not constitute part of an offer or contract. All measurements etc are approximations. The Seller does not make or give nor do we or our employees have authority to make or give any representation or warranty in relation to the property.