

Farebrother

1a Bow Lane , London,  
EC4M 9EE

**OFFICE TO RENT**  
**1,021 SQ FT**

farebrother.com  
020 7405 4545



## DESCRIPTION

### Refurbished, Fitted Offices To Let in the Heart of the City

1a Bow Lane provides 1,021 sqft of refurbished, fully fitted accommodation on the vibrant Bow Lane. The area offers diverse retail, restaurant and leisure amenities within a minute walk of the front door.

The floor includes desks, a meeting room, kitchenette and storage space to a high quality. There is also WCs and a shower/changing room on the top floor which has also been refurbished.







# ACCOMMODATION

FLOOR	AREA (SQ FT)	AVAILABILITY	DESK SUITABILITY NO
3rd Floor Storage Space	54	Available	0 - 0
3rd Floor	216	Available	1 - 3
2nd Floor	751	Available	6 - 11
Total	1,021		

# AMENITIES

Fully Fitted Plug and Play Office Accommodation

24 Hour Access

Great Natural Light

Phone Entry System

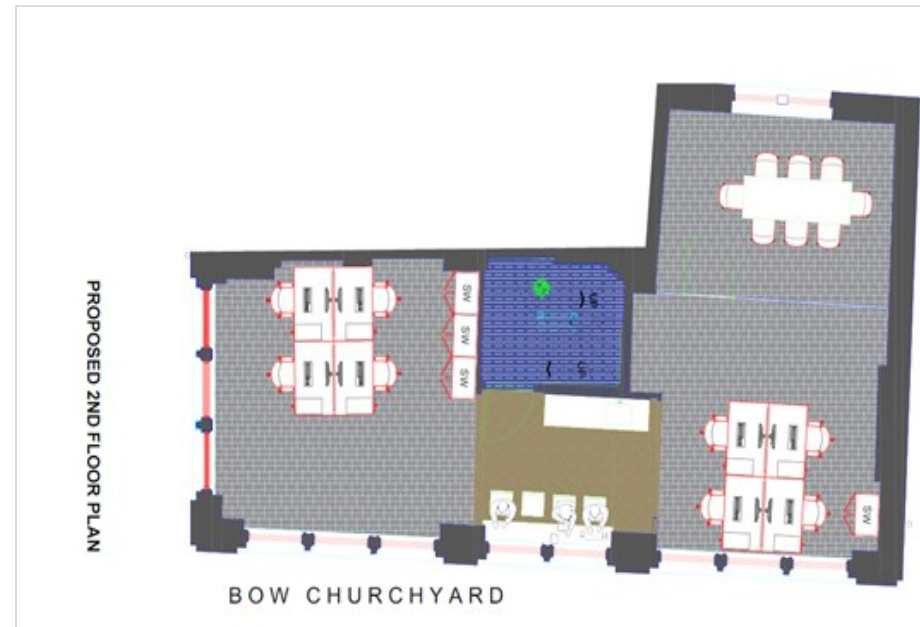

## FURTHER INFORMATION

### Rent

£55.00 psf

### Service Charge

£19.77 psf

### Rates

£18.00 psf

Matthew Causer

Farebrother

07990 975 969

mcauser@farebrother.com

Harvey Widdowson

Farebrother

07732 649308

hwiddowson@farebrother.com

Subject to contract. Farebrother for themselves and the vendor of this property give notice that these particulars do not form, or form part of, any offer or contract. They are intended to give fair description of the property and whilst every effort has been made to ensure their accuracy this cannot be guaranteed. Any intending purchaser must therefore satisfy themselves by inspection or otherwise. Neither Farebrother nor any of its employees, has any authority to make or give any further representations or warranty whatsoever in relation to this property. All prices and rents quoted are net of vat. March 2024

## LOCATION

Fitted offices to let on Bow Lane, which is located within the heart of the City of London and in close proximity to Mansion House, Bank and St Paul's Underground stations.

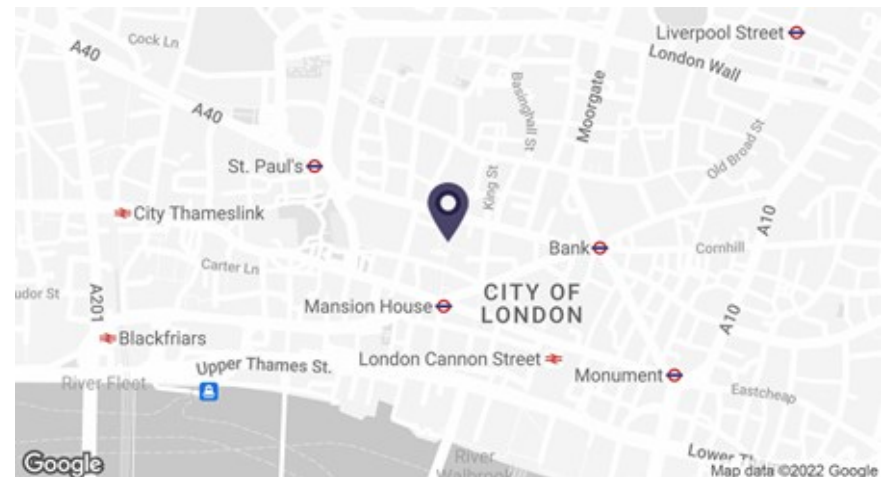

**Farebrother**

EXPERIENCED TRUSTED REAL ESTATE ADVISORS