

USP.

Railway Arches, 45-51
Union Street, London, SE1
ONR

INDUSTRIAL TO RENT
25,005 SQ FT

usp.london
020 3757 7777



Accommodation

Floor	Availability	Area (sq ft)
Arch 45	Under Offer	3,244
Arch 46	Under Offer	3,288
Arch 47	Under Offer	3,702
Arch 48	Under Offer	3,744
Arch 49	Under Offer	3,586
Arch 50	Under Offer	3,391
Arch 51	Under Offer	4,050
TOTAL		25,005

Amenities

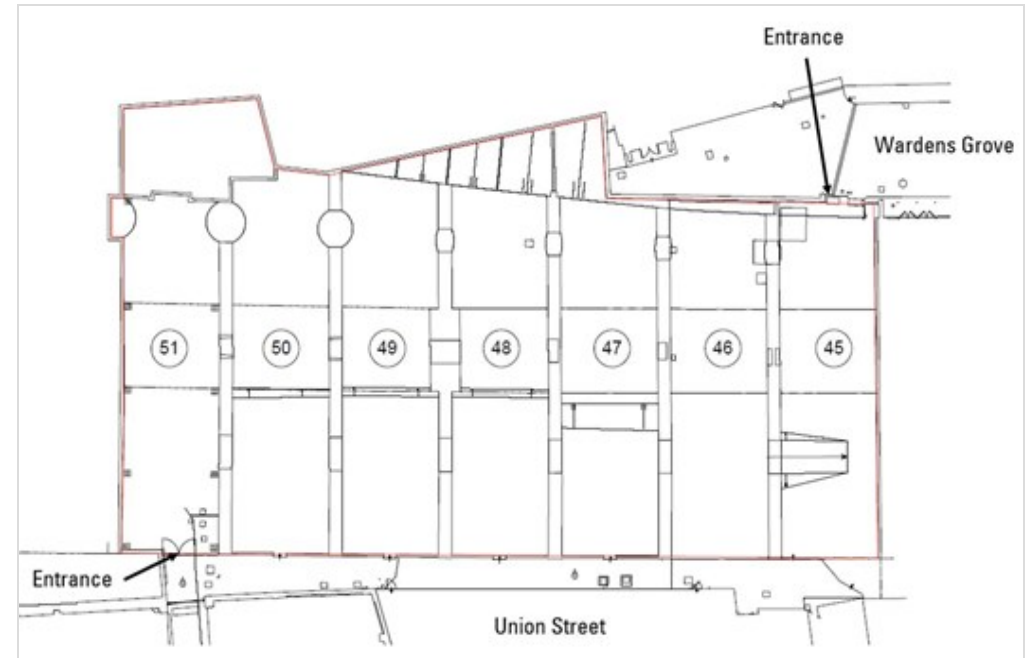



Description

Rare Opportunity - 7 Railway Arches to Let, SE1

A rare opportunity to lease railway arches in the heart of the South Bank. The arches benefit from excellent transfer links and are approximately mid way between London Bridge (Jubilee and Northern Line) and Southwark (Jubilee Line) Stations.

The property comprises a series of 7 railway arches, all interconnecting and has three points of access - two of which are along Union Street and another from Wardens Grove.

Railway Arches, 45-51 Union Street,
London, SE1 0NR

Further Information

Flexbile lease to be agreed with the landlord.

Rent
£11.00 psf

Service Charge
£1.50 psf

Rates
£2.30 psf

Vincent Cheung

USP London

07736 880310

vince@usp.london

Jonathan Cheung

USP London

07706 357863

jonathan@usp.london

Subject to contract. USP for themselves and the vendor of this property give notice that these particulars do not form, or form part of, any offer or contract. They are intended to give fair description of the property and whilst every effort has been made to ensure their accuracy this cannot be guaranteed. Any intending purchaser must therefore satisfy themselves by inspection or otherwise. Neither USP, nor any of its employees, has any authority to make or give any further representations or warranty whatsoever in relation to this property. All prices and rents quoted are net of vat.