







## GOLF LINKS ROAD

SK Property Group are delighted to be exclusively appointed on this impressive family residence, nestled in a picturesque setting. This captivating home offers stunning views across the Ferndown championship golf course, situated on the outskirts of the small town of Ferndown, Dorset, offering an abundance of coffee shops, delicatessens, local eateries and major supermarkets.

Drawing room • Reception Hall • Dining room • Kitchen/family room • Utility room • Downstairs cloakroom • Family shower room

---

Principal suite with en-suite bathroom & balcony extending to bedroom two • Three further double bedrooms

---

Double garage • Front and rear gardens

**Scenic vistas overlooking the renowned Ferndown Golf Course.**



Quintessentially British  
and meticulously  
appointed throughout.





## Reception

Upon arrival you are greeted by a welcoming reception hall adorned with generous height ceilings, an elegant staircase and intricately crafted doors.

The ground floor unveils a formal drawing room bathed in natural light from dual aspects, where an enchanting, automated gas fireplace radiates warmth amidst a captivating ambiance.

Complemented by the outlook across the rear garden extending to the 18th fairway, these unparalleled vistas grace every corner of this abode.

The dining hall beckons forth with its expanse, a symphony of indoor and outdoor harmony, as French doors open to the terrace and the verdant garden, creating a sanctuary for al fresco banquets under the celestial canopy.

An enchanting family home,  
nestled on the edge of a  
championship golf course.



"Having moved here  
from abroad, the house in  
its excellent location,  
gave us years of superb  
living conditions."

Vendor







A sumptuously lit  
meandering staircase  
beckons you to wander  
through this stunning home.







## **Kitchen & day room**

The kitchen reveals an expanse of units and appliances enclosed within, furnished with marble work surfaces.

An adjacent day room unfolds as a harmonious space for unified living, tailored for work, relaxation, or nurturing a young family.

Comfortable seating arrangements beckon for moments of relaxation or engaging conversations.

The room is thoughtfully decorated with a blend of modern and cosy elements, creating an ambiance that is both invigorating and calming.

As the sun sets, the room transforms with the soft glow of ambient lighting, casting a warm and welcoming aura. It is a space that adapts effortlessly to the changing rhythms of daily life, embracing the essence of togetherness and comfort in every corner.









## First floor

Ascending the stairway, a radiance unfolds before you. Here, a grand landing is a gateway to a resplendent principal suite, where luxury and expanse intertwine. From a plush seating area to the substantial balcony, every element emanates a sense of grandeur and comfort.

This is a space where one can truly unwind and indulge in the beauty of the moment, surrounded by a blend of opulence and serenity.









## **En-suite bathroom**

The current vendor's cherished principal en-suite bathroom designed with relaxation and elegance as top priorities.

Every aspect has been meticulously selected to craft a space that exudes comfort, from the beautiful panelling to the lavish fixtures, this room invites you to unwind in a tranquil atmosphere.

The vendor's considerate touch is apparent in every detail, turning this bathroom into a genuine haven in the household.







## Accommodation

Three additional double bedrooms offer expansive living for families and guests alike, accompanied by tasteful decor and windows that provide a view over the rear garden and golf course, allowing a gentle caress of natural light that weaves a snug embrace.







## Outside

An immersive picturesque surrounding, whether seeking solace in the tranquillity of nature or entertaining guests, this outdoor oasis offers the perfect setting for both, with beautifully manicured gardens and a vast terrace.

The gardens feature an array of mature trees, shrubs and plants that enhance every corner.





## Location

Located in an exceptionally desirable location, essentially in the centroid of Dorset, Hampshire and Wiltshire, Golf Links Road provides access to key lifestyle elements that enhance every facet of south coast living.

- Bournemouth airport located just a mere 10 minutes drive, offers international destinations with convenience from a local airport.
- Bournemouth train station, accessible within 10 miles, facilitates direct links to London Waterloo in approximately 1.45 hours and further afield.
- The New Forest National Park, an ancient tapestry of woodlands, grazed by cattle and New Forest ponies, can be accessed within a 15 minute drive.
- Coastal towns and beaches include the award winning blue flag beaches of Sandbanks and Bournemouth, with coastal areas such as Lymington, Weymouth, Swanage, Christchurch and the Jurassic coastline including the famous Durdle Door and Lulworth Cove, all within easy access.
- Market towns nearby include Ringwood, Wimborne, Blandford, Dorchester, Wareham and Salisbury.
- Ferndown Golf Course is a championship course, offering a 27-hole heathland course draped in history.
- Renowned schools nearby include Canford, Talbot Heath, Dumpton, Bryanston and Moyles Court.
- Road links include the A31 to access further south and west regions, and the M27 enables access to London, the North and the East.



## Ground Floor

Approx. 160.7 sq. metres (1729.5 sq. feet)

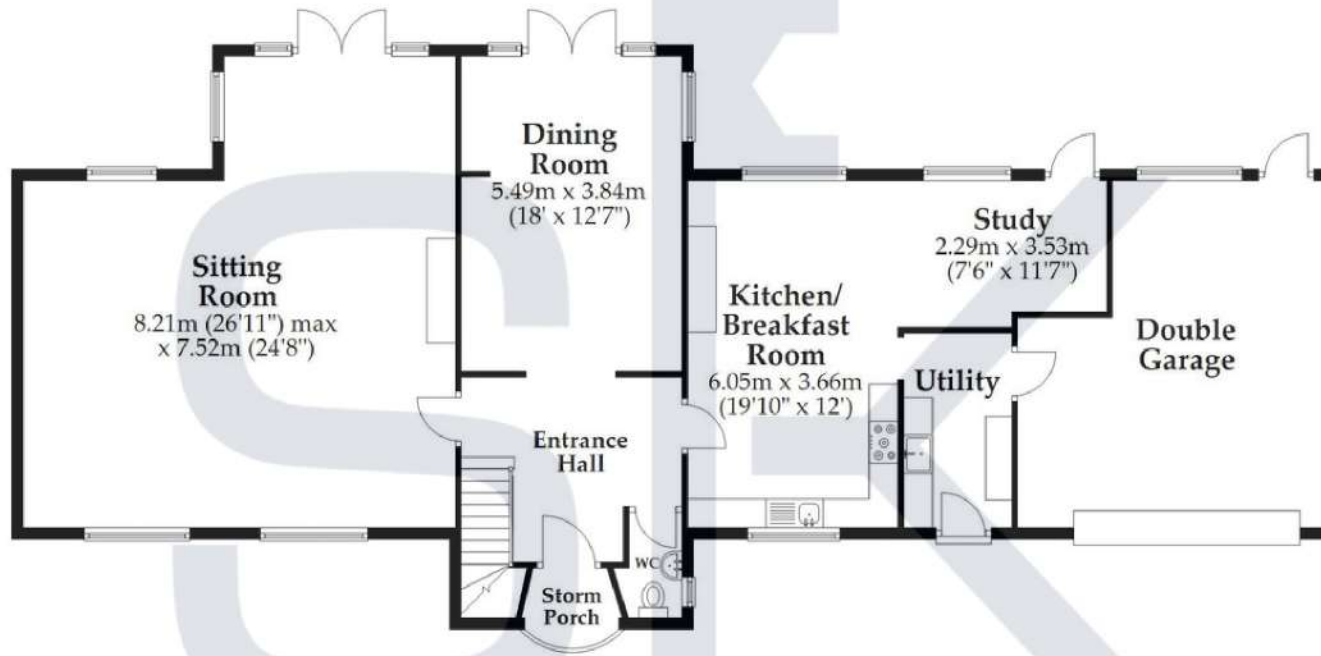

## First Floor

Approx. 125.3 sq. metres (1348.9 sq. feet)

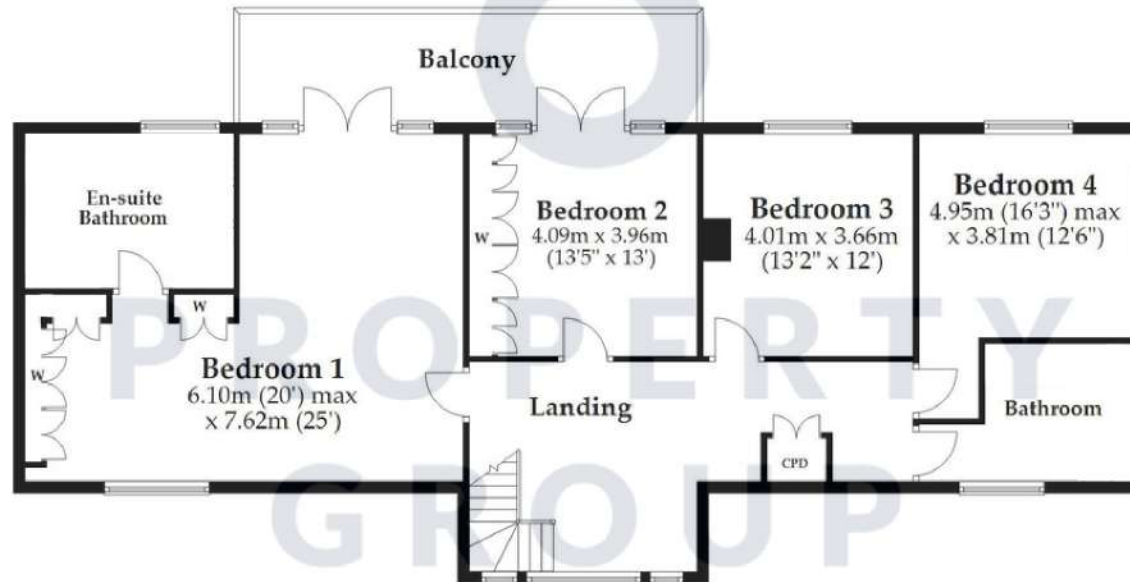

Total area: approx. 286.0 sq. metres (3078.4 sq. feet)

This plan is not to scale and is for general guidance only.

## Agents Comments

Golf Links Road is a real honour for me as an agent, not least the fact this remarkable and inspiring home has been loved by the family for many years, watching their grandchildren grow up and offering a calming retreat, I can really feel the wonderful memories this home offers - every time you return you feel a great sense of joy, and when I speak with the owners they are so truly passionate and proud of their home. I'm sure the next owners will enjoy this gem just as much.

***"Your home should tell a story of who you are,  
and be a collection of what you love"***

Nate Berkus

*Douglas*



Douglas Stirling-Kibble  
douglas@skpg.co.uk  
+44 (0)7946 815251  
www.skpg.co.uk