



5 Duke Street , Hartlepool, TS26 8QF

£85,000



****INVESTORS ONLY - SOLD WITH SITTING TENANT****

Welcome to Duke Street, Hartlepool - a charming location for this delightful end terrace house built in 2009. This pleasant property boasts roughly 710 sq ft of space.

One of the highlights of this property is its delightful rear garden, offering a tranquil space to relax and unwind. Additionally, the convenience of a driveway to the rear ensures easy access and parking for residents and guests alike.

Ideally located, this house provides the perfect balance of peaceful living while being within reach of local amenities and transport links. Whether you're looking to start or expand your property portfolio, this end terrace house on Duke Street is a fantastic opportunity not to be missed.



Area Map

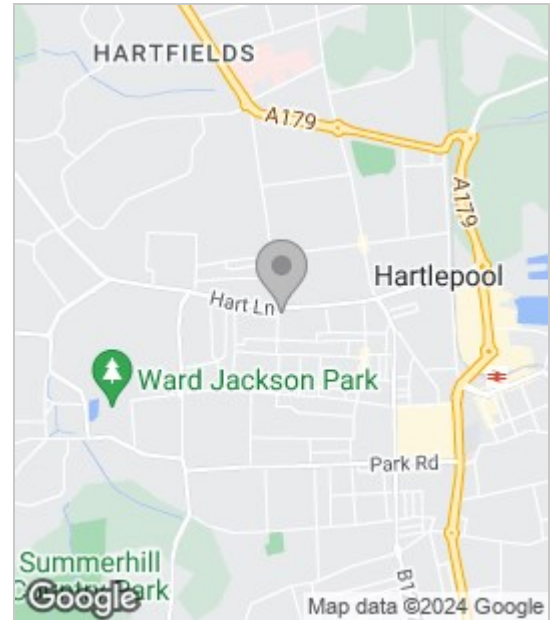

Floor Plan

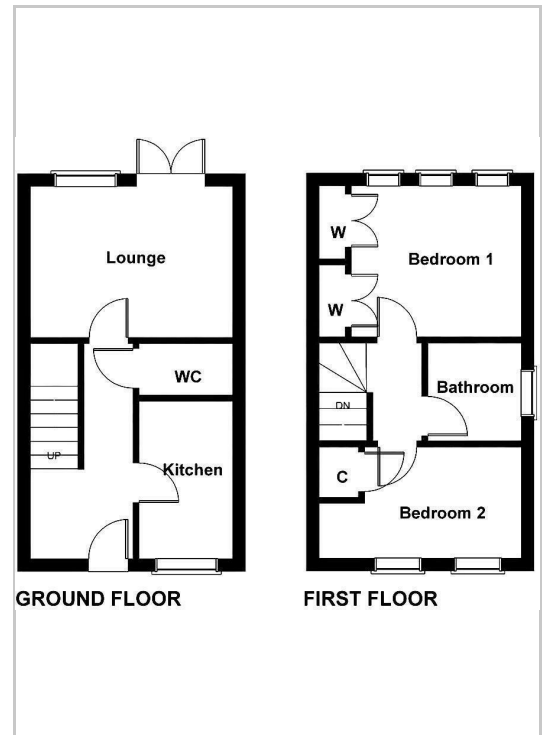

Energy Efficiency Graph

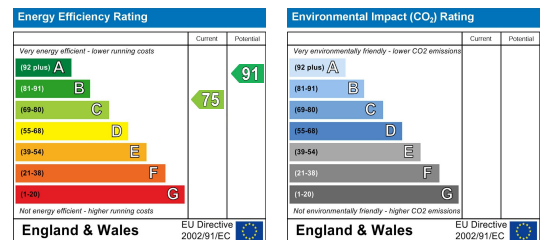

These particulars, whilst believed to be accurate are set out as a general outline only for guidance and do not constitute any part of an offer or contract. Intending purchasers should not rely on them as statements of representation of fact, but must satisfy themselves by inspection or otherwise as to their accuracy. No person in this firm's employment has the authority to make or give any representation or warranty in respect of the property.