



## Highfield House Sycamore Terrace

Haswell, Durham, DH6 2AG

**£664,950**



\*\*\* TAKE A LOOK AT THIS \*\*\*

We are delighted to offer to the market this jaw dropping residence which has been lovingly renovated recently to the highest of standards and is now a great family home and more. Highfield House, situated in a rural part of County Durham, on the outskirts of Haswell, great for commuting via the A19 or to Durham City. Primary schools and secondary schools close by.

The property comprises of the Main building, which has been renovated to the highest of standards. 5 spacious bedrooms, the master having ensuite and a larger than average family bathroom. A stunning kitchen, leading to a large dining area with 2 original fireplaces. Family living room with log burner, leading to a snug with feature fireplace. Conservatory leading to a large garden with decking area. Oil central heating.

Bungalow 1 is to the left of the main building and comes with planning permission to separate from main house to create a semi detached dwelling.



## Area Map

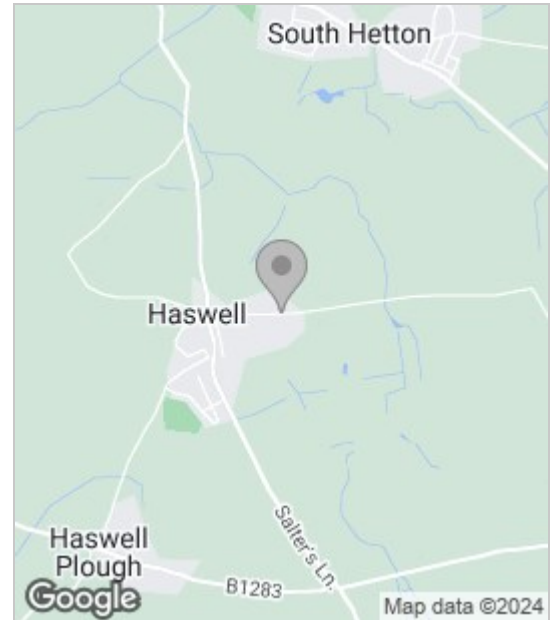

## Floor Plan

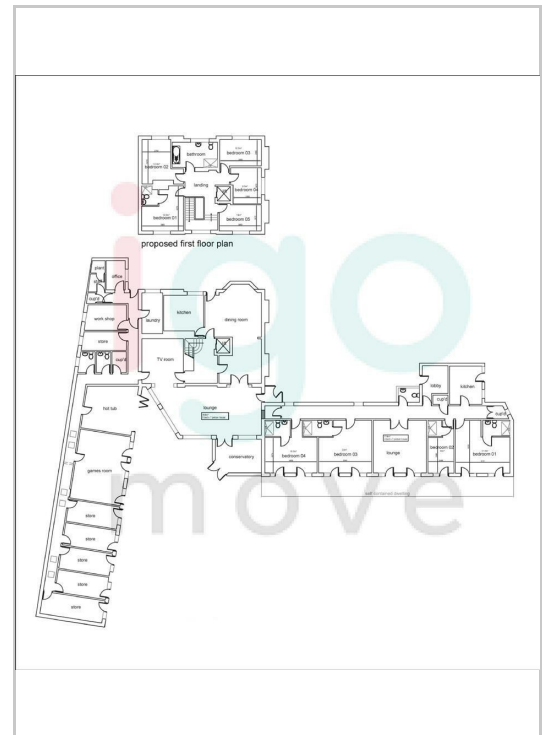

## Energy Efficiency Graph

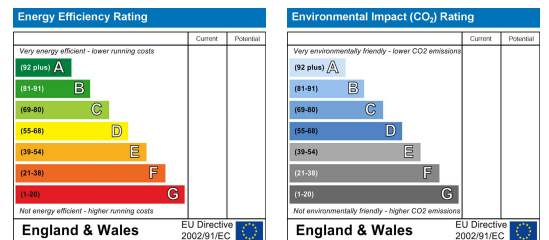

These particulars, whilst believed to be accurate are set out as a general outline only for guidance and do not constitute any part of an offer or contract. Intending purchasers should not rely on them as statements of representation of fact, but must satisfy themselves by inspection or otherwise as to their accuracy. No person in this firm's employment has the authority to make or give any representation or warranty in respect of the property.