



Land Front Street

Station Town, Wingate, TS28 5ER

£270,000



*** LAND FOR SALE ***

Occupying a large corner plot with multiple development options. Having plans drawn for up-to 10 houses or a large apartment block. Formerly the 'Corner House' pub in Station Town, Wingate ideal for commuting via the A19 or to Hartlepool.

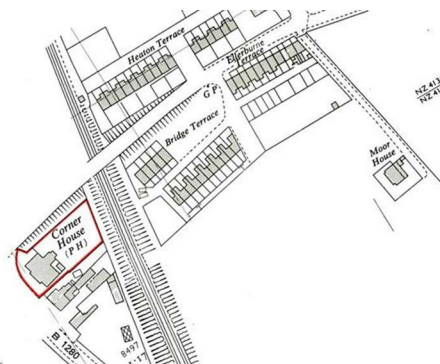

Area Map

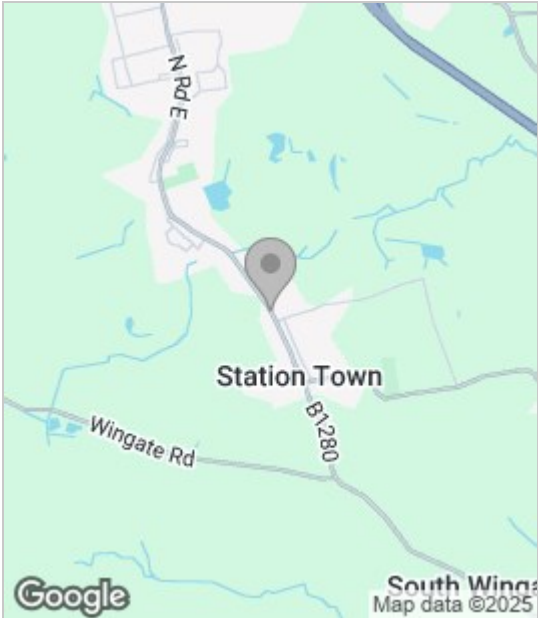

Floor Plan



Energy Efficiency Graph



These particulars, whilst believed to be accurate are set out as a general outline only for guidance and do not constitute any part of an offer or contract. Intending purchasers should not rely on them as statements of representation of fact, but must satisfy themselves by inspection or otherwise as to their accuracy. No person in this firms employment has the authority to make or give any representation or warranty in respect of the property.