

DURDEN & HUNT

INTERNATIONAL



Eton Heights, Woodford Green IG8

Offers Over £750,000

- Three Bedroom Apartment
- Private Balcony
- Communal Greenery
- Second Floor
- Secure Gated Parking
- Excellent Transport Links
- Modern Open Plan Kitchen, Living And Dining Area
- Communal Gyn And Pool

309 High Road, Loughton, Essex, IG10 1AL
0203 026 0160

loughton@durdenandhunt.co.uk
<https://www.durdenandhunt.co.uk/>

Eton Heights
 Approx. Gross Internal Area 1318 Sq Ft - 122.49 Sq M

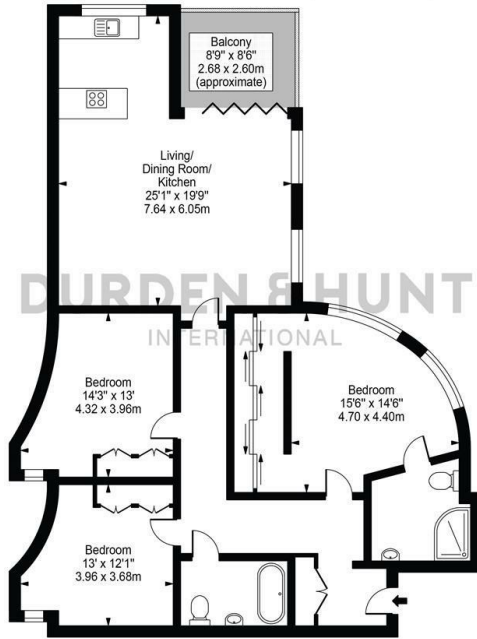

Second Floor
 For Illustration Purposes Only - Not To Scale

This floor plan should be used as a general outline for guidance only and does not constitute in whole or in part an offer or contract. Any intending purchaser or lessee should satisfy themselves by inspection, searches, enquiries and full survey as to the correctness of each statement. Any areas, measurements or distances quoted are approximate and should not be used to value a property or be the basis of any sale or let.

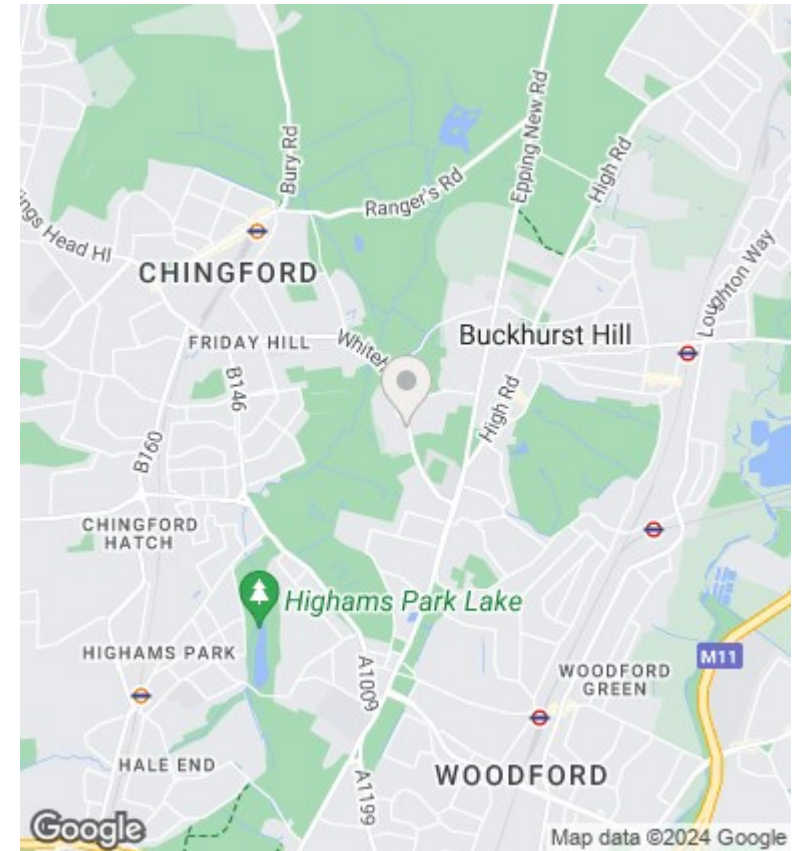

Viewings

Viewings by arrangement only. Call 0203 026 0160 to make an appointment.

Council Tax Band

G

EPC Rating:

B

Energy Efficiency Rating		Current	Potential
<i>Very energy efficient - lower running costs</i>			
(92 plus)	A		
(81-91)	B	81	83
(69-80)	C		
(55-68)	D		
(39-54)	E		
(21-38)	F		
(1-20)	G		
<i>Not energy efficient - higher running costs</i>			
England & Wales		EU Directive 2002/91/EC	