

# DURDEN & HUNT

INTERNATIONAL



## Tysea Hill, Romford RM4

Asking Price £800,000

- Countryside Location
- Landscaped Front And Back Garden
- Separate Dining Room
- Family Bathroom
- Gated Property
- Spacious Lounge
- Home Study
- Double Garage And Driveway
- Kitchen And Breakfast Room
- Two Large Bedrooms

309 High Road, Loughton, Essex, IG10 1AL  
0203 026 0160

[loughton@durdenandhunt.co.uk](mailto:loughton@durdenandhunt.co.uk)  
<https://www.durdenandhunt.co.uk/>

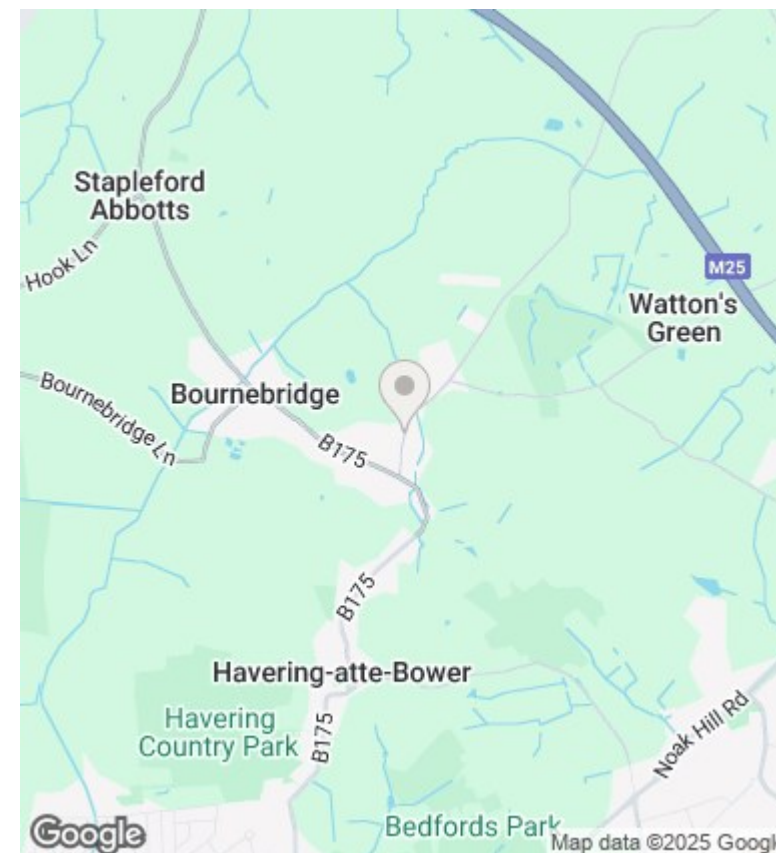
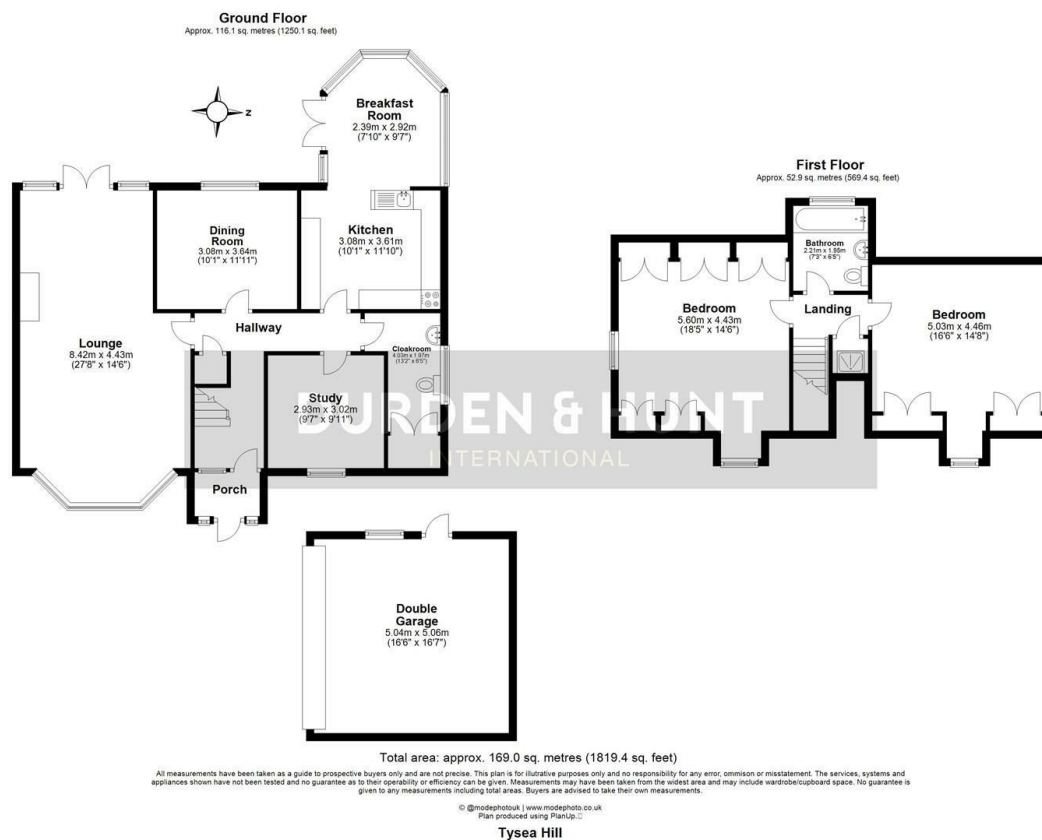

## Viewings

Viewings by arrangement only. Call 0203 026 0160 to make an appointment.

## Council Tax Band

F

## EPC Rating:

D

Energy Efficiency Rating		
	Current	Potential
Very energy efficient - lower running costs		
(92 plus) <b>A</b>		
(81-91) <b>B</b>		76
(69-80) <b>C</b>		
(55-68) <b>D</b>	58	
(39-54) <b>E</b>		
(21-38) <b>F</b>		
(1-20) <b>G</b>		
Not energy efficient - higher running costs		
<b>England &amp; Wales</b>	EU Directive 2002/91/EC	