

Directions

Viewings

Viewings by arrangement only. Call 02085042440 to make an appointment.

EPC Rating

D

Energy Efficiency Rating		Current	Potential
Very energy efficient - lower running costs			
(92 plus) A			79
(81-91) B			
(69-80) C			
(55-68) D		64	
(39-54) E			
(21-38) F			
(1-20) G			
Not energy efficient - higher running costs			
England & Wales		EU Directive 2002/91/EC	

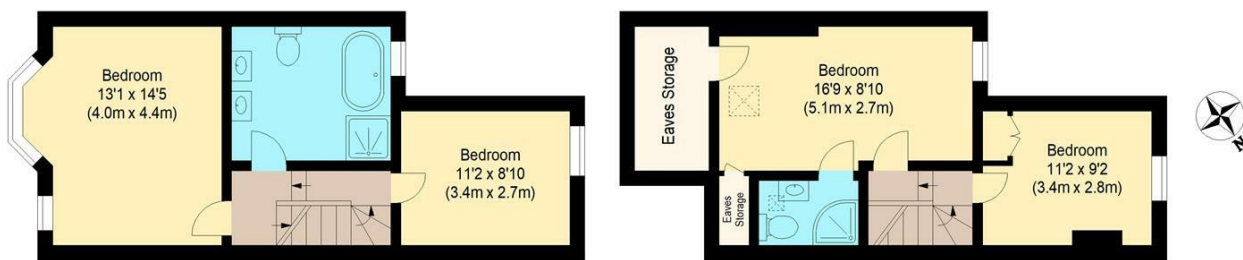

First Floor

Second Floor

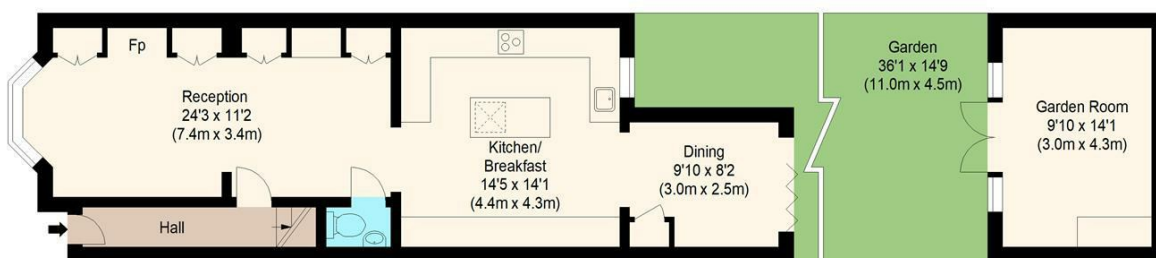

Ground Floor

william rose
West Grove, IG8

Approximate Gross Internal Floor Area : 136.21 sq m / 1466 sq ft
Garden Room : 13.19 sq m / 142 sq ft



Measured according to RICS IPMS2. Floor plan is for illustrative purposes only and is not to scale. Every attempt has been made to ensure the accuracy of the floor plan shown, however all measurements, fixtures, fittings and data shown are an approximate interpretation for illustrative purposes only. 1 sq m = 10.76 sq feet.

lpaplus.com

Date: 24/6/2024



184 West Grove, Woodford Green, IG8 7NW

£3,000 Per Month

- 4 Bedrooms
- Spacious Layout
- Stylish Kitchen
- Great Transport Links
- Close to local shops
- Prime Location
- Bright and Airy
- Low Maintenance Garden
- Modern Throughout
- Available Immediately

184 West Grove, Woodford Green IG8 7NW

Introducing a stunning four-bedroom, two-bathroom mid-terraced house available for rent on West Grove. Just minutes from the station, this immaculate property offers spacious living with modern finishes. Perfect for families or professionals, it combines convenience and comfort in a highly sought-after location.



Council Tax Band: D

Welcome to this charming property located in the sought-after area of West Grove, Woodford Green. This delightful mid-terrace house boasts a generous 1,466 sq ft of living space, perfect for a growing family. Upon entering, you are greeted by a cosy reception room, ideal for relaxing with family or entertaining guests. The property features four bright and airy bedrooms, offering plenty of space for everyone to enjoy their own private sanctuary.

With two bathrooms, mornings will be a breeze in this lovely home, ensuring no one is left waiting in line. The property, built in 1900, exudes character and history, adding to its unique charm. Situated in the heart of Woodford Green, this property offers not just a home, but a lifestyle. Close to local amenities, schools, and transport links, convenience is at your doorstep. Imagine strolling through the picturesque streets or enjoying a picnic in the nearby parks.

Don't miss out on the opportunity to make this house your home. Contact us today to arrange a viewing and take the first step towards creating lasting memories in this wonderful property in West Grove.

