



ORMOND AVENUE, BLACKPOOL FY1

£109,950

A very well presented garden terraced house situated in a popular location close to Gynn Gardens and the Promenade. Internal viewing is highly recommended to appreciate the accommodation on offer which briefly comprises, vestibule, hall, lounge, dining room, modern fitted kitchen, utility room, three bedrooms plus loft room, modern bathroom, upvc double glazing, gas central heating, gardens.



GROUND FLOOR

Vestibule: Upvc double glazed main entrance door.

Hall: Radiator.

Lounge: 15' 5" x 11' 6" (4.71m x 3.50m) Upvc double glazed bay window, coved ceiling, radiator.

Dining Room: 14' 1" x 12' 7" (4.30m x 3.83m) Coved ceiling, radiator, upvc double glazed window.

Kitchen: 8' 11" x 5' 10" (2.73m x 1.78m)

A modern range of fitted wall and base units with complementary work surfaces, built in electric oven and hob with extractor, part tiled walls, tiled floor, radiator, upvc double glazed window.

Utility Room: 8' 9" x 4' 11" (2.67m x 1.49m)

Work surface, tiled floor, wall mounted Worcester boiler, upvc double glazed window and door.



FIRST FLOOR

Landing: Store cupboard.

Bedroom: 13' 7" x 10' 0" (4.15m x 3.06m)

Upvc double glazed window and radiator.

Bedroom: 14' 2" x 9' 11" (4.31m x 3.02m)

Upvc double glazed window and radiator.

Bedroom: 10' 6" x 5' 1" (3.19m x 1.55m)

Upvc double glazed window, radiator.

Bathroom: 5' 9" x 5' 7" (1.75m x 1.70m)

Fully tiled walls and floor, modern suite comprising a panelled bath with a mixer tap shower and screen, pedestal wash hand basin and low flush WC. Radiator, upvc double glazed window.

SECOND FLOOR

Loft Room: 11' 10" x 10' 6" (3.60m x 3.21m)

Plus eaves storage and alcove space. Ceiling window, radiator, door through to the stairs leading down to the first floor.

OUTSIDE

Gardens: Walled front yard with a planted hedge. Concreted rear yard.

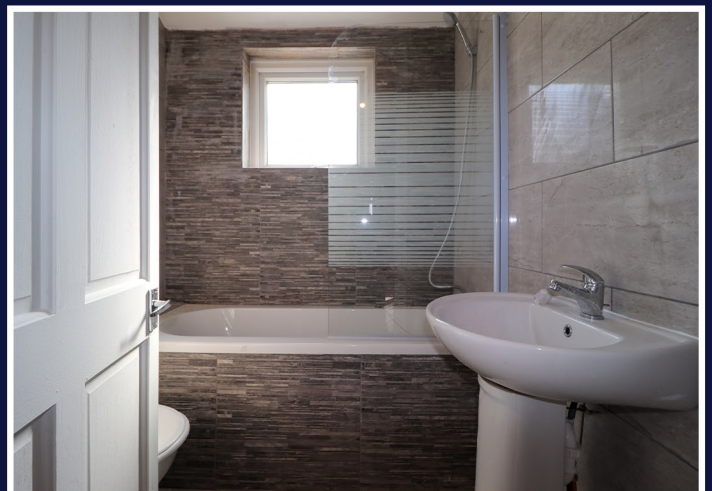

GROUND FLOOR
511 sq.ft. (47.5 sq.m.) approx.

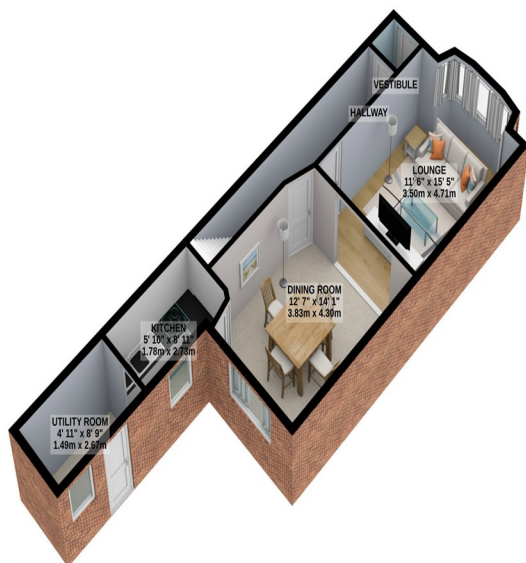

1ST FLOOR
449 sq.ft. (41.7 sq.m.) approx.

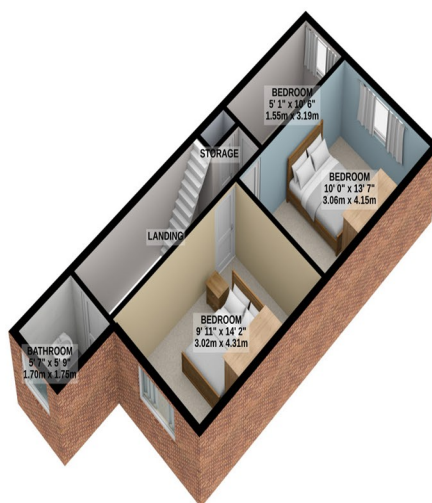

2ND FLOOR
186 sq.ft. (17.3 sq.m.) approx.

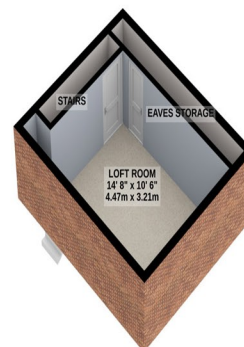

TOTAL FLOOR AREA : 1146 sq.ft. (106.5 sq.m.) approx.

For illustrative purposes only. Decorative finishes, fixtures, fittings and furnishings do not represent the current state of the property. Measurements are approximate. Not to scale.
Made with Metropix © 2021

Score	Energy rating	Current	Potential
92+	A		
81-91	B		
69-80	C		75 C
55-68	D		
39-54	E	48 E	
21-38	F		
1-20	G		



MCKENZIE

THE REAL ESTATE AGENT

78 TOPPING STREET

BLACKPOOL FY1 3AD

01253 499007

MCKENZIEESTATES.CO.UK

INFO@MCKENZIEESTATES.CO.UK

Under the Property Misdescription Act 1991 we endeavour to make our sales details accurate and reliable but they should not be relied upon as statements or representations of fact and they do not constitute any part of an offer of contract. The seller does not make any representations to give any warranty in relation to the property and we have no authority to do so on behalf of the seller. Services, fittings and equipment referred to in the sales details have not been tested (unless otherwise stated) and no warranty can be given as to their condition. We strongly recommend that all the information which we provide about the property is verified by yourself or your advisers. Under the Estate Agency Act 1991 you will be required to give us financial information in order to verify your financial position before we can recommend any offer to the vendor. MCKENZIE - The Real Estate Agent is a trading name of McKenzie Estate Agents Ltd. Company Reg No: 10143396