



 **3**
Bedrooms

 **1**
Bathroom



Offered with no further chain and needing updating throughout is this three-bedroom terraced family home. Internally to the ground floor you will find a large storage cupboard, spacious through lounge with a separate door leading to the kitchen/diner and sliding doors leading to the garden. To the first floor you would find all three bedrooms and a family bathroom. Externally to the front you would benefit from a low maintenance small front garden and on street permit parking.

Wellington Road, HA3 5SD

Approx Gross Internal Area = 84 sq m / 904 sq ft

Front Garden = 11 sq m / 118 sq ft

Garden = 93 sq m / 1001 sq ft

Shed = 4 sq m / 43 sq ft

Total = 192 sq m / 2067 sq ft

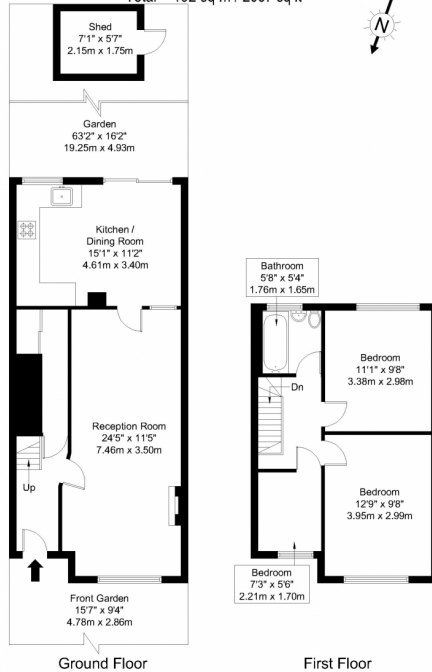

Ref:

First Floor

Copyright **BLEU PLAN**

The Floor plan is not to scale and measurements and areas shown are approximate and therefore should be used for illustrative purposes only. The plan has been prepared in accordance with the RICS code of Measuring Practice and whilst we have confidence in the information produced it must not be relied on. Maximum lengths and widths are represented on the floor plan. If there is any aspect of particular importance, you should carry out or commission your own inspection of the property.

Copyright @ BLEUPLAN





Restaurant Miorița



St Joseph's
Catholic Church



Belmont School



Sri Lankan Muslim
Cultural Centre



The Gym Group
London Wealdstone



Harrow Leisure Centre



Screwfix Harrow



Harrow & Wealdstone

