



 1
Bedroom

 1
Bathroom



Offered with no further chain and in good condition throughout is this One Double Bedroom Maisonette. Internally you will find a large lounge, double bedroom, modern Kitchen, and family bathroom. Whilst externally the property is ideally placed to give you easy access to local shops and transport links. All in all, this would make an ideal first time or investment purchase.

Offered with no further chain and in good condition throughout is this One Double Bedroom Maisonette. Internally you will find a large lounge, double bedroom, modern Kitchen, and family bathroom. Whilst externally the property is ideally placed to give you easy access to local shops and transport links. All in all, this would make an ideal first time or investment purchase.

GROUND FLOOR
40 sq.ft. (3.8 sq.m.) approx.



1ST FLOOR
427 sq.ft. (39.7 sq.m.) approx.

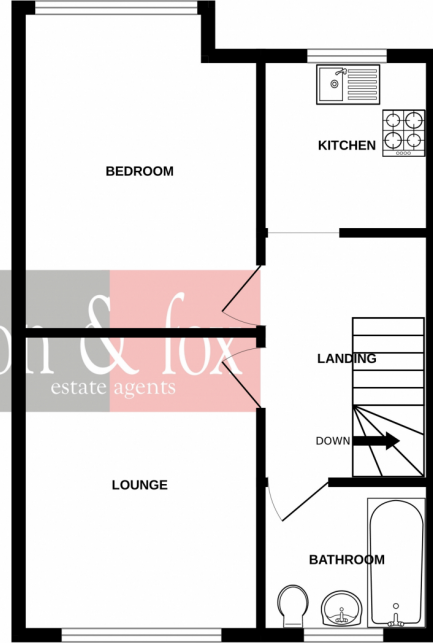

TOTAL FLOOR AREA : 467 sq.ft. (43.4 sq.m.) approx.

Whilst every attempt has been made to ensure the accuracy of the floorplan contained here, measurements of doors, windows, rooms and any other items are approximate and no responsibility is taken for any error, omission or mis-statement. This plan is for illustrative purposes only and should be used as such by any prospective purchaser. The services, systems and appliances shown have not been tested and no guarantee as to their operability or efficiency can be given.
Made with Metropix ©2022



EPC

Coming soon





Teenywear

The Duck In The Pond

Restaurant Miorița

The Cardamom Club

The Massage Company - Harrow

St Joseph's Catholic Church

Belmont School

Simply Dents

Sri Lankan Muslim Cultural Centre

Halfords Autocentre Harrow

The Gym Group London Wealdstone

Wealdstone Cemetery

Byron Park

Harrow School of Gymnastics