



Pear tree Lane, Welwyn Garden City

Guide price £200,000

BELVOIR!



Discover an excellent opportunity with this chain-free one-bedroom flat in Regent Court, Welwyn Garden City. Offering a spacious double bedroom and a well-proportioned living space, this property is in fair condition, ready for you to move in or add value. Ideally located within walking distance to the town centre and just a 15-minute walk to the mainline station, it provides easy access to London and beyond. With residents' parking and visitor parking, convenience is key. Whether you're a first-time buyer or an investor, this is a fantastic chance to secure a property in a prime location. Don't miss out—book your viewing today!

Agent's Notes

Belvoir are advised;
 Years remaining on the lease -
 Ground rent -
 Service charge -
 Council tax - Welwyn Hatfield band B



First Floor

Approx. 44.2 sq. metres (476.0 sq. feet)

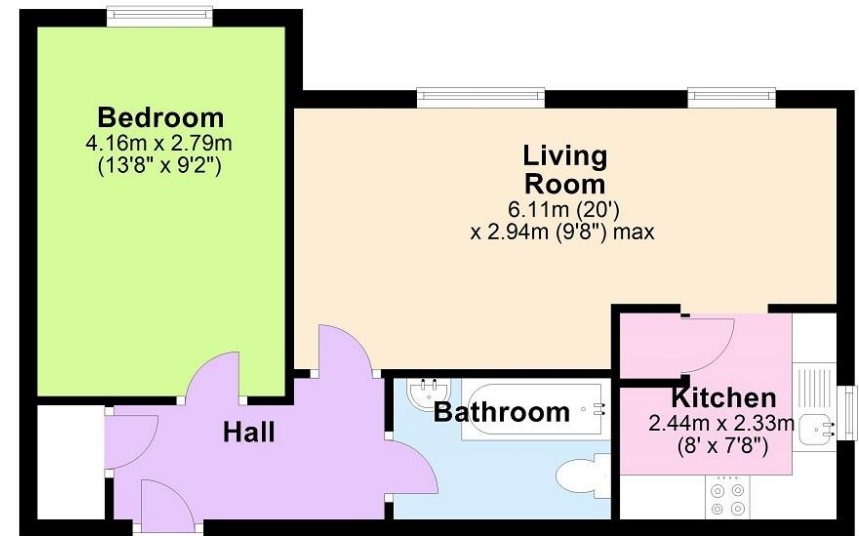

Total area: approx. 44.2 sq. metres (476.0 sq. feet)