



Rose Glen, Romford, RM7 0SL

- Three Bedrooms
 - Loft Room
- Two Reception Rooms
- 1.3 Miles To Romford Station
 - 70ft Garden
 - Driveway
- Outbuilding With Power

£450,000 - Freehold - Council Tax: D

Rose Glen

Romford, RM7 0SL



Entrance Hall

15'9 x 7'5 (4.80m x 2.26m)

Entrance door, radiator, carpet.

Reception Room One

14'5 x 12'00 (4.39m x 3.66m)

Double glazed bay window to front, electric fireplace, radiator, carpet.

Reception Room Two

12'9 x 10'1 (3.89m x 3.07m)

Double glazed French doors to rear, radiator, carpet.

Kitchen

10'1 x 7'5 (3.07m x 2.26m)

Spotlights, wall and base units, single drainer sink, double glazed window to rear, door to rear garden, laminate flooring.

Landing

9'6 x 7'7 (2.90m x 2.31m)

Carpet, stairs to ground floor.

Bedroom One

13'00 x 9'6 (3.96m x 2.90m)

Double glazed bay window to front, built in wardrobe, radiator, carpet.

Bedroom Two

12'9 x 9'11 (3.89m x 3.02m)

Double glazed window to rear, radiator, carpet.

Bedroom Three

8'2 x 6'7 (2.49m x 2.01m)

Double glazed window to front, radiator, carpet, access to loft room.

Bathroom

8'00 x 7'7 (2.44m x 2.31m)

Spotlights, double glazed window to rear, shower cubicle, panelled bath, heated towel rail, low level WC, vanity wash hand basin, tiled walls, laminate flooring.

Loft Room

14'00 x 13'7 (4.27m x 4.14m)

Velux windows, eaves storage, radiator, carpet.

Garden

70' (21.34m)

Part paved and part laid to lawn. shed, side pedestrian access, outbuilding with electric.

Driveway

Paved driveway for two vehicles.

Section 21

Under section 21 of the Estate Agents Act 1979 We are required to advise that the owner of this property is connected to or is employed by Noble Residential Limited.

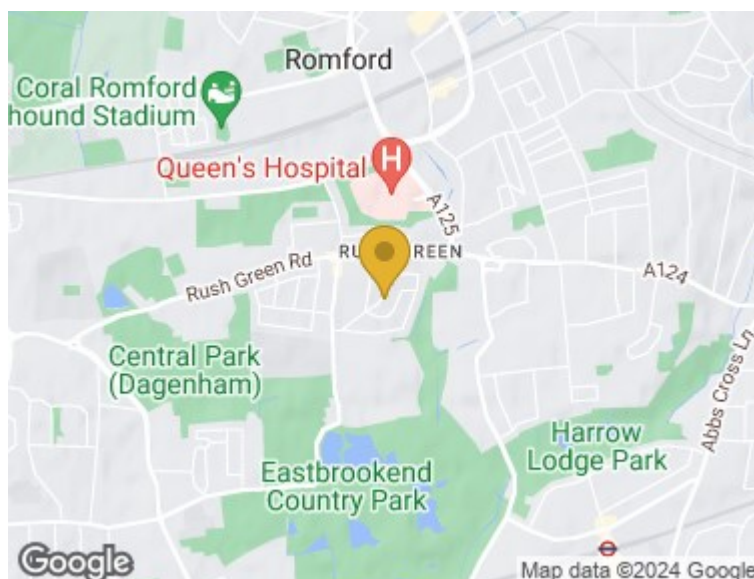



GROUND FLOOR
455 sq.ft. (42.2 sq.m.) approx.

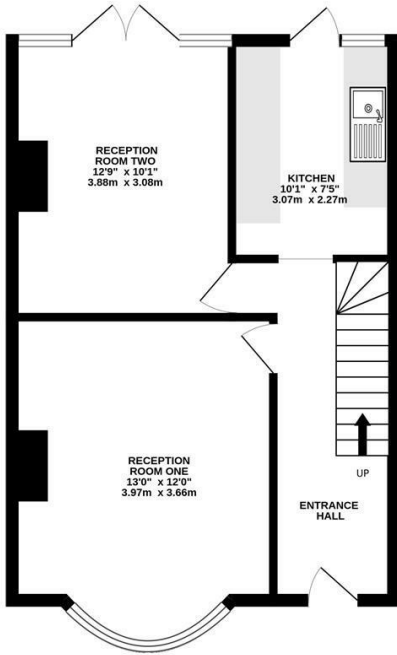

1ST FLOOR
458 sq.ft. (42.5 sq.m.) approx.

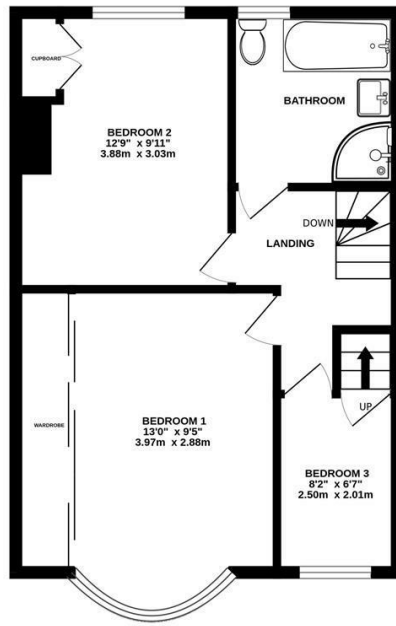

LOFT ROOM
191 sq.ft. (17.8 sq.m.) approx.

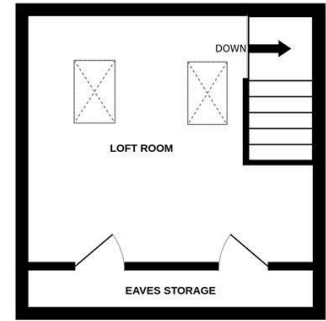

TOTAL FLOOR AREA : 1104 sq.ft. (102.6 sq.m.) approx.

Whilst every attempt has been made to ensure the accuracy of the floorplan contained here, measurements of doors, windows, rooms and any other items are approximate and no responsibility is taken for any error, omission or mis-statement. This plan is for illustrative purposes only and should be used as such by any prospective purchaser. The services, systems and appliances shown have not been tested and no guarantee as to their operability or efficiency can be given.
Made with Metropix ©2024

These particulars, whilst believed to be accurate are set out as a general outline only for guidance and do not constitute any part of an offer or contract. Intending purchasers should not rely on them as statements of representation of fact, but must satisfy themselves by inspection or otherwise as to their accuracy. No person in this firm's employment has the authority to make or give any representation or warranty in respect of the property.

Material Information:
Council Tax Band: D
Tenure: Freehold

