

Croft Gardens, W7

£695,000

This well-located property offers scope for improvement, with three bedrooms, two reception rooms and a kitchen leading out to a garden. With the added potential to further extend into the loft and to the rear (STPP).

Close to both Oaklands and Fielding Primary School, located in-between Northfields Avenue and Boston Road, this location is ideal for transport and local amenities.

Features

- Chain Free
- Two Reception Rooms
- Three Bedrooms
- Good Size Garden
- Scope For Improvement
- Extension Potential (STPP)

Croft Gardens, London, W7

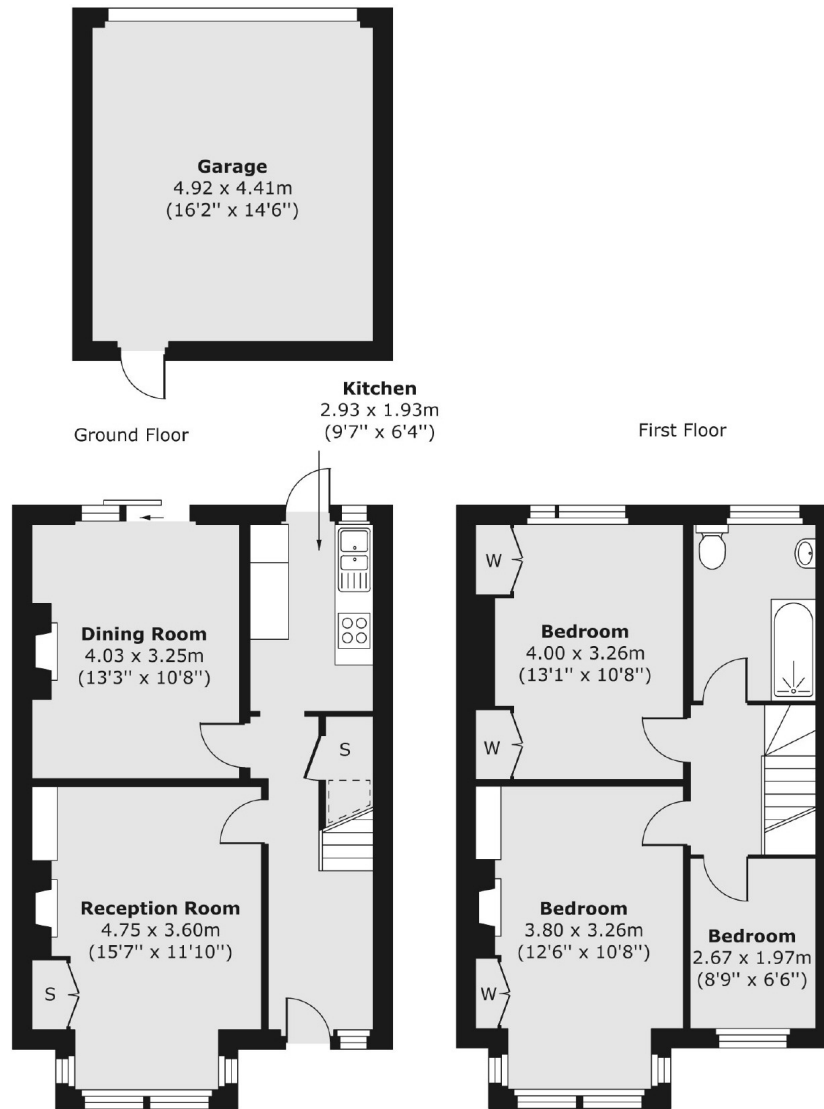

Total area (approx.) 88.96 sq. m (958 sq. ft)
Garage area (approx.) 21.69 sq. m (233 sq. ft)

Contact

To arrange a viewing call our office on the number below or visit our website.



Energy Rating: D. We aim to make our particulars both accurate and reliable. However they are not guaranteed; nor do they form part of an offer or contract. If you require clarification on any points then please contact us, especially if you're traveling some distance to view. Please note that appliances and heating systems have not been tested and therefore no warranties can be given as to their good working order.