



St. Andrews Road, W7

£650,000

Character two bedroom Victorian cottage located in this private cul-de-sac in Olde Hanwell.

Recently refurbished to provide a new kitchen and bathroom with a high standard of fixtures and decoration.

Benefits from a sunny South facing garden and is ideal for a purchaser looking for a home to move straight into and enjoy.

Located close to the Elizabeth line and with no onward chain.

Features

- Victorian Cottage
- New Kitchen Appliances
- Rear Access
- South Facing Garden
- Popular Location
- No Onward Chain

St. Andrews Road,
London, W7

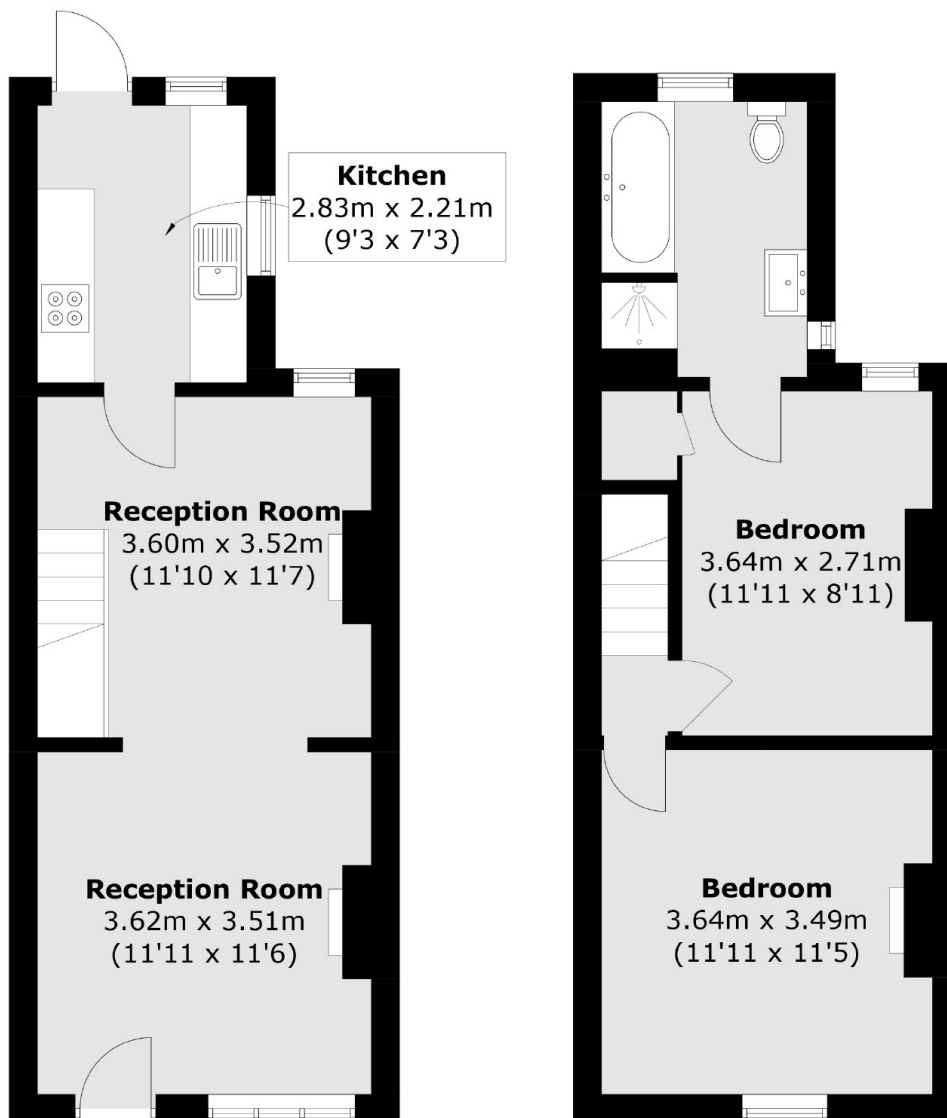

Ground Floor

First Floor

Total area (approx.): 65.6 sq. m (706.1 sq. ft)