



The Broadway, UB6

£542 Per week

Spacious four-bedroom split-level maisonette above shops near Greenford's amenities, with private entrance, fitted kitchen, large reception, three double bedrooms, one single bedroom, and a modern bathroom across upper floors.

The Broadway is situated 1.1 miles from Greenford Station (Central Line) and has easy access to the A40 for commuting into and outside of London. The Broadway also has many bus links to take you around London.

Features

- Four Bedrooms
- Private Entrance
- Unfurnished
- Close to Local Amenities
- Split Level
- Separate Kitchen

The Broadway, Greenford, UB6

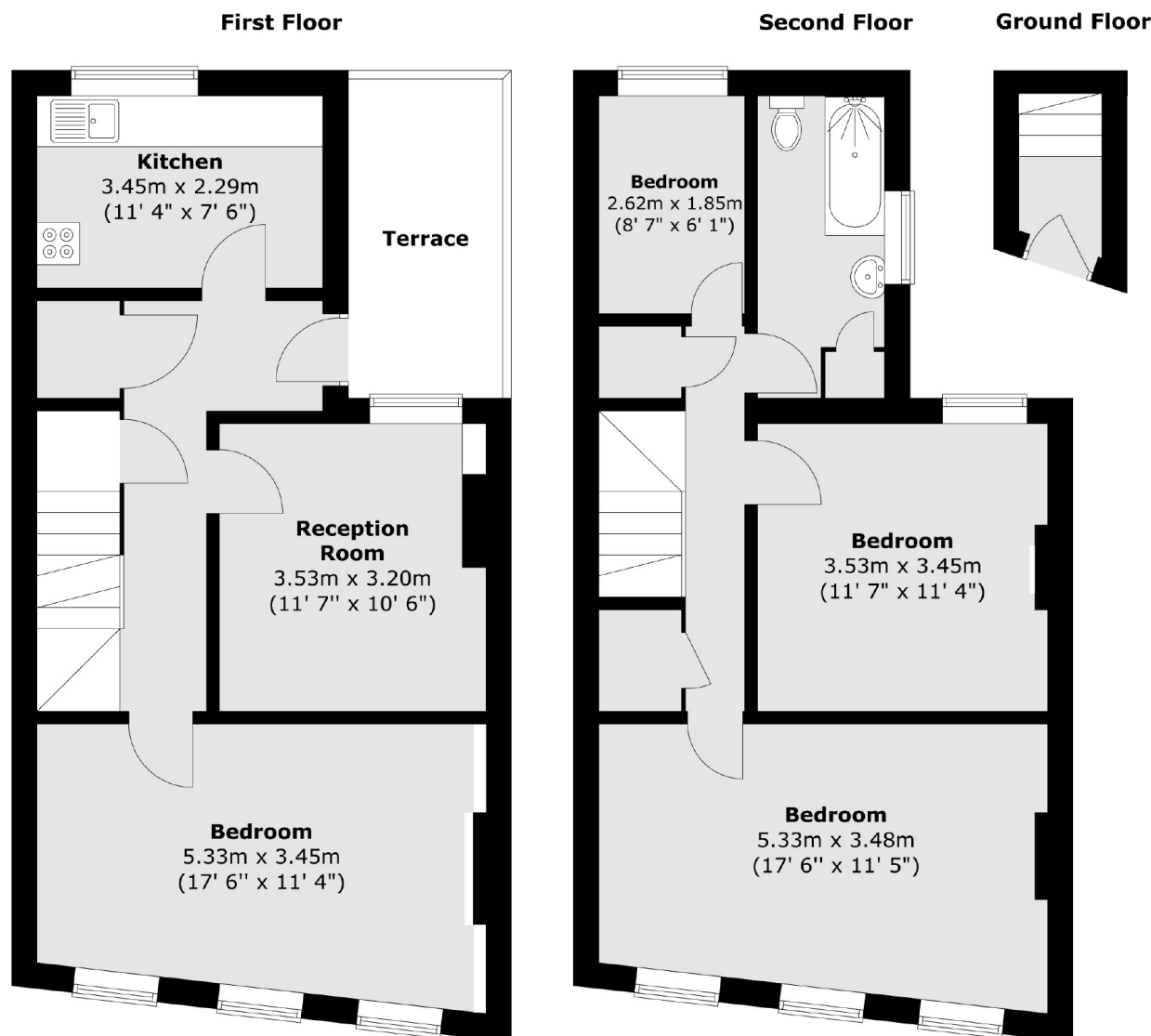

Total area (approx.) : 102 sq. m (1098 sq. ft)
Total terrace area (approx.) : 6.7 sq. m (72 sq. ft)