



## Orchard Gate, UB6

£530 Per week

Spacious three-bedroom end-terrace in quiet Orchard Gate, Greenford. Features large lounge/diner, separate kitchen, two bathrooms, wraparound garden, double glazing, and off-street parking for two. Ideal family home.

Excellent transport links with Sudbury Town (Piccadilly) and Wembley Central (London Overground & Bakerloo) nearby. Horsenden Hill and Nature Reserve offer expansive green spaces just around the corner.

### Features

- Three Bedrooms
- Two Bedroom
- End of Terrace House
- Separate Kitchen
- Rear Garden
- Off Street Parking

# Orchard Gate, Greenford, UB6

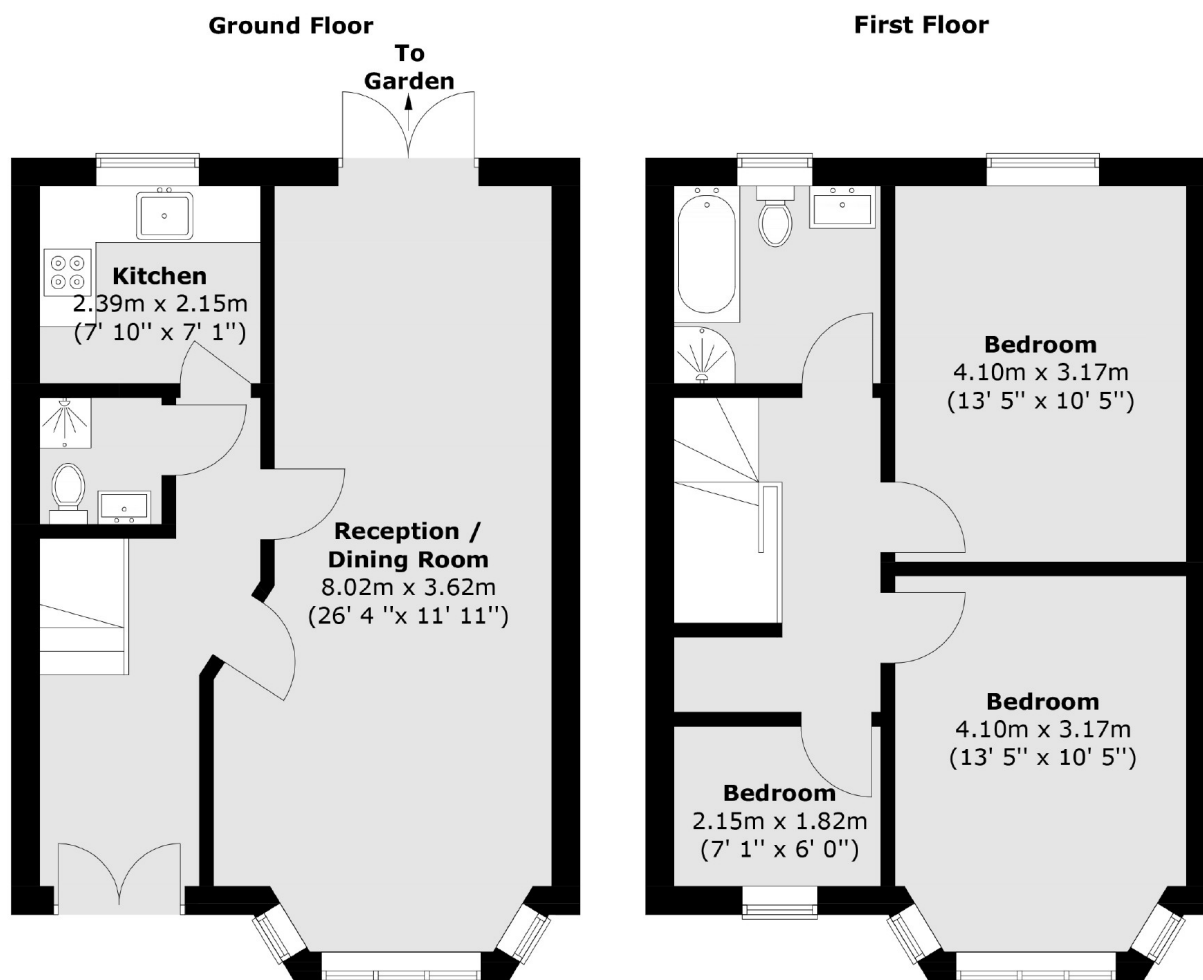

Total area (approx.) 235.1 sq. m (916 sq. ft.)

## Dexters

Northfields  
140 Northfield Avenue  
London  
W13 9SB  
Lettings  
020 8545 8589

Energy Rating: B. We aim to make our particulars both accurate and reliable. However they are not guaranteed; nor do they form part of an offer or contract. If you require clarification on any points then please contact us, especially if you're traveling some distance to view. Please note that appliances and heating systems have not been tested and therefore no warranties can be given as to their good working order.

 **RICS** | Regulated  
Estate Agent  
and Letting Agent

[dexters.co.uk](http://dexters.co.uk)