

Cranmer Avenue, W13

£525,000

A brand new two bedroom ground floor apartment with its own front door perfectly situated in West Ealing . Designed for modern living with two bedrooms, bathroom offering contemporary finishes. The open plan living space room features sleek flooring and high quality fixtures throughout . The modern kitchen is equipped with integrated appliances, stylish kitchen units and stylish work tops. The private balcony offers outdoor space to relax.

Located in a prime West London location this home benefits from excellent transport links with West Ealing offering easy access to Central London via the Elizabeth Line. The area is well known for schools, green spaces and a good selection of cafes, restaurants and shops.

Features

- New Build
- High Specification
- Private Outdoor Space
- Close To Station
- Close To Shops

Cranmer Avenue, London, W13

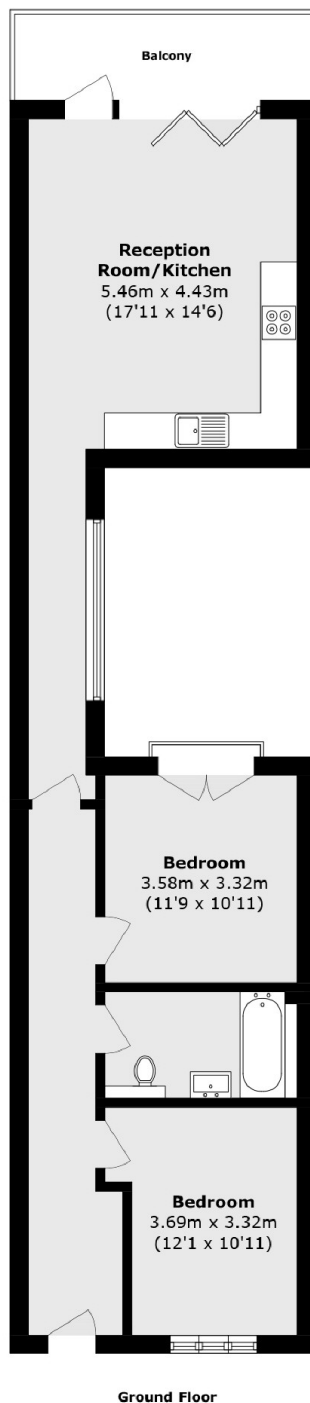

Total area (approx.): 70.2 sq. m (755.6 sq. ft)
Balcony area (approx.): 6.9 sq. m (74.2 sq. ft)

Dexters

Northfields
140 Northfield Avenue
London
W13 9SB
Sales
020 8545 8588

Energy Rating: . We aim to make our particulars both accurate and reliable. However they are not guaranteed; nor do they form part of an offer or contract. If you require clarification on any points then please contact us, especially if you're traveling some distance to view. Please note that appliances and heating systems have not been tested and therefore no warranties can be given as to their good working order.

 **RICS** | Regulated
Estate Agent
and Letting Agent

[dexters.co.uk](https://www.dexters.co.uk)