



Princes Road, W13

£825,000

This excellent Victorian townhouse offers flexible living space across three original floors.

Briefly, comprises two interconnecting reception rooms, kitchen, four good sized bedrooms and bathroom with South facing garden.

Set in a quiet cul-de-sac just moments from Walpole Park within easy reach of transport at West Ealing (Elizabeth line), Northfields (Piccadilly line) and Ealing Broadway (Central, District and Elizabeth lines).

Features

Victorian Townhouse
Three Natural Floors
Well Presented
Close to Transport
Adjacent to Walpole Park
South Facing Garden



Princes Road, W13

As you step into the house, you are greeted by the bright and spacious double reception room with a bay window. Beyond, you find the well fitted kitchen which opens directly to the secluded South facing rear garden.

On the two upper floors, there are four good sized bedrooms and a very nice bathroom.

Located just moments from the open spaces of Walpole Park and convenient to a multiple choice of shopping and public transport facilities at West Ealing (Elizabeth line), Northfields (Piccadilly line) and Ealing Broadway (Central, District and Elizabeth lines).



Princes Road,
London, W13

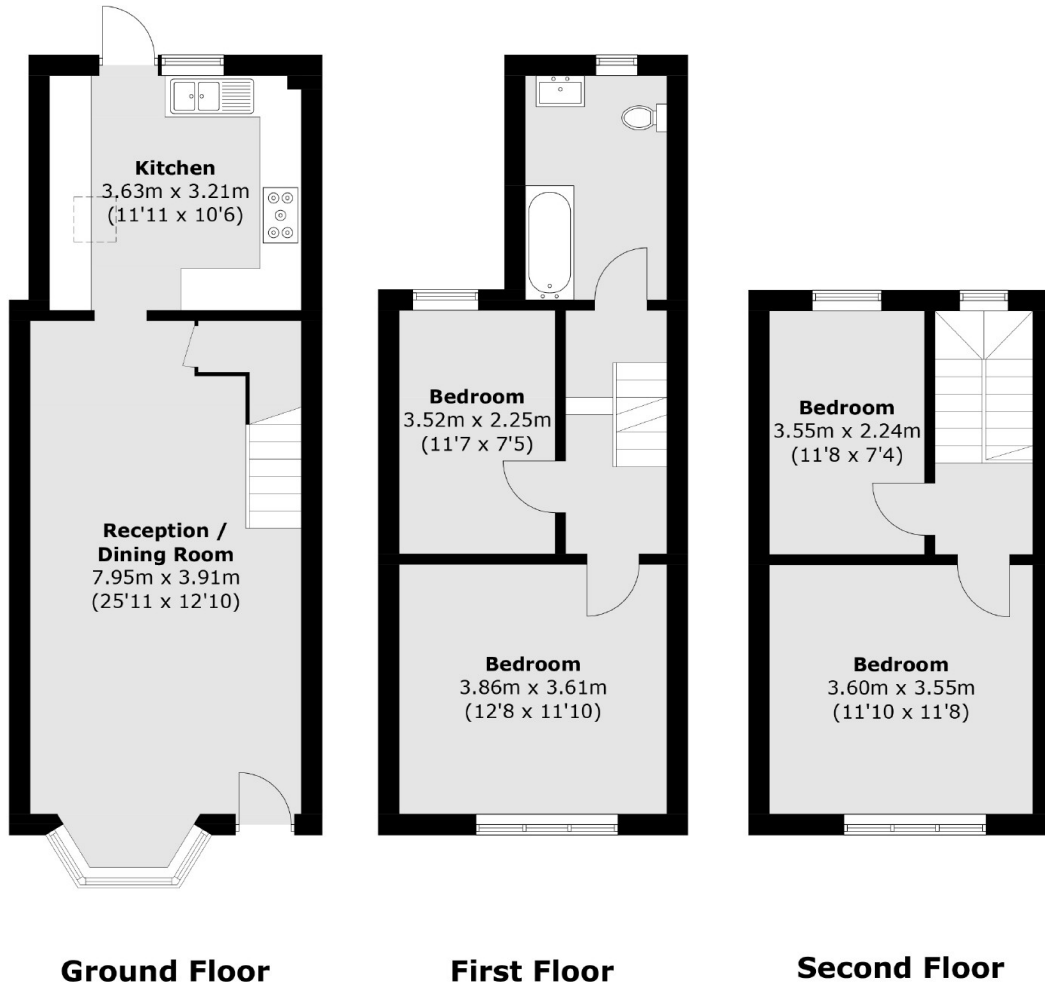

Total area (approx.): 104.8 sq. m (1,128.0 sq. ft)

Dexters

Northfields
140 Northfield Avenue
London
W13 9SB
Sales
020 8545 8588

Energy Rating: D. We aim to make our particulars both accurate and reliable. However they are not guaranteed; nor do they form part of an offer or contract. If you require clarification on any points then please contact us, especially if you're traveling some distance to view. Please note that appliances and heating systems have not been tested and therefore no warranties can be given as to their good working order.

 **RICS** | Regulated
Estate Agent
and Letting Agent

[dexters.co.uk](https://www.dexters.co.uk)