



Hilda Road, UB2

£350,000

Beautifully converted Grade II listed building approximately 7 years old, featuring bright interiors with high ceilings and abundant natural light. This secure, gated property includes parking and communal gardens, along with two bedrooms and modern bathroom and kitchen, making it perfect for first-time buyers or as an investment opportunity.

Chaucer House is within walking distance of the beautiful Grand Union Canal, many parks, shops and cafés. This prime location is under 1 mile from Hanwell Elizabeth Line Station, providing quick access to Central London and Heathrow Airport. Additionally, it's a short drive or bus ride away from the Central Line at Ealing Broadway and the Piccadilly Line at Boston Manor.

Features

- Grade II Listed
- Two Double Bedroom
- Modern Spec Throughout
- Gated Development
- Private Parking
- Chain Free

Hilda Road,
Southall, UB2

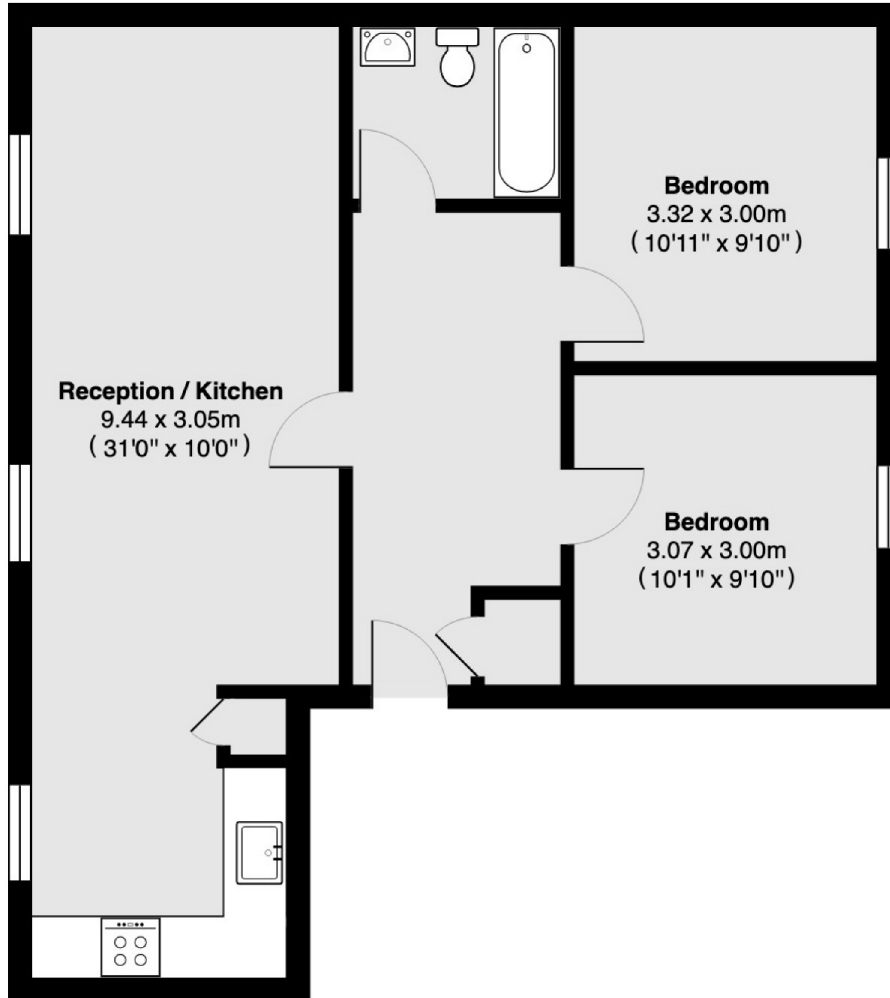

Total area 62.1 sq m (approx) (669 sq ft , approx)

Dexters

Northfields
140 Northfield Avenue
London
W13 9SB
Sales
020 8545 8588

Energy Rating: C. We aim to make our particulars both accurate and reliable. However they are not guaranteed; nor do they form part of an offer or contract. If you require clarification on any points then please contact us, especially if you're traveling some distance to view. Please note that appliances and heating systems have not been tested and therefore no warranties can be given as to their good working order.

 **RICS** | Regulated
Estate Agent
and Letting Agent

dexters.co.uk