



## Carville Crescent, TW8

### £410,000

Well presented two bedroom ground floor flat which benefits from direct access to a circa 70 ft South facing rear garden. Also consists of entrance hall, spacious reception room, well fitted kitchen and bathroom.

Benefits to note include a private section of front garden suitable for off street and close proximity to Lionel Road Primary school ( ofsted outstanding). Offered with an extended long lease.

Set in a quiet location close to both Brentford station and within reach of South Ealing for the Piccadilly line.

### Features

- Ground Floor Flat
- Large Garden
- Well Presented
- Quiet Location
- Two Bedrooms
- Close to Transport

# Carville Crescent, Brentford, TW8

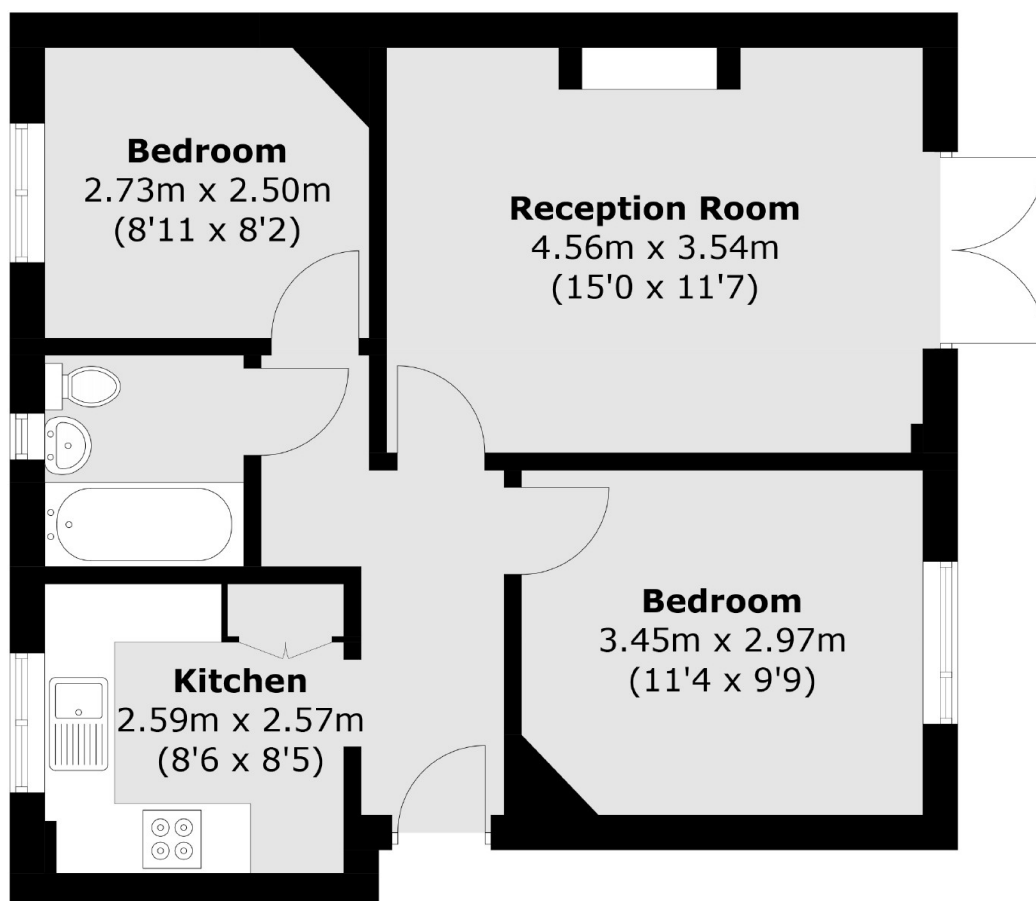

Total area (approx.): 51.6 sq. m (555.4 sq. ft)

## Dexters

Northfields  
140 Northfield Avenue  
London  
W13 9SB  
Sales  
020 8545 8588

Energy Rating: . We aim to make our particulars both accurate and reliable. However they are not guaranteed; nor do they form part of an offer or contract. If you require clarification on any points then please contact us, especially if you're traveling some distance to view. Please note that appliances and heating systems have not been tested and therefore no warranties can be given as to their good working order.

 **RICS** | Regulated  
Estate Agent  
and Letting Agent

[dexters.co.uk](http://dexters.co.uk)