



## Green Avenue, W13

£899,950

Handsome brick fronted house located on this prime Northfields street just moments from Lammas Park and the Piccadilly Line Tube.

With three bedrooms and two receptions, many benefits to note include the impressive well established garden. Well positioned for a choice of fantastic local schools and offered chain free.

### Features

- Three Bedrooms
- Victorian House
- Close to Tube
- Chain Free
- Brick Fronted
- Close to Ofsted Outstanding Schools





## Green Avenue, W13

On arrival, you will be impressed with the front of this brick fronted Victorian house. The entrance hall leads through to the bay windowed front reception and the full width Dining room and the bright kitchen beyond.

On the first floor are two bedrooms and the bathroom with the third bedroom in the converted loft. A home of real warmth and charm with a fabulous garden. Set in this ideal Northfield spot close to Ofsted outstanding schools and the interesting mix of local independent shops and cafes. Offered with no onward chain, viewing is highly recommended.







# Green Avenue, London, W13

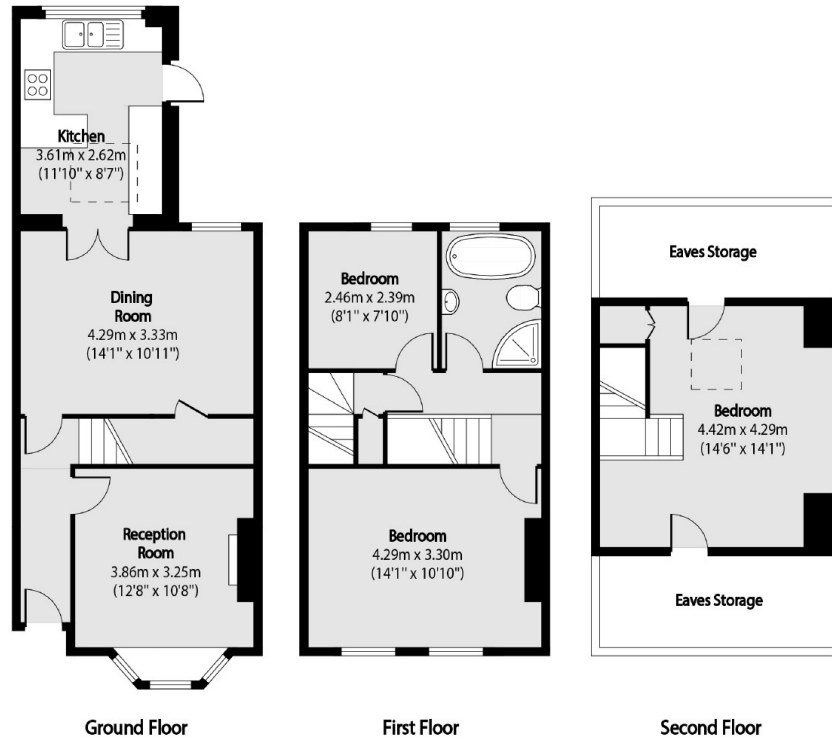

Total area (approx): 93.55 sq m (1007 sq. ft)

(Excluding Eaves Storage)

Eaves Storage total area (approx): 14.31 sq m (154 sq. ft)