



Elthorne Avenue, W7

£500,000

This three bedroom flat is arranged over two floors offering two bathrooms and excellent living space for professional sharers or a small family. Fully renovated to a high standard throughout.

Located in this increasingly popular area close to Elthorne Park with easy access to Boston Manor Piccadilly Line Station and the Elizabeth Line at West Ealing.

Features

- Three Double Bedrooms
- Two Bathrooms
- Newly Refurbished
- Split-Level
- Open-Plan
- Close To Stations

Elthorne Avenue,
London, W7

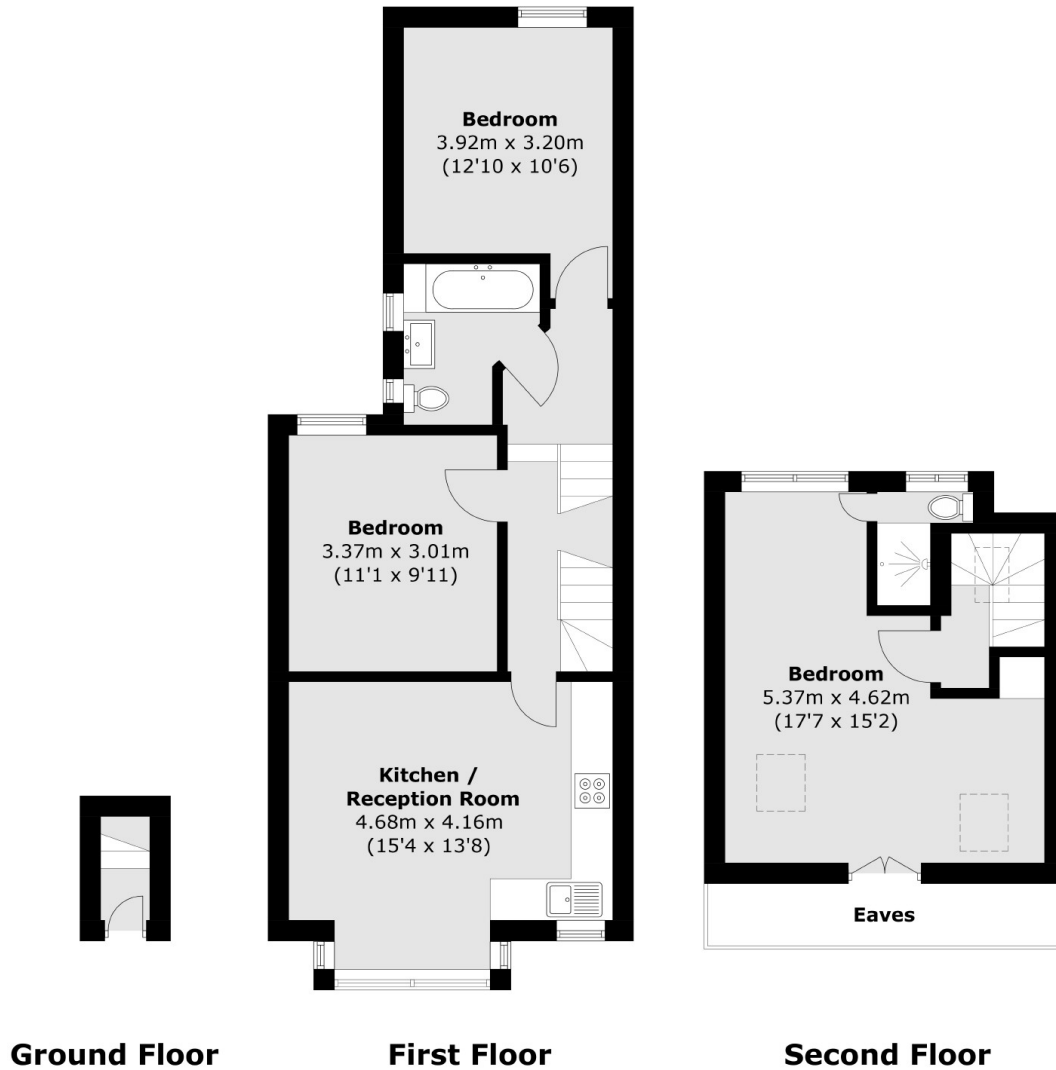

Total area (approx.): 77.6 sq. m (835.3 sq. ft)