



Tewkesbury Road, W13

£392 Per week

This contemporary third floor one bedroom apartment, recently built, features a spacious living area with a south-facing balcony and internal communal gardens.

Located in this recently built development with communal gardens and has the bonus of its own local Café and on-site CCTV for a safe and tranquil environment.

Features

- One Bedroom
- South Facing Balcony
- Communal Gardens
- Close to Station
- Modern Finish
- Lift Access

Tewkesbury Road,
London, W13

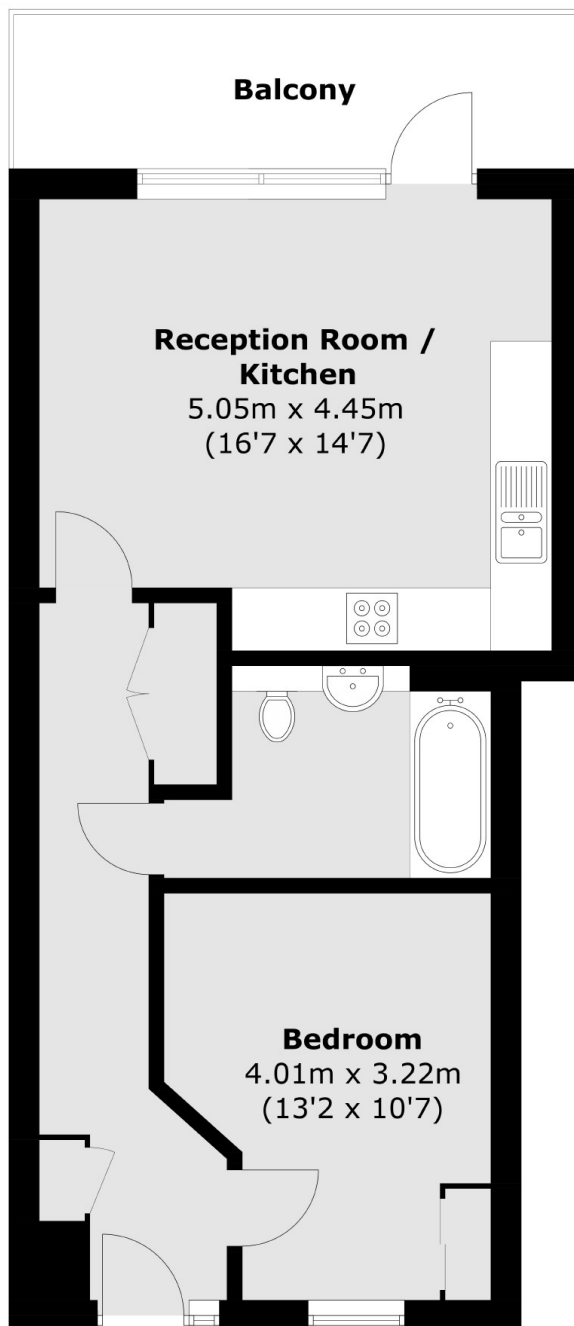

Total area (approx.): 51.2 sq. m (551.1 sq. ft)
Balcony (approx.): 8.4 sq. m (90.4 sq. ft)

Dexters

Northfields
140 Northfield Avenue
London
W13 9SB
Lettings
020 8545 8589

Energy Rating: . We aim to make our particulars both accurate and reliable. However they are not guaranteed; nor do they form part of an offer or contract. If you require clarification on any points then please contact us, especially if you're traveling some distance to view. Please note that appliances and heating systems have not been tested and therefore no warranties can be given as to their good working order.

 **RICS** | Regulated
Estate Agent
and Letting Agent

dexters.co.uk