



Loveday Road, W13

£995,000

This rarely available three-bedroom, three-bathroom house is a must-see. Presented to the market chain-free, it boasts desirable features such as off-street parking and a charming south-west facing garden.

Features

- Three Double Bedrooms
- Three Bathrooms
- Off-Street Parking
- South-West Facing Garden
- Chain Free

Loveday Road, London, W13

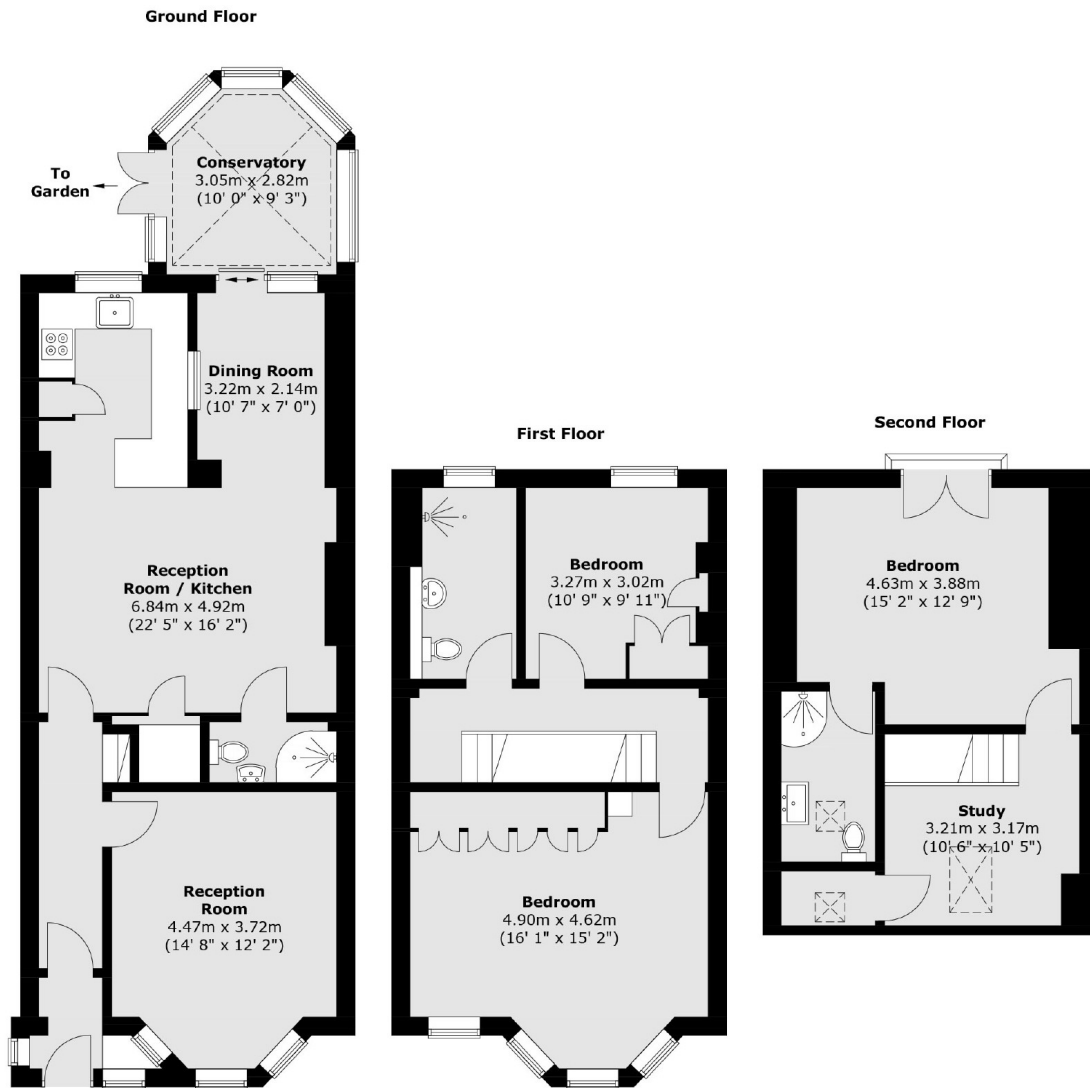

Total area (approx.) : 150.5 sq. m (1620 sq. ft)