



North Road, W5 £350,000

A modern apartment with a private south facing balcony. This refurbished one double bedroom apartment has a spacious modern kitchen, separate reception room with wooden flooring, ample storage with the loft space above and permit parking. This property also benefits from an additional storage room which can be used as a multi purpose area.

Located just a stones throw from South Ealing High Street, the property is also within close reach of South Ealing Station (Piccadilly Line) which gets you to Ealing Broadway where you can get on the Elizabeth Line within and the M4 is also a very short drive away.

Features

- Top Floor Flat
- Modern Spec
- Recently Refurbished
- Permit Parking
- Low Service Charge
- Private Balcony

North Road,
London, W5

Second Floor

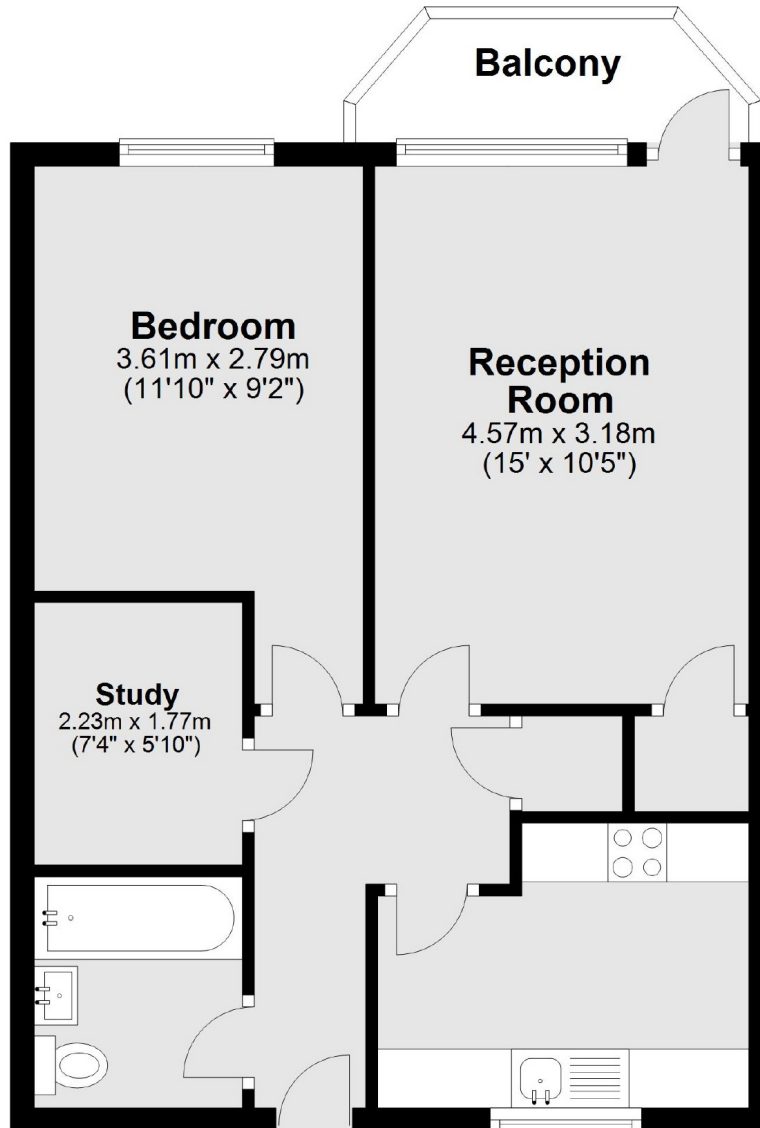

Main area: Approx. 48.5 sq. metres (522.5 sq. feet)
Plus balconies, approx. 3.4 sq. metres (36.4 sq. feet)