



## Northfield Avenue, W13 £310,000

A very well presented one bedroom ground floor maisonette is offered to the market with no onward chain. This immaculate property offers a reception room, contemporary fitted kitchen with ample cupboard space including a dishwasher and washing machine, bedroom with fitted wardrobe space and a neatly appointed bathroom with shower over the bath.

Model Cottages is set in an idyllic location, with views over the allotments and close to the wonderful variety of shops and restaurants on nearby Northfield Avenue. Ealing Broadway and its shopping centre is only a short walk away, as are the stations at West Ealing and Northfields.

### Features

- Chain Free
- Low Service Charge
- Ground Floor
- Period Maisonette
- Close To Amenities
- Sought After Location

Northfield Avenue,  
London, W13

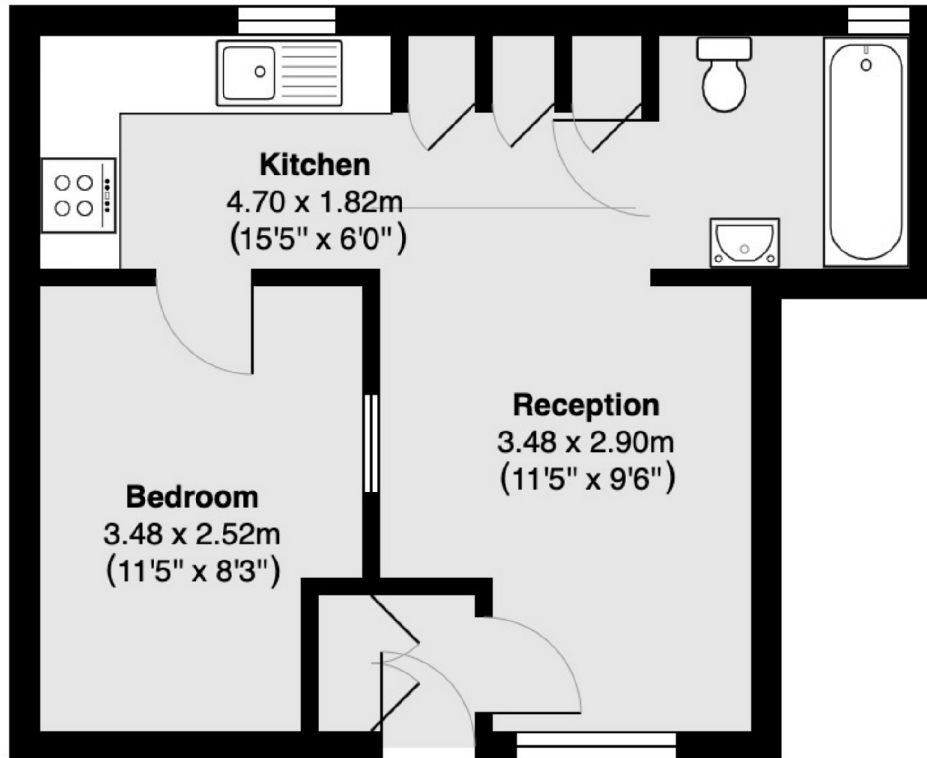

**Total area 32.5 sq m ( approx ) ( 350 sq ft approx )**