



Rosebank Road, W7

£675,000

Offers in Excess Of

This two double bedroom property, in need of modernisation, is presented to the market with no onward chain. The property comprises of 1,400 square feet, potential to extend to the rear and into the loft (STPP) and benefits from a double garage and a large garden.

Ideally located for Boston Manor Tube and Hanwell Station for a choice of excellent transport links. Well regarded school catchments to choose from including St Marks, Oaklands and Elthorne to name a few.

Features

- Freehold House
- Potential To Extend (STPP)
- Over 1,440 Square Feet
- Chain Free
- Double Garage
- Within Elthorne Catchment

Rosebank Road, London, W7

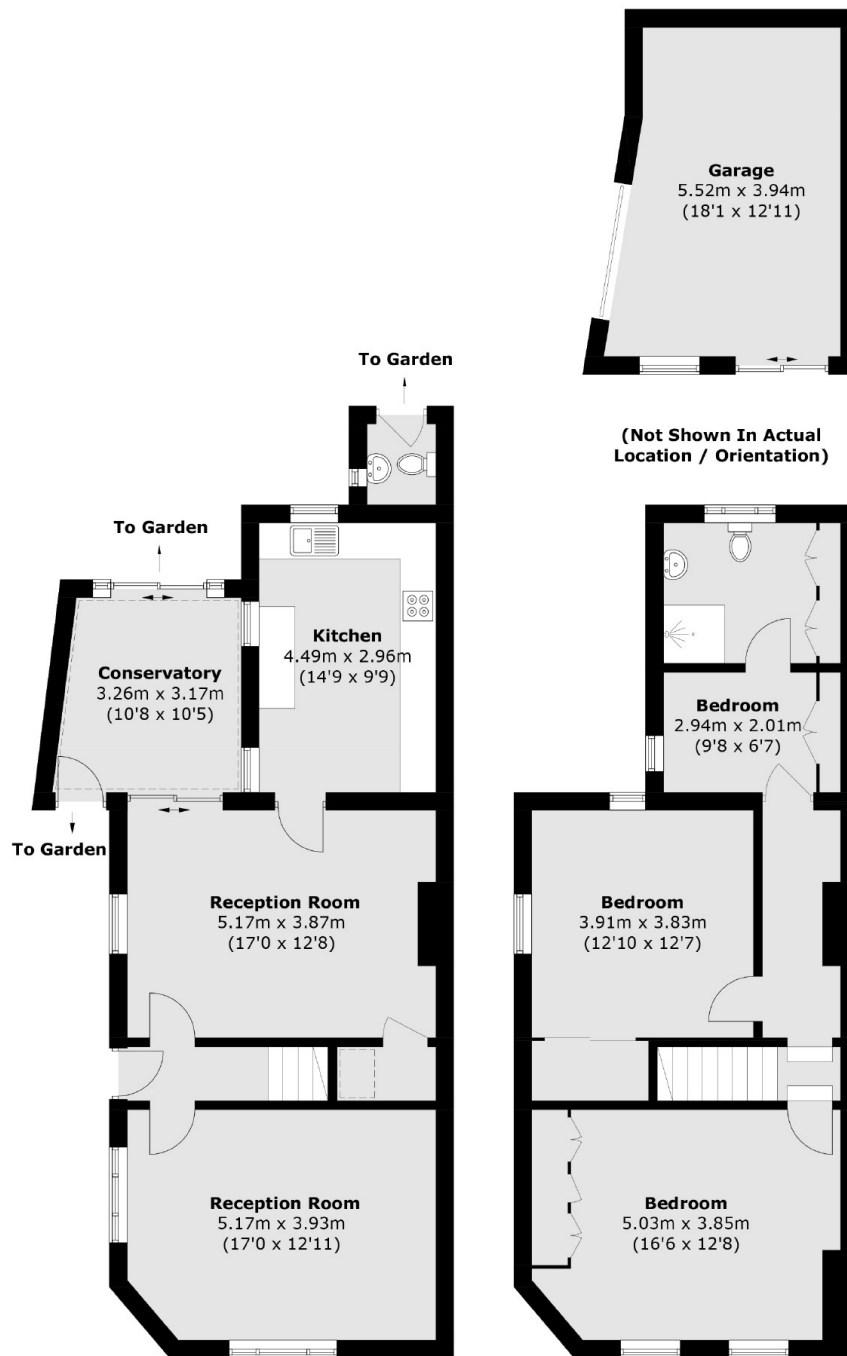

Ground Floor

Total area (approx.): 130.3 sq. m (1,402.5 sq. ft)

Garage area (approx.): 19.7 sq. m (212.0 sq. ft)

WC area (approx.): 1.7 sq. m (18.3 sq. ft)

First Floor

Dexters

Northfields
140 Northfield Avenue
London
W13 9SB

Sales
020 8545 8588

Energy Rating: E. We aim to make our particulars both accurate and reliable. However they are not guaranteed; nor do they form part of an offer or contract. If you require clarification on any points then please contact us, especially if you're traveling some distance to view. Please note that appliances and heating systems have not been tested and therefore no warranties can be given as to their good working order.

 **RICS** | Regulated
Estate Agent
and Letting Agent

dexters.co.uk