



Pioneer Way, Bicester

£524,950 5 Bedroom House



A beautiful and substantial new build 'Linden' five double bedroom detached townhouse, situated on the Kingsmere development in Bicester. The property has never been occupied as it has been used as the Linden Homes show home. The accommodation is set over three levels and is very well presented. There is a landscaped garden, garage and parking for two cars.

- Detached home
- 5 double bedrooms
- Family bathroom & 2 en suites
- Study/play room
- Living room & French doors to garden
- Garage & 2 parking spaces

Freehold

Lease: N/A

Service Charge: N/A

Ground Rent: N/A

Contact: 01865 302314

Website Ref: P138793

Inspired 
Sales & Acquisitions
FindersKeepers™



EPC rating: B

Parking: Garage

Council tax: Cherwell District,
Band E

Locality: Town/City

Motorway: M40 - J9

Train: Bicester Village



Ground Floor

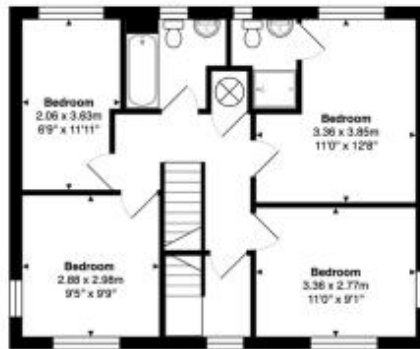

First Floor

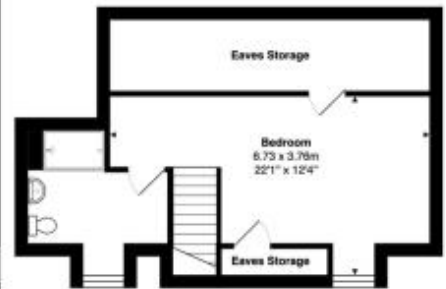

Second Floor

Approx. Gross Internal Area: 150.0 m² ... 1615 ft²

Whilst every attempt has been made to ensure the accuracy of the floor plan contained here, measurements of doors, windows, rooms, and any other items are approximate. No responsibility is taken for any error, omission, or mis-statement. This plan is for illustrative purposes only and should be used as such. Drawn by EB Property Services, www.ebps.co.uk

