



OFFICE TO LET

1 KINGSWAY

London, WC2B 6XD

FROM 6,000 - 27,000 SQ FT OF GRADE A OFFICE SPACE AVAILABLE IN THIS
LANDMARK BUILDING

6,000 TO 27,042 SQ FT (557.42 TO 2,512.28 SQ M)



**BNP PARIBAS
REAL ESTATE**

www.realestate.bnpparibas.co.uk



DETAILS



DESCRIPTION

The property comprises a mixed-use building arranged over 12 floors, originally constructed in 1920 and redeveloped in 2011. The property provides retail space on the basement and part ground floors, office space on the upper eight floors and residential space above with a basement car parking facility.

ACCOMMODATION

The accommodation comprises of the following

Name	sq ft	sq m	Tenure	Availability
6th	13,422	1,246.94	To Let	Let
5th	13,300	1,235.61	To Let	Available
4th	13,742	1,276.67	To Let	Available
3rd - Part (West)	6,544	607.96	To Let	Let
Total	47,008	4,367.18		

KEY FEATURES

- Grade A development with a large, light floorplate
- New contemporary arrival experience and reception being delivered in May 2022
- Rooftop club house with bookable meeting & event space
- Highly flexible, low maintenance energy-efficient air conditioning
- Cyclescore: Gold
- New cycling and high end shower amenity

OUTGOINGS

- Rent: £85 per sq ft
- Rates: £29.30 per sq ft
- Service charge: £15.22 per sq ft Approx.
- Estate charge: n/a
- EPC: C

1 KINGSWAY

London, WC2B

TO REQUEST A VIEWING CALL US 0207 338 4000



**BNP PARIBAS
REAL ESTATE**

www.realestate.bnpparibas.co.uk

LOCATION



Located only a few minutes from the Piccadilly, Central, Circle, District, Northern & Bakerloo Underground line and mainline National Rail stations Charing Cross & Waterloo.

1 Kingsway is excellently connected to the rest of London. As well as being close to the cultural activities of Covent Garden.

CONTACT US

Robert Rooney
07469 403 225
robert.rooney@realestate.bnpparibas

Ben Rainbow
ben.rainbow@realestate.bnpparibas

BNP Paribas Real Estate (City Agency, City Office
Leasing)
5 Aldermanbury Square, London, EC2V 7BP

www.realestate.bnpparibas.co.uk
0207 338 4000
realestate.enquiries@bnpparibas.com
[linkedin.com/company/bnp-paribas-real-estate/](https://www.linkedin.com/company/bnp-paribas-real-estate/)
@BNPPRE_UK

Misrepresentation Act 1967: BNP Paribas Real Estate Advisory & Property Management UK Limited for themselves and for the vendor(s) or lessor(s) of this property whose agents they are, give notice that: 1. These particulars do not constitute, nor constitute any part of, an offer or contract. 2. None of the statements contained in these particulars as to the property are to be relied on as statements or representations of fact. 3. Any intending purchaser or lessee must satisfy himself by inspection or otherwise as to the correctness of each of the statements contained in these particulars. 4. The vendor(s) or lessor(s) do not make or give and neither BNP Paribas Real Estate Advisory & Property Management UK Limited nor any person in their employment has any authority to make or give, any representation or warranty whatever in relation to this property. Finance Act 2013: Unless otherwise stated all prices and rents are quote exclusive of VAT. The Business Protection from Misleading Marketing Regulations 2008: These details are believed to be correct at the time of compilation but may be subject to subsequent amendment. Generated by Agentsinsight / Generated on 12/07/2024

1 KINGSWAY, LONDON, WC2B 6XD
TO REQUEST A VIEWING CALL US ON 0207 338 4000



www.realestate.bnpparibas.co.uk

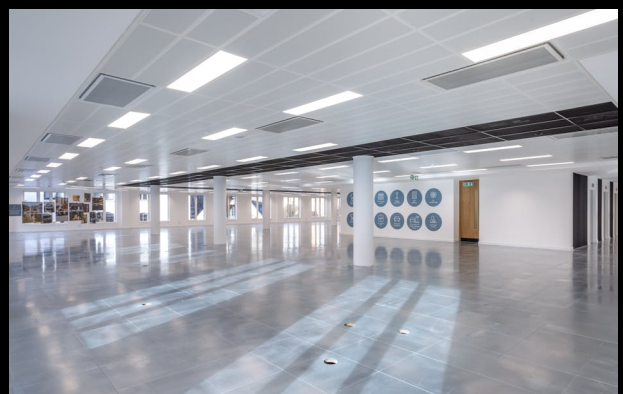

1 KINGSWAY, LONDON, WC2B 6XD
TO REQUEST A VIEWING CALL US ON 0207 338 4000



www.realestate.bnpparibas.co.uk



1 KINGSWAY, LONDON, WC2B 6XD
TO REQUEST A VIEWING CALL US ON 0207 338 4000



www.realestate.bnpparibas.co.uk



1 KINGSWAY, LONDON, WC2B 6XD
TO REQUEST A VIEWING CALL US ON 0207 338 4000



www.realestate.bnpparibas.co.uk

