



- TWO Bedroom Apartment
- Spacious Lounge
- Modern Kitchen With White Goods
- Allocated Parking Space
- Available Unfurnished From End of August

- First Floor
- Fitted Wardrobes
- Bathroom With Overhead Shower
- Close To Uxbridge Town Centre
- EPC Rating B

A spacious TWO-bedroom apartment in Tedder Close, Uxbridge. This delightful first-floor apartment boasts a prime location close to Uxbridge Town Centre, offering convenience and accessibility to all amenities and Uxbridge and Hillingdon tube stations nearby.

Upon entering, you are greeted by a spacious entrance hallway, a bright and airy lounge, two double bedrooms with fitted wardrobes, a modern fitted kitchen with white goods and a bathroom with an overhead shower

Further benefits include; gas central heating and double glazing, you can stay warm and cosy during the colder months while enjoying natural light throughout the year, storage cupboards and an entryphone system.

The allocated parking space adds to the convenience of this home, providing a secure space for your vehicle, there are also visitor parking spaces.

With a total of approx 753 sq ft of living space, this property offers a comfortable and inviting atmosphere for you to call home. Don't miss out on the opportunity to own or rent this lovely house in Uxbridge - a true gem in a sought-after location!

Available from end of August unfurnished.

Price - rent: £1,650 pcm

Deposit: £1,903.845 (5 weeks rent)

Holding deposit: £380.77 (1 week's rent - which will be used towards the remaining move-in money due)

Length of tenancy: Minimum 12 months

Local authority: Hillingdon

Council tax band: C

*Please note all dimensions and descriptions are to be used as a guide only by any prospective tenant and do not constitute representations of fact or form part of any offer or contract.

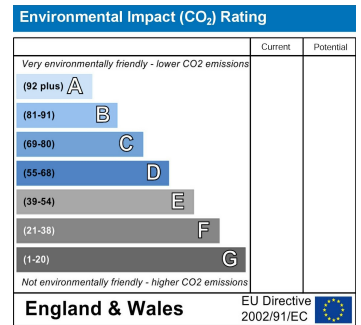
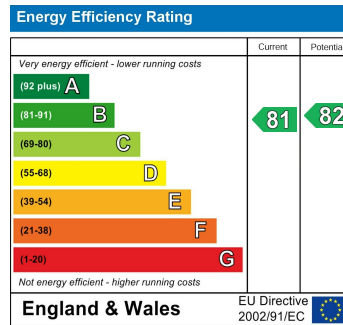

GROUND FLOOR
744 sq.ft. (69.1 sq.m.) approx.

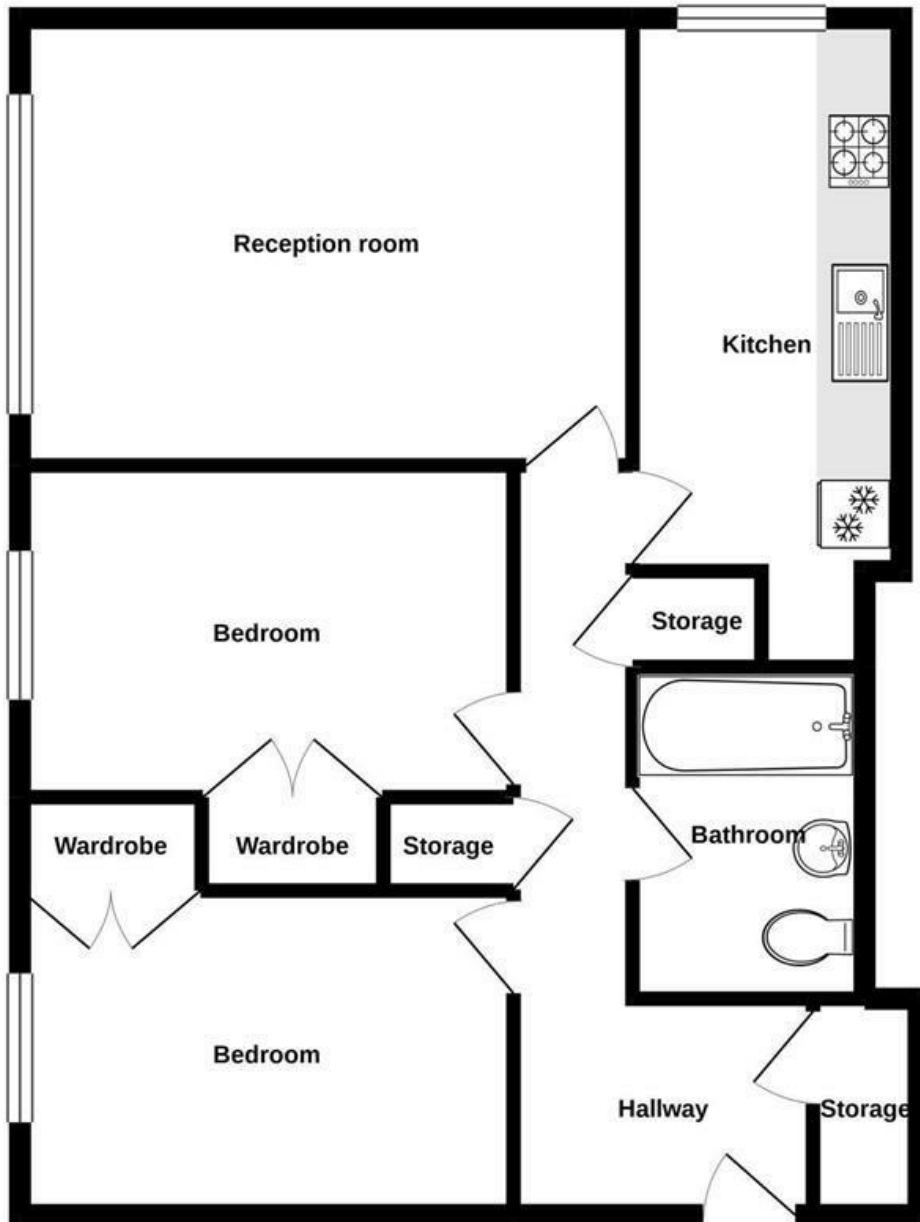

TOTAL FLOOR AREA : 744 sq.ft. (69.1 sq.m.) approx.

Whilst every attempt has been made to ensure the accuracy of the floorplan contained here, measurements of doors, windows, rooms and any other items are approximate and no responsibility is taken for any error, omission or mis-statement. This plan is for illustrative purposes only and should be used as such by any prospective purchaser. The services, systems and appliances shown have not been tested and no guarantee as to their operability or efficiency can be given.
Made with Metropix ©2020

These particulars do not form part of any offer or contract and must not be relied upon as statements or representations of fact. Any areas, measurements or distances are approximate. The text, photographs and plans are for guidance only and are not necessarily comprehensive. It should not be assumed that the property has all the necessary planning, building regulation or other consents and we have not tested services, equipment or facilities. Purchasers must satisfy themselves by inspection or otherwise.

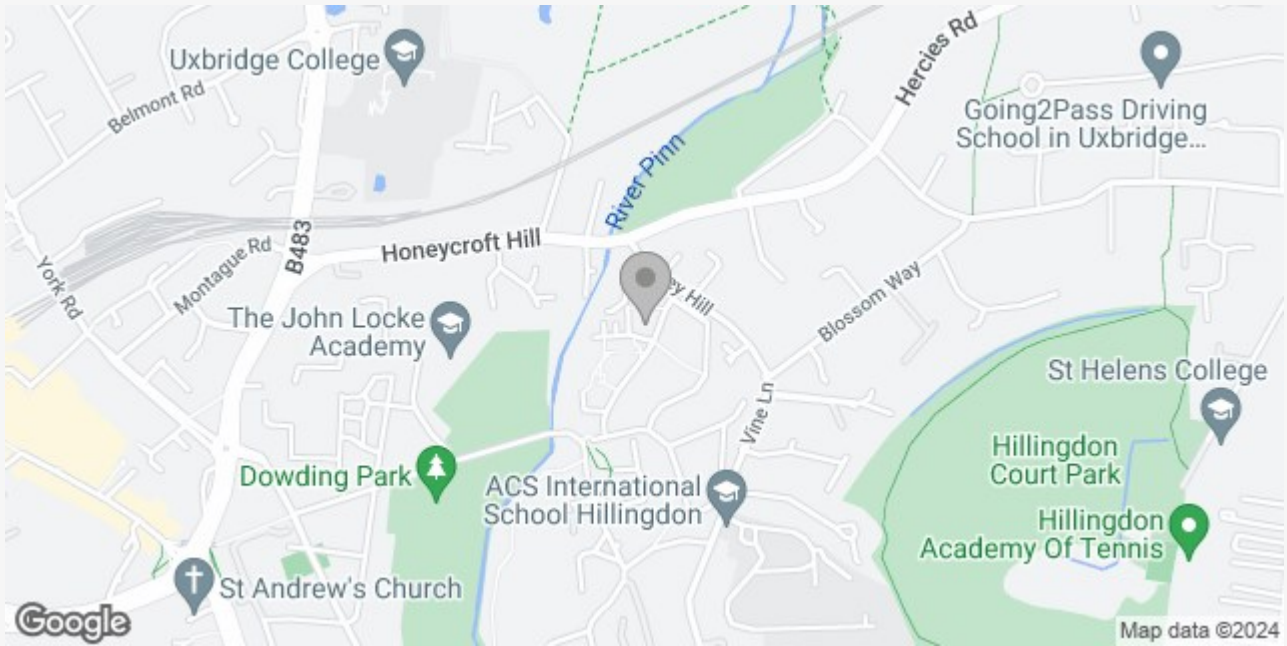

LAKIN & CO – YOUR LOCAL ESTATE AGENT

We are an independent Estate Agent, providing residential sales, lettings, property management, block management and financial services primarily throughout Uxbridge, Hillingdon, Ickenham and Ruislip areas.

Dealing with thousands of landlords, tenants, vendors and buyers throughout our core areas, we are renowned for providing a dedicated and attentive service to all of our clients. Our excellent reviews, ratings and membership to the Association of Residential Lettings (ARLA) and The Property Ombudsman (TPO) is testimony to our excellent service.

We take great pride in being known for our honesty and consistent hard work, so whether you are selling or letting your property or looking to find your ideal home please contact us now and let us assist you further.