



- Two Bedrooms
- First Floor
- Allocated Parking
- Entryphone System
- Gas Central Heating

- Two Bathrooms
- No Upper Chain
- Close To Uxbridge Town Centre
- Double Glazing
- EPC Rating C

A TWO double bedroom TWO bathroom well presented first floor apartment located in a modern development close by to Uxbridge town centre and tube station. The apartment has an abundance of usable space and would suit someone looking to get on the property ladder or as an investment to rent out.

Briefly comprising; entrance hallway with doors leading to a large lounge/diner with Juliet balcony, modern fitted kitchen with wall and base units, master bedroom with own en suite, second bedroom and a white suite family bathroom. Benefiting from; allocated parking space, additional storage, intercom system, double glazing & gas central heating.

The property is situated in a quiet residential development close by to Uxbridge town centre that offers access to two shopping centres, restaurants, bars, coffee shops and supermarkets. It also houses the Metropolitan/Piccadilly lines which get you in to London within the hour. For motorist the M/A40 and M25 are within a short drive. Heathrow airport is a 17 minute drive away, and Hillingdon Hospital can be reached in under 10 minutes.

Leasehold - 111 years lease (approx.)
 Service Charge - £1,768 PA (approx)
 Ground rent £500 PA - Reviewed date tbc
 Hillingdon Council
 Council Tax Band D

Disclaimer:

These particulars are a general guide only for prospective buyers. They do not form part of any contract. Services, systems and appliances have not been tested.

Buyers information:

In accordance with HMRC Anti Money Laundering Regulations a buyer(s) must attend our office to provide Photo Identification and Proof of Address (valid in last 3 months).

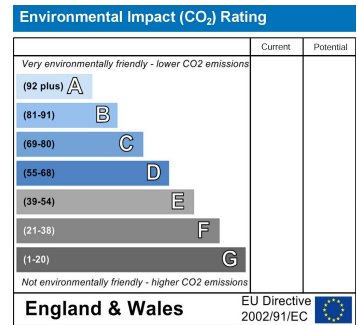
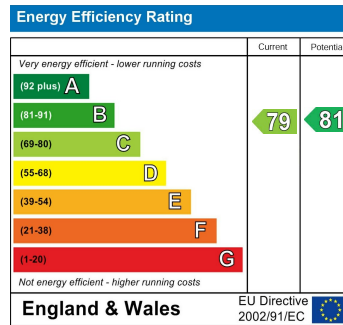

Itea Court, Lindie Gardens, Uxbridge, UB8

Approximate Area = 657 sq ft / 61 sq m

For identification only - Not to scale

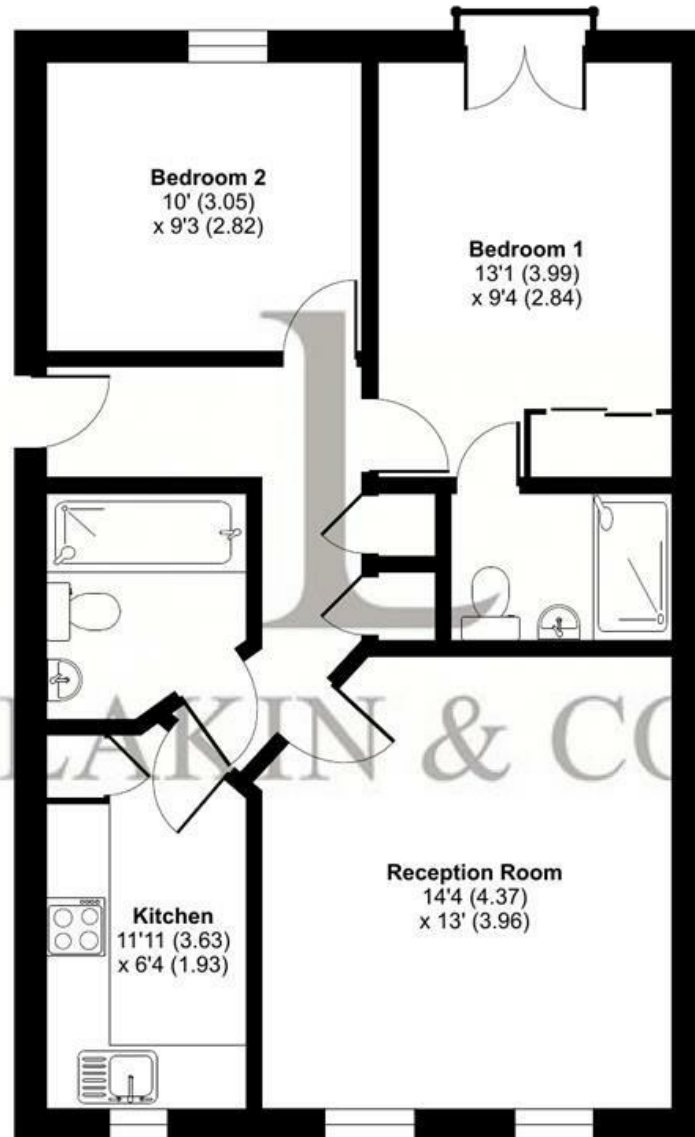

FIRST FLOOR



Floor plan produced in accordance with RICS Property Measurement Standards incorporating International Property Measurement Standards (IPMS2 Residential). © rithecom 2024. Produced for Lakin & Co. REF: 1107218

These particulars do not form part of any offer or contract and must not be relied upon as statements or representations of fact. Any areas, measurements or distances are approximate. The text, photographs and plans are for guidance only and are not necessarily comprehensive. It should not be assumed that the property has all the necessary planning, building regulation or other consents and we have not tested services, equipment or facilities. Purchasers must satisfy themselves by inspection or otherwise.



LAKIN & CO – YOUR LOCAL ESTATE AGENT

We are an independent Estate Agent, providing residential sales, lettings, property management, block management and financial services primarily throughout Uxbridge, Hillingdon, Ickenham and Ruislip areas.

Dealing with thousands of landlords, tenants, vendors and buyers throughout our core areas, we are renowned for providing a dedicated and attentive service to all of our clients. Our excellent reviews, ratings and membership to the Association of Residential Lettings (ARLA) and The Property Ombudsman (TPO) is testimony to our excellent service.

We take great pride in being known for our honesty and consistent hard work, so whether you are selling or letting your property or looking to find your ideal home please contact us now and let us assist you further.