



65 MAYGROVE ROAD LONDON, NW6 2DA

£3,750 PCM

TEMPORARY SCAFFOLDING currently at the property so the RENT is negotiable for a period of time - Situated within Beaufort Court in West Hampstead, this stylish and spacious three double bedroom apartment offers modern living with a high-quality finish throughout.

The property features a open-plan reception area with wooden flooring and underfloor heating, opening directly onto a private balcony. A sleek, fully fitted kitchen with integrated appliances completes the living space.

The principal bedroom includes an en-suite bathroom, two more double bedrooms and a three piece family bathroom. Additional benefits include a welcoming concierge service for residents.

Hemmingfords

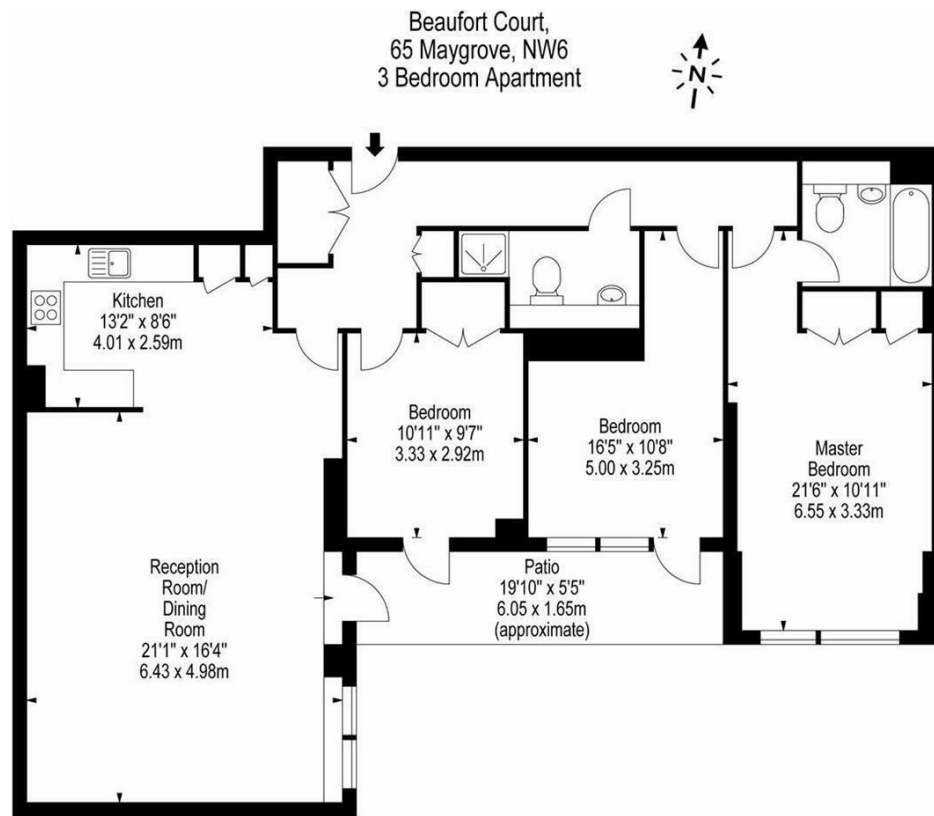

Ground Floor

Approx Gross Internal Area **1218 Sq Ft - 113.15 Sq M**
 Floor Plan Supplied For Identification Purposes Only And May Not Be Accurate
 Floor Plan by www.elegantmediasolution.com



Energy Efficiency Rating		
	Current	Potential
Very energy efficient - lower running costs		
(92 plus) A		
(81-91) B		
(69-80) C		
(55-68) D		
(39-54) E		
(21-38) F		
(1-20) G		
Not energy efficient - higher running costs		
England & Wales	EU Directive 2002/91/EC	

Agents Note: Whilst every care has been taken to prepare these particulars, they are for guidance purposes only. All measurements are approximate and are for general guidance purposes only and whilst every care has been taken to ensure their accuracy, they should not be relied upon and potential buyers/tenants are advised to recheck the measurements

Hemmingfords Lettings
 Second Floor
 34 Upper Street
 London
 N1 0PN

020 3890 7470
info@hemmingfords.co.uk
www.hemmingfords.co.uk

Hemmingfords