

3 GARWOODS LODGE 421 HIGH ROAD N22 8JU

£300,000
LEASEHOLD

PRIVATE GARDEN/CHAIN FREE A beautifully presented well proportioned, one bedroom ground floor flat benefiting from a spacious interior presented to the highest standard, a private garden and a great location.

Garwoods Lodge is brilliantly located close to the shops and restaurants found in and around Wood Green, with the green, open spaces of New River Recreation Ground also only moments away.

Hemmingfords

Garwoods Lodge, N22
 CAPTURE DATE: 07/07/2021 LASER SCAN POINTS: 2,020,264
 GROSS INTERNAL AREA
 49.86 sqm / 536.69 sqft

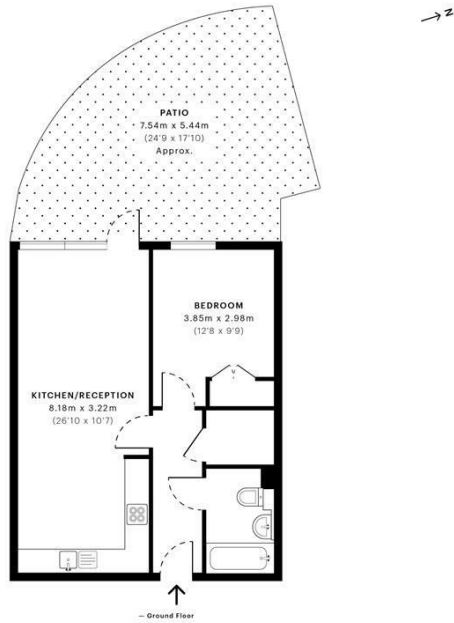

GROSS INTERNAL AREA (GIA)
The footprint of the property
49.86 sqm / 536.69 sqft

NET INTERNAL AREA (NIA)
Excludes walls and external features
Includes swimming pools, covered terraces, etc.
47.96 sqm / 516.24 sqft

EXTERNAL STRUCTURAL FEATURES
Balconies, terraces, verandas, etc.
0.00 sqm / 0.00 sqft

RESTRICTED HEAD HEIGHT
Limited use area under 1.8m
0.00 sqm / 0.00 sqft

spec Verified

RICS Certified Property Measurement

Spec Verified floor plans are produced in accordance with Royal Institution of Chartered Surveyors' Property Measurement Standards. Pits and gardens are illustrative only and excluded from all area calculations. Due to rounding, numbers may not add up precisely. All measurements shown for the individual room lengths and widths are the maximum points of measurements captured in the scan.

area Residential: 50.70 sqm / 545.73 sqft
area Commercial: 48.96 sqm / 527.00 sqft

spec id: 60a432b496a920d8f82c1a

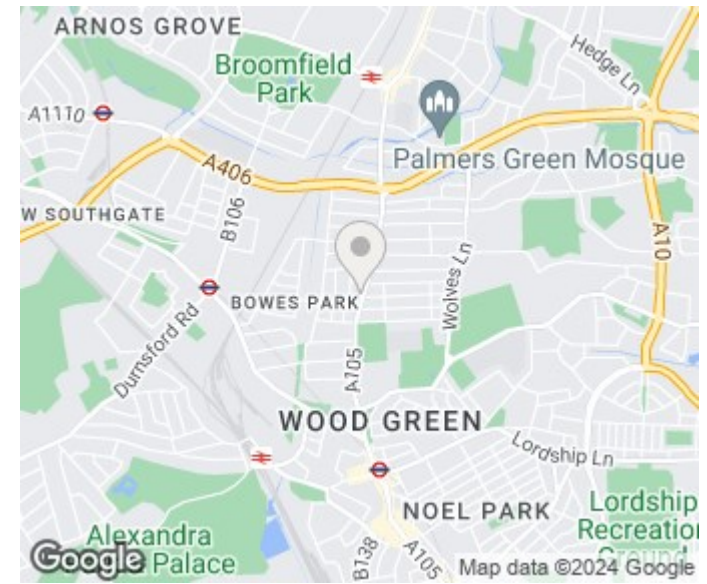

Energy Efficiency Rating		Current	Potential
Very energy efficient - lower running costs			
(92 plus) A			
(81-91) B		79	79
(69-80) C			
(55-68) D			
(39-54) E			
(21-38) F			
(1-20) G			
Not energy efficient - higher running costs			
England & Wales		EU Directive 2002/91/EC	

Agents Note: Whilst every care has been taken to prepare these particulars, they are for guidance purposes only. All measurements are approximate and are for general guidance purposes only and whilst every care has been taken to ensure their accuracy, they should not be relied upon and potential buyers/tenants are advised to recheck the measurements

Hemmingfords Sales & Lettings
 Second Floor
 34 Upper Street
 London
 N1 0PN

02038907470
 info@hemmingfords.co.uk
 www.hemmingfords.co.uk

Hemmingfords