

Maidstone Methodist Church Community Center

20 Brewer Street, Maidstone, Kent, ME14 1RU



Community Centre Building FOR SALE

Maidstone Methodist Church Community Center

20 Brewer Street, Maidstone, Kent, ME14 1RU

Key Features

- Self-Contained Community Building
- Potential for Residential Conversion
- Secure Car Park
- Large Open Plan Floors
- Town Centre Location
- Close to Maidstone East Station

Description

COMMUNITY CENTER BUILDING FOR SALE – Central Maidstone Location, suitable for a variety of uses or redevelopment with secure car parking.

Maidstone Methodist Community Center building is situated immediately to the rear of the main Grade II Listed Methodist Church, accessed directly off Brewer Street in the Town Center. It is an attached, 2-storey concrete framed building with brick and rendered elevations under a pitched tiles roof. Internally it has two large open plan halls / rooms plus ancillary accommodation. In addition, there is a separate detached store building / garage.

The property would also be suitable for residential conversion, subject to obtaining the necessary consents from Maidstone Borough Council.



Maidstone Methodist Church Community Center

20 Brewer Street, Maidstone, Kent, ME14 1RU

Accommodation

It is an attached, 2-storey building benefiting from two large open plan halls/rooms, one on the ground floor and one on the first floor, both providing excellent floor to ceiling height and parquet flooring. The ground floor itself has additional rooms and large kitchen area as well and ladies and gents wcs. There are additional offices/stores on the split level off of the staircase. On the first floor in addition to the main room there is a large office/training room. In addition, there is a separate detached store building/garage.

The property has been measured on a Gross Internal Area Basis (GIA) as follows:

Area	Sq Ft	Sq M
Ground	3,183	295.7
First	920	85.47
Second	2,178	202.34
Garage	286	26.57
Total	6,568	610.17

There is secure parking for circa 12+ cars.

Rateable Value

To Be Re-Assessed

Price

Offers invited in the region of £750,000 for the Virtual Freehold with Vacant Possession

New 999-Year Long Leasehold.

Title to be split upon sale.

VAT

All figures are exclusive of VAT which will be charged at the prevailing rate

EPC

Awaited

Legal Costs

Each side to bear their own legal costs

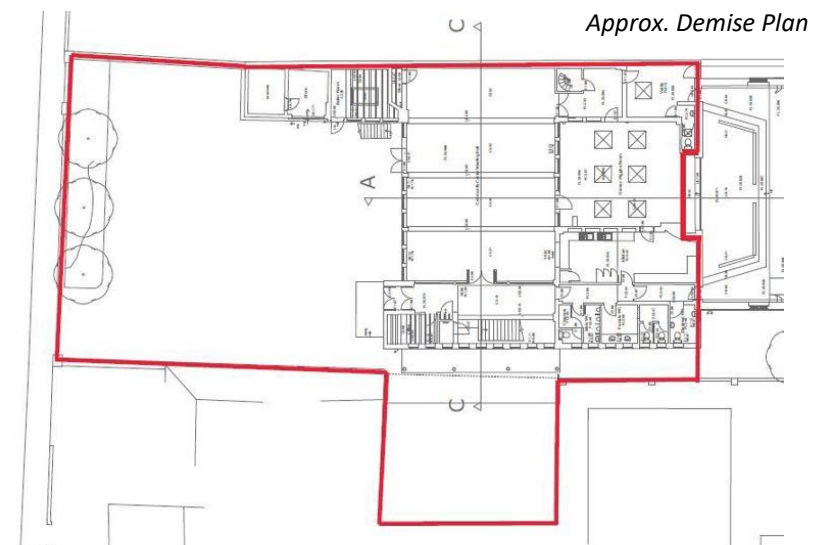

Maidstone Methodist Church Community Center

20 Brewer Street, Maidstone, Kent, ME14 1RU

Location

Located in the heart of the County Town of Kent, Brewer Street is just north of Week Street, the primary retail area of Maidstone, close to County Hall and the railway stations. There is a large public car park immediately adjacent to the site. The property is situated 0.1 miles from Maidstone East station which has services to London in around 1 hour.

Maidstone is situated in the center of Kent Having a population of approximately 75,000. It is 36 miles south east of London and close to the M20 providing excellent access to the motorway network, Channel Tunnel and ports at Dover.

What3Words Location:- <https://w3w.co/method.spent.field>

For all Viewings and Enquiries contact:



Phil Hubbard

phil.hubbard@sibleypares.co.uk



Matthew Sadler

matt.sadler@sibleypares.co.uk



SIBLEY PARES

CHARTERED SURVEYORS & ESTATE AGENTS

01622 673086

sibleypares.co.uk

NOTE: Rental prices or any other charges are exclusive of VAT unless otherwise stated. MISREPRESENTATION ACT 1967. These particulars are believed to be correct, their accuracy cannot be guaranteed and are expressly excluded from any other contract. Any intending purchaser must satisfy himself by inspection or otherwise as to the correctness of each of the statements contained in these particulars. No fittings, appliances or services mentioned have been tested by Sibley Pares.

