



## Marine Parade, Worthing

Asking Price £225,000

Aspire Residential are delighted to offer to the market, this one bedroom ground floor flat positioned on Worthing's desirable seafront. Internally the property requires updating, however offers a fantastic opportunity for someone to come in and add their own stamp. The external and internal communal areas have recently undergone extensive redecorations. Locally you will find popular transport links as well as easy access into the town centre. The new lease terms will present the incoming buyer with the opportunity to either let on a short term basis such as 'Air BnB', or a normal longer term agreement making it a fantastic investment if you are not buying it as a home. Call us today to book your viewing.



Council Tax Band:



- Ground Floor Character Flat With Sea Views
- Long Lease Upon Completion
- No Forward Chain
- Gas Fired Central Heating
- Lease - 125 upon completion

- In Need Of Updating
- Courtyard Garden
- EPC - Ordered
- Easy Access To The Town Centre
- Maintenance - £1300 & Ground rent £250p/a





Worthing, a picturesque seaside town on the south coast of England, exudes a unique charm with its blend of Victorian elegance and contemporary vitality. Known for its extensive pebble beach, historic pier, and well-maintained promenade, Worthing offers residents and visitors alike a captivating coastal experience. The town's vibrant cultural scene is enriched by theatres, art galleries, and frequent events, creating a lively atmosphere. With its beautiful parks, such as Beach House Park and Highdown Gardens, Worthing provides green spaces for leisure and relaxation. The town's bustling town centre features a diverse array of shops, restaurants, and entertainment venues, contributing to its reputation as a welcoming and thriving community. Worthing's accessibility, rich history, and scenic beauty make it a sought-after destination for those seeking a coastal haven with a perfect blend of tradition and modernity.



### EPC Rating:

Energy Efficiency Rating		
	Current	Potential
Very energy efficient - lower running costs		
(92 plus) <b>A</b>		
(81-91) <b>B</b>		
(69-80) <b>C</b>		
(55-68) <b>D</b>		
(39-54) <b>E</b>		
(21-38) <b>F</b>		
(1-20) <b>G</b>		
Not energy efficient - higher running costs		
<b>England &amp; Wales</b>	EU Directive 2002/91/EC	

### Floor Plan

Approx. 58.7 sq. metres (631.5 sq. feet)

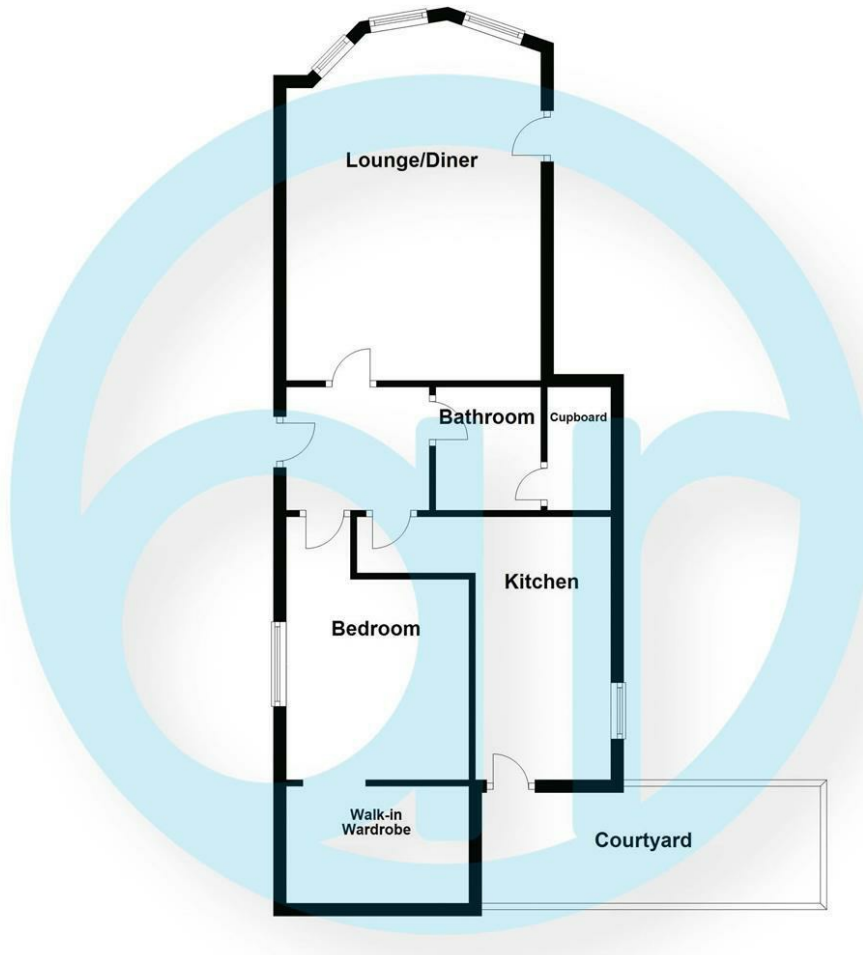

#### Aspire Residential | Goring-by-Sea

28 Goring Road  
Goring-by-Sea  
Worthing  
BN12 4AD  
Telephone: 01903 259 961  
Email: [info@aspireresidential.co.uk](mailto:info@aspireresidential.co.uk)



#### Aspire Residential | Durrington / Salvington

5 Selden Parade  
Salvington Road  
Worthing  
BN13 2HL  
Telephone: 01903 910 424  
Email: [enquiries@aspireresidential.co.uk](mailto:enquiries@aspireresidential.co.uk)

Aspire Residential and Aspire Residential Estate Agents are trading names of Aspire Residential Sales Limited, a Company registered in England and Wales with registration number 11659289. VAT No. 317450614

**IMPORTANT NOTICE TO PURCHASERS:** We endeavour to make our sales particulars accurate and reliable, however, they do not constitute or form part of an offer or any contract and none is to be relied upon as statements of representation or fact. The services, systems and appliances listed in this specification have not been tested by us and no guarantees as to their operating ability or efficiency are given. All measurements have been taken as a guide to prospective buyers only, and are not precise. If you require clarification or further information on any points, please contact us, especially if you are traveling some distance to view.