



ASPIRE
RESIDENTIAL



63 Ardingly Drive, Goring-By-Sea, Worthing, West Sussex,

Asking Price £240,000

- Popular Goring-By-Sea Location
- Two Bedrooms
- No Forward Chain
- Ground Floor Flat
- In Need of Modernisation
- South Facing Garden
- EPC - Ordered

Unit 1, 28 Goring Road, Worthing, BN12 4AD
01903 259961

info@aspireresidential.co.uk
<https://www.aspireresidential.co.uk/>

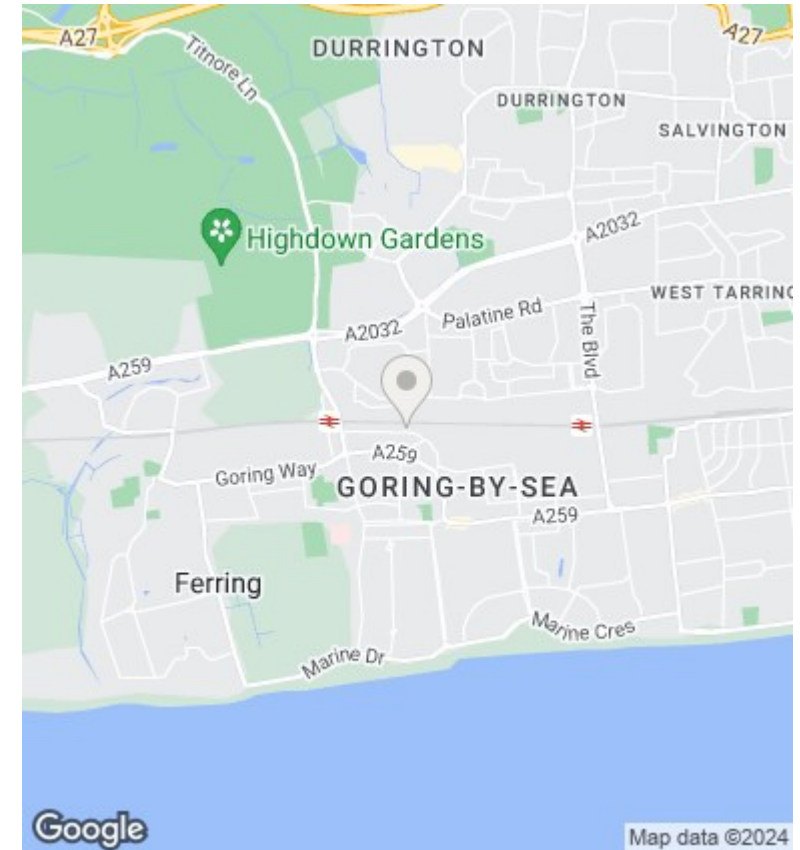
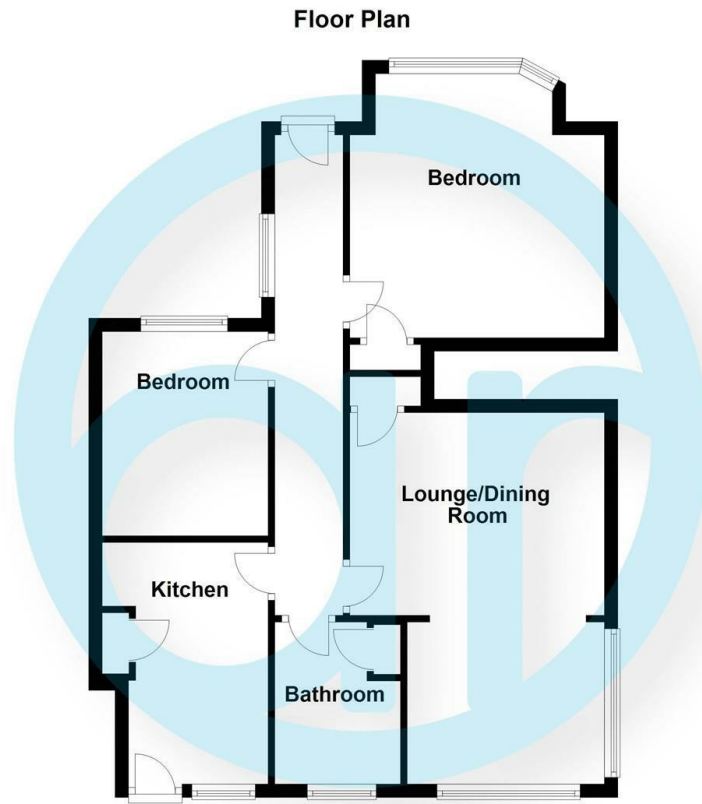

Directions

Viewings

Viewings by arrangement only. Call 01903 259961 to make an appointment.

Council Tax Band

B

EPC Rating:

D

Energy Efficiency Rating		Current	Potential
<i>Very energy efficient - lower running costs</i>			
(92 plus) A			
(81-91) B			
(69-80) C			
(55-68) D		67	75
(39-54) E			
(21-38) F			
(1-20) G			
<i>Not energy efficient - higher running costs</i>			
England & Wales		EU Directive 2002/91/EC	