



ASPIRE
RESIDENTIAL



4 Berkeley Square, Worthing, West Sussex, BN11 5AF

Asking Price £310,000

- Share Of The Freehold
- Long Lease Term
- EPC - D
- No Forward Chain
- West Facing Patio
- Located Off Popular Grand Avenue
- Garage In Compound
- Popular Location

Unit 1, 28 Goring Road, Worthing, BN12 4AD
01903 259961

info@aspireresidential.co.uk
<https://www.aspireresidential.co.uk/>

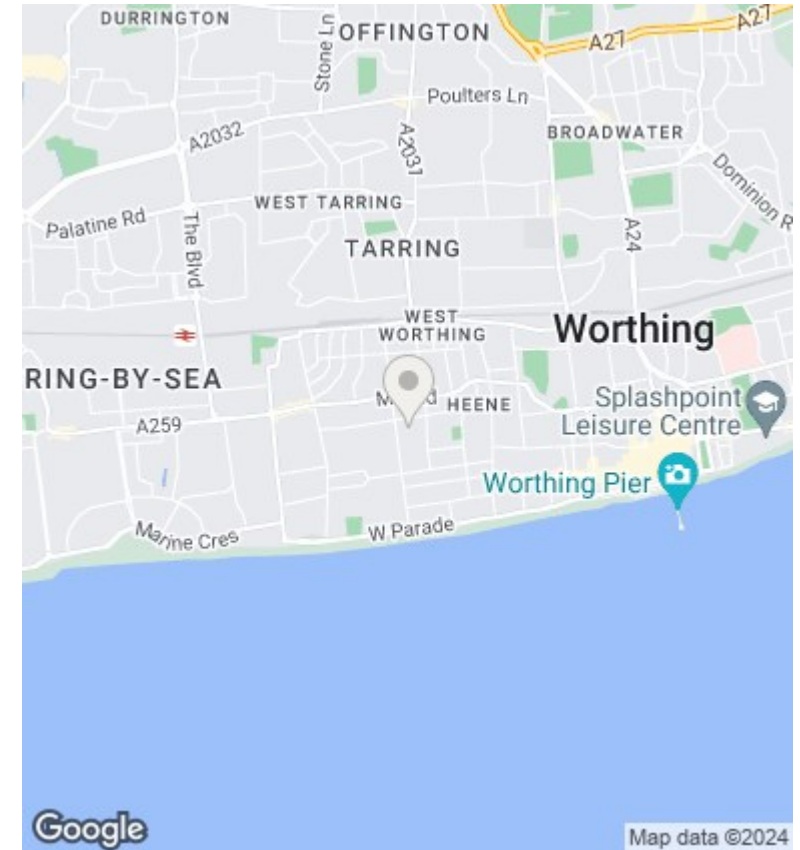
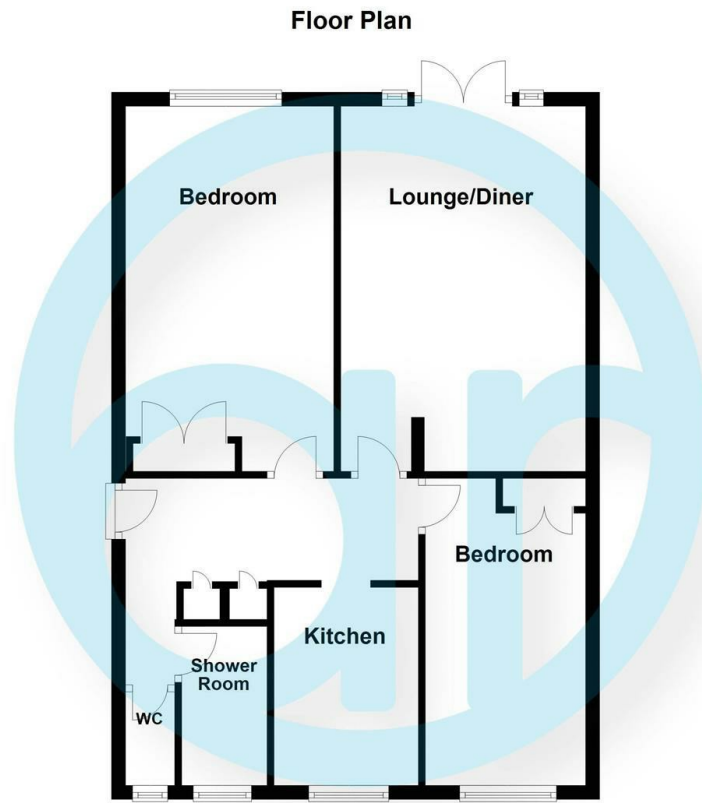

Directions

Viewings

Viewings by arrangement only. Call 01903 259961 to make an appointment.

Council Tax Band

C

EPC Rating:

D

Energy Efficiency Rating		Current	Potential
<i>Very energy efficient - lower running costs</i>			
(92 plus)	A		
(81-91)	B		76
(69-80)	C		
(55-68)	D	62	
(39-54)	E		
(21-38)	F		
(1-20)	G		
<i>Not energy efficient - higher running costs</i>			
England & Wales		EU Directive 2002/91/EC	