



ASPIRE
RESIDENTIAL



234 Goring Road, Goring-By-Sea, Worthing, West Sussex, Asking Price £575,000

- Extended Four Bedroom Semi Detached House
- En Suite
- No Forward Chain
- Off Road Parking
- Fantastic Location Close To Transport Links & Shops
- EPC - C

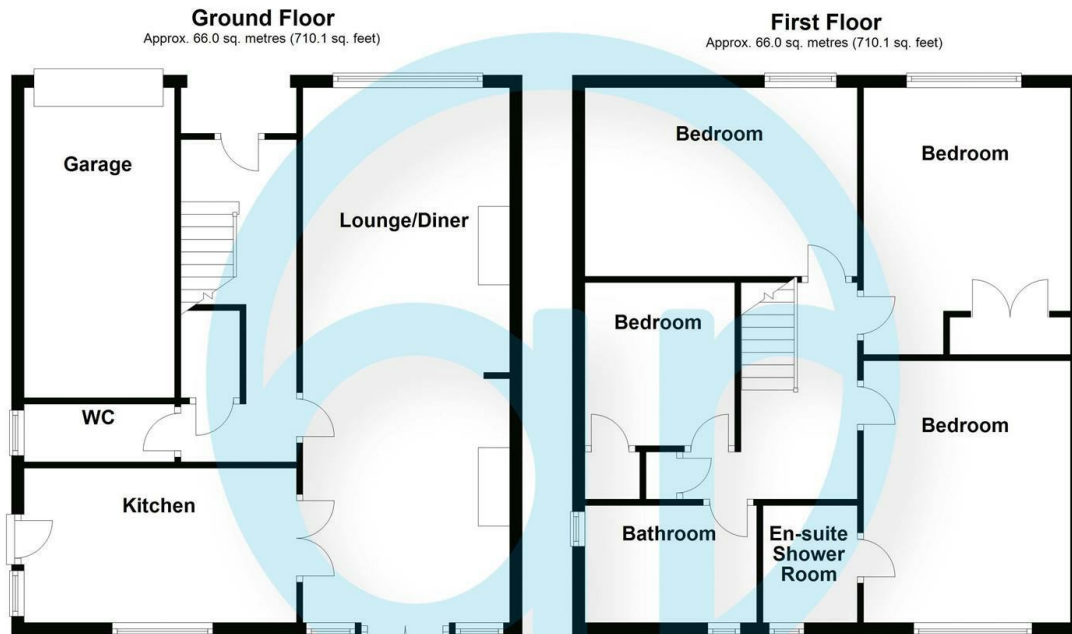

Total area: approx. 131.9 sq. metres (1420.2 sq. feet)

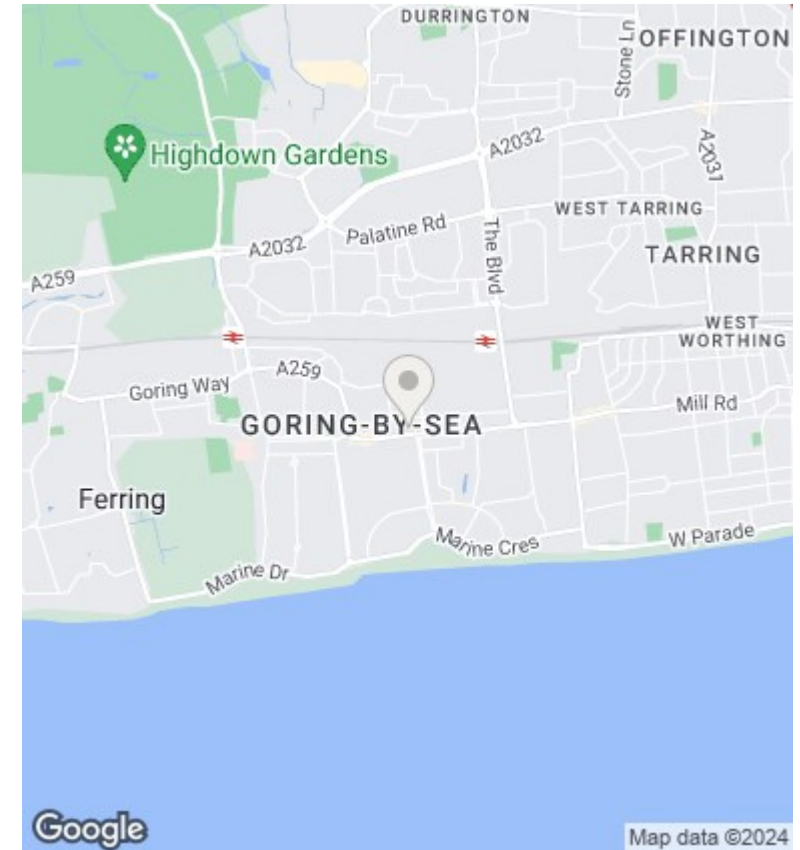

Directions

Viewings

Viewings by arrangement only. Call 01903 259961 to make an appointment.

Council Tax Band

D

EPC Rating:

C

Energy Efficiency Rating		Current	Potential
<i>Very energy efficient - lower running costs</i>			
(92 plus) A			
(81-91) B		75	86
(69-80) C			
(55-68) D			
(39-54) E			
(21-38) F			
(1-20) G			
<i>Not energy efficient - higher running costs</i>			
England & Wales		EU Directive 2002/91/EC	