



19 Devine Court

, Wishaw, ML2 7ES

£750 Per month

NEW TO THE MARKET!

A truly stunning upper apartment, modern, immaculate and unfurnished, available now!

The outstanding accommodation comprises a welcoming entrance hall, a striking dining kitchen with all integrated appliances, large bright lounge with Bay Window, 2 double bedrooms both with fitted wardrobes and a wonderful four piece bathroom suite.

Further benefitting from Gas Central Heating, Double Glazing, Secure Door Entry System, Security Alarm, Designated Parking and Communal Gardens

Devine Court is located close to central Wishaw which offers a wide range of shopping facilities, sports facilities, pubs, restaurants, bistros, and schooling. There are also excellent bus and train services linking the surrounding towns and cities, and for those commuting by car, there is access to the M74 both North and Southbound which in turn links to the M8 to Glasgow and Edinburgh.

EPC - C
CT - D
LR 1812008
LR - 1791865/320/03112

Viewing

Please contact our Pomphreys Properties Ltd Office on 01698373365 if you wish to arrange a viewing appointment for this property or require further information.

- Stunning Upper Apartment
- Modern and Immaculate throughout
- Fitted Kitchen with all white goods
- 2 Double Bedrooms with wardrobes
- Gorgeous Four Piece Bathroom suite
- Designated Parking
- Secure Door Entry System



2



1



1



Floor Plan

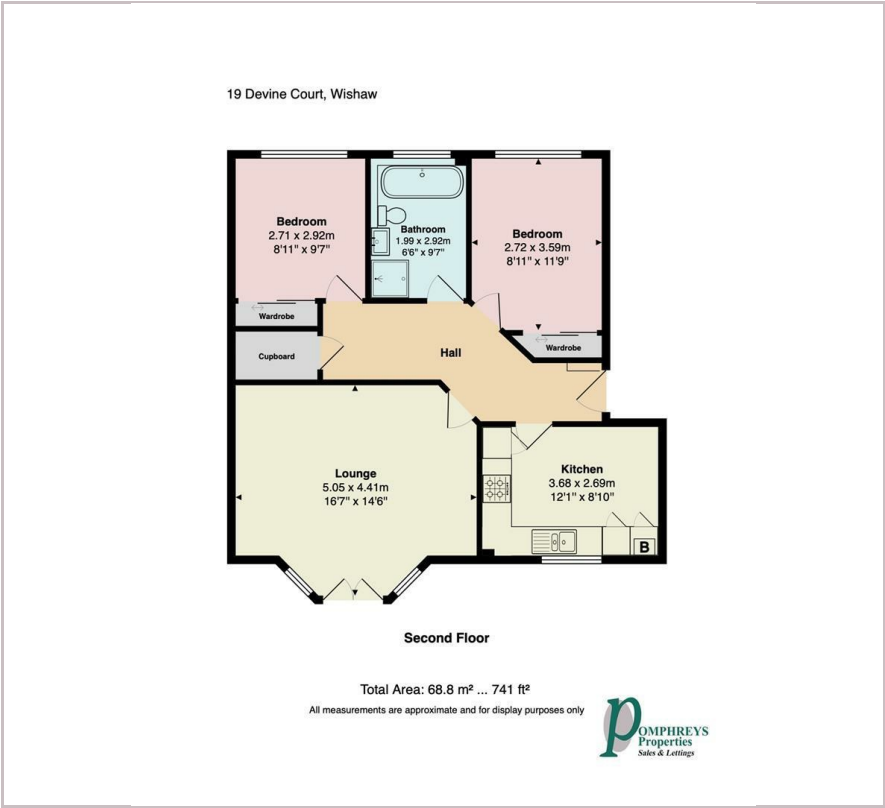

Area Map



Energy Efficiency Graph



These particulars, whilst believed to be accurate are set out as a general outline only for guidance and do not constitute any part of an offer or contract. Intending purchasers should not rely on them as statements of representation of fact, but must satisfy themselves by inspection or otherwise as to their accuracy. No person in this firms employment has the authority to make or give any representation or warranty in respect of the property.