



26 Hemmingen Court

, Carlisle, ML8 5LX

Offers over £75,000

CLOSING DATE SET!
THURSDAY 20TH JUNE AT NOON

A lovely ground floor apartment, freshly decorated and with new carpets throughout, situated a few minutes walk from Carlisle Town Centre in a small quiet cul-de-sac.

Comprising entrance hall, lounge, fitted kitchen, double bedroom and bathroom.

Further benefits include double glazing, gas central heating, rear garden and shared driveway.

EPC C.

Situated in Carlisle where all day-to-day requirements can be catered for, including various public transport links. For the commuter, the M8 and M74 motorway networks allows fast, easy access to Glasgow, Edinburgh and all points beyond.

- GROUND FLOOR APARTMENT
- FRESHLY DECORATED
- NEWLY CARPETED
- DOUBLE BEDROOM
- REAR GARDEN
- CUL-DE-SAC SITED
- OFF STREET PARKING

Viewing

Please contact our Pomphreys Properties Ltd Office on 01698373365 if you wish to arrange a viewing appointment for this property or require further information.



1



1



1



Floor Plan

26 Hemmingen Court, Carluke

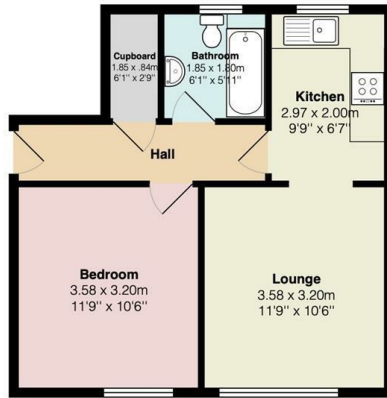

Ground Floor

Total Area: 40.2 m² ... 433 ft²

All measurements are approximate and for display purposes only



Area Map



Energy Efficiency Graph



These particulars, whilst believed to be accurate are set out as a general outline only for guidance and do not constitute any part of an offer or contract. Intending purchasers should not rely on them as statements of representation of fact, but must satisfy themselves by inspection or otherwise as to their accuracy. No person in this firm's employment has the authority to make or give any representation or warranty in respect of the property.