



Lime Tree Court

Napsbury | Hertfordshire | AL2 1UL

£335,000

FINE & COUNTRY
fineandcountry.com™

STEP INSIDE

Lime Tree Court

Step inside to find a welcoming entrance hall, a generous lounge/dining room with a Juliette balcony, a well-equipped kitchen, a large bathroom, and two comfortable double bedrooms.

This is an exceptional opportunity to enjoy stylish living in one of the area's most sought-after locations!









STEP OUTSIDE

Lime Tree Court

Napsbury Park, St Albans offers a rare blend of natural beauty and modern convenience, making it a highly sought-after location for residents. The development is set within a peaceful, parkland setting with expansive communal grounds that provide stunning green spaces for leisurely walks, outdoor activities, and relaxation.

The area's rich history, combined with its beautifully preserved architecture, creates a unique charm, making it a tranquil escape from the bustle of city life. For nature lovers, the surrounding woodland and landscaped gardens are perfect for enjoying scenic views right at your doorstep, adding to the overall sense of well-being and connection with nature.





First Floor

Approx. 65.4 sq. metres (703.6 sq. feet)

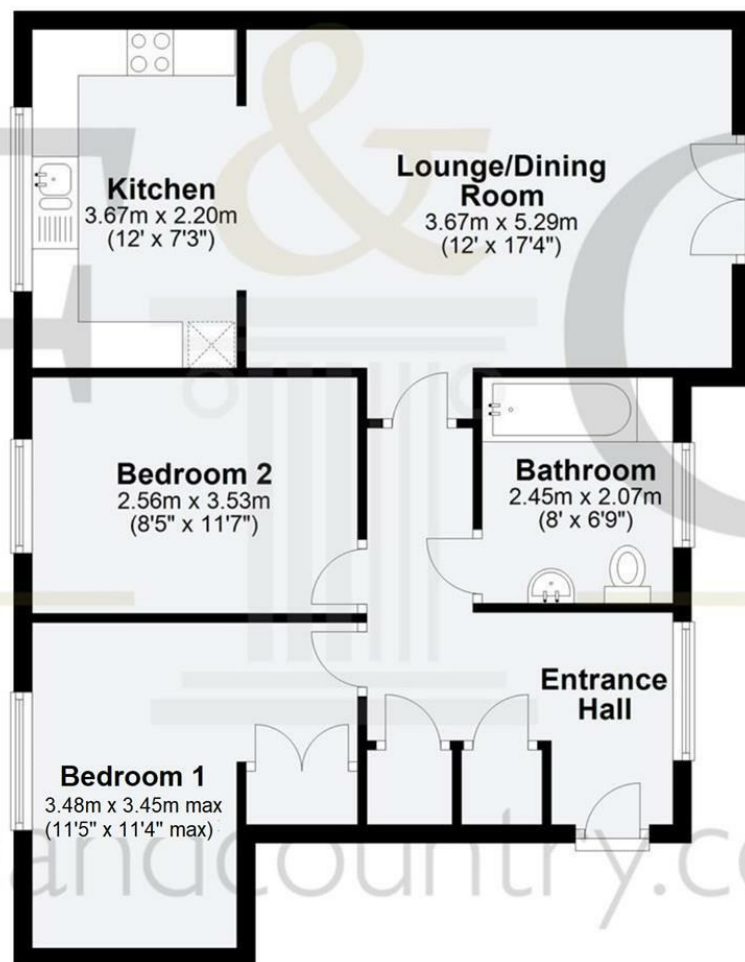

Total area: approx. 65.4 sq. metres (703.6 sq. feet)

- Two Double Bedrooms
- Large Lounge/Dining Area with Juliette Balcony
- Fully Fitted Modern White Kitchen
- Large Bathroom with Modern Three Piece Suite
- Bright & Airy Entrance Hall
- Ample Storage
- Top Floor
- Residents Parking
- Access to Napsbury Parks Beautifully Maintained Grounds

Energy Efficiency Rating		
	Current	Potential
<i>Very energy efficient - lower running costs</i>		
(92 plus) A		
(81-91) B		
(69-80) C	73	77
(55-68) D		
(39-54) E		
(21-38) F		
(1-20) G		
<i>Not energy efficient - higher running costs</i>		
England & Wales	EU Directive 2002/91/EC	

In accordance with the Consumer Protection from Unfair Trading Regulations 2008 (CPRs) and the Business Protection from Misleading Markets Regulations 2008 (BPRs) Fine & Country have prepared these property particulars as a general guide to a broad description of the property. Fine & Country as agents for the vendor or lessor and for themselves give notice that (a) these particulars are not intended to constitute part of an offer or contract (b) have not carried out a structural survey and the services, appliances and fittings have not been tested (c) all measurements, photographs, distances and floor plans referred to are given as a guide only and should not be relied upon for the purchase of fixtures and fittings (d) tenure details, service charges and ground rent (where applicable) are given as a guide only and should be checked and confirmed by your solicitor prior to exchange of contracts (e) neither the vendor nor any person in the employment of Fine & Country has any authority to make or give any representation or warranty whatsoever in respect of the property.

fineandcountry.com™

