



Highfield Lane

Tyttenhanger | Hertfordshire | AL4 0LE

FINE & COUNTRY
fineandcountry.com™

STEP INSIDE

Highfield Lane

Upon entry, you are greeted by a welcoming hallway featuring a generously sized fitted storage cupboard. The kitchen/living room exudes a bright and airy ambiance, benefiting from dual aspect windows that offer captivating views of the communal grounds.

The accommodation comprises a spacious double bedroom adorned with fitted wardrobes, accompanied by a beautifully fitted four-piece bathroom. Additionally, the property boasts a full-sized loft, providing ample storage space and potential S.T.P.P.

This exquisite, converted apartment is nestled within eight acres of meticulously manicured grounds, boasting two picturesque ponds, a tennis court, BBQ facilities, and multiple serene relaxation areas. The property offers a truly unique and idyllic setting for residents to enjoy.

The property features an allocated parking bay at the front, with additional visitor parking available within the development. The communal areas are impeccably maintained, adding to the overall appeal of the property.

Located on the east side of St Albans in the sought-after area of Tyttenhanger, this property provides convenient access to the city centre and various motorway links, ensuring ease of travel for residents.

Offered to the market with no onward chain, this property presents an enticing opportunity for prospective buyers.









STEP OUTSIDE

Highfield Lane

St. Albans, nestled in the picturesque Hertfordshire countryside, exudes a captivating blend of rich history, cultural vibrancy, and modern amenities. This charming city, located just a stone's throw away from London, boasts a heritage that dates back over two millennia, making it one of the oldest settlements in England. Its name is derived from the first British saint, Saint Alban, who was martyred here in the 3rd century AD.

Walking through the streets of St. Albans is like embarking on a journey through time. The city's crowning jewel is undoubtedly the magnificent St. Albans Cathedral, a stunning example of Norman architecture that dominates the skyline with its soaring spire. This architectural marvel, founded in the 8th century, stands as a testament to the city's enduring spiritual significance and serves as a focal point for both locals and visitors alike.

Beyond its religious heritage, St. Albans boasts a wealth of historical landmarks and attractions. The Verulamium Park, once the site of a thriving Roman settlement known as Verulamium, offers a tranquil retreat amidst lush greenery and ancient ruins. Here, visitors can wander through the remains of Roman walls, explore the fascinating Verulamium Museum, and enjoy leisurely strolls along the serene lakeside paths.

The city's vibrant town centre is alive with an eclectic mix of boutique shops, quaint cafes, and bustling markets, offering something to delight every visitor. From browsing the stalls at the historic St. Albans Charter Market to indulging in gourmet delights at the renowned St. Albans Food and Drink Festival, there's no shortage of culinary and cultural experiences to savour. With its bustling atmosphere and friendly locals, St. Albans effortlessly combines the charm of a historic market town with the sophistication of a modern city, making it a truly captivating destination for all who visit.





Highfield Hall

Approx. 60.3 sq. metres (649.0 sq. feet)

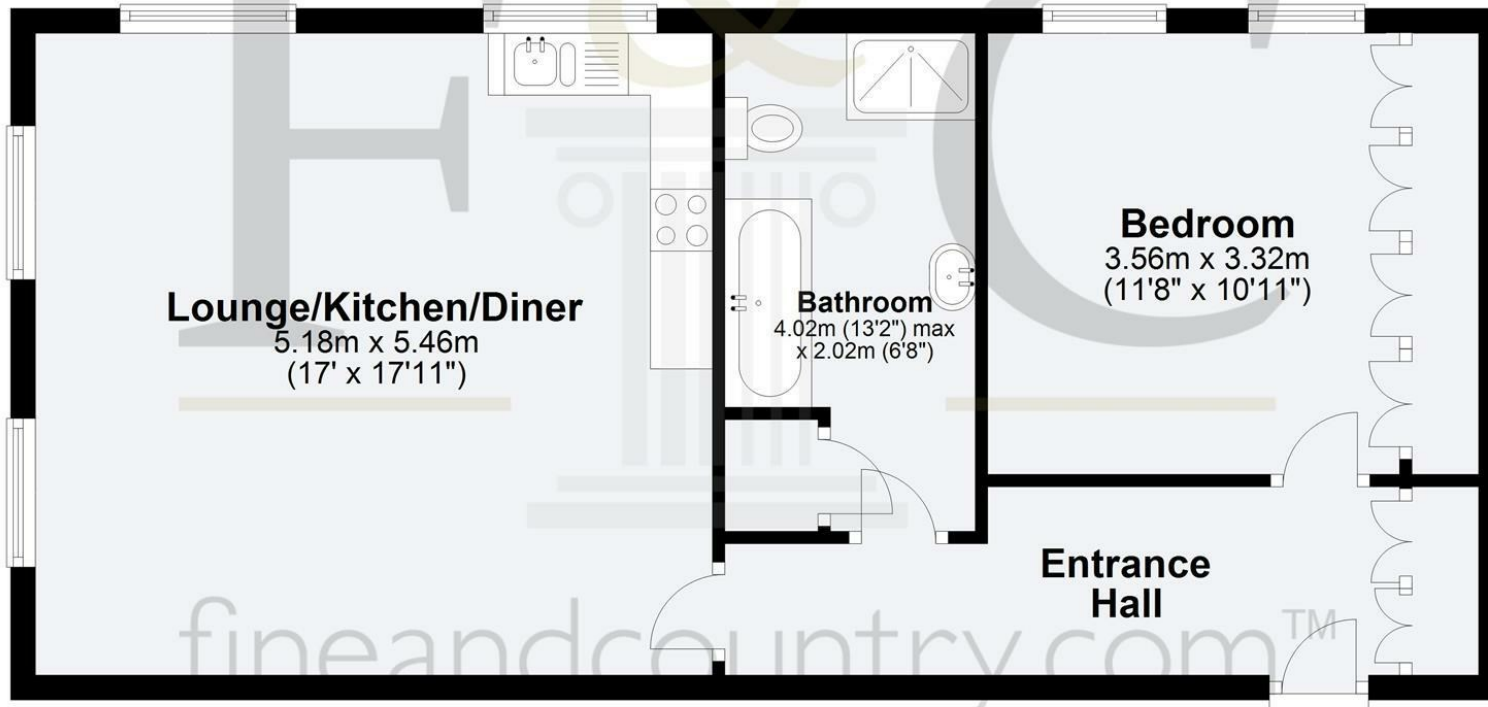

Total area: approx. 60.3 sq. metres (649.0 sq. feet)

Energy Efficiency Rating		
	Current	Potential
<i>Very energy efficient - lower running costs</i>		
(92 plus) A		
(81-91) B		81
(69-80) C		
(55-68) D	55	
(39-54) E		
(21-38) F		
(1-20) G		
<i>Not energy efficient - higher running costs</i>		
England & Wales	EU Directive 2002/91/EC	

In accordance with the Consumer Protection from Unfair Trading Regulations 2008 (CPRs) and the Business Protection from Misleading Markets Regulations 2008 (BPRs) Fine & Country have prepared these property particulars as a general guide to a broad description of the property. Fine & Country as agents for the vendor or lessor and for themselves give notice that (a) these particulars are not intended to constitute part of an offer or contract (b) have not carried out a structural survey and the services, appliances and fittings have not been tested (c) all measurements, photographs, distances and floor plans referred to are given as a guide only and should not be relied upon for the purchase of fixtures and fittings (d) tenure details, service charges and ground rent (where applicable) are given as a guide only and should be checked and confirmed by your solicitor prior to exchange of contracts (e) neither the vendor nor any person in the employment of Fine & Country has any authority to make or give any representation or warranty whatsoever in respect of the property.

fineandcountry.com™

