



£275,000

3 Bedroom Semi-Detached House for sale
18 Furlong Lane, Alrewas, Burton-on-Trent



EweMove
SALES AND LETTINGS



Overview

ENQUIRE 24/7 VIA OUR EWEMOVE WEBSITE. Enjoying a lovely setting within the highly regarded village of Alrewas, is this beautifully presented two bedroom property with an attic room. The open plan kitchen/living area is a great entertaining space and the garden is quiet and secluded.



Key Features

- Chain Free
- 2 Bed plus Converted Attic Room with Fixed Staircase
- Open plan dining kitchen with integral appliances
- Pleasant garden with brick outbuilding
- Gas central heating and UPVC double glazing
- Highly sought after village setting
- Close to Excellent Local Amenities
- Walking distance to local primary school
- John Taylor Catchment
- Call NOW 24/7 or book instantly online to View





To the front of the property is a useful entrance porch where you can kick off your shoes before entering the open plan living space to the ground floor.

The modern spacious kitchen is fully fitted with integrated appliances including a fridge, freezer, double oven, gas hob, dishwasher and washing machine. French doors open out to the low maintenance private rear garden which includes a useful brick outbuilding.

To the first floor there is a modern fitted family bathroom which includes a white suite with a bath with a shower over. There is a double bedroom to the rear, and a small double bedroom/office to the front aspect which has a charming feature fireplace.

The second floor is home to the converted attic which is currently being used as the master bedroom* with feature character beams and a Velux style window.

This home is perfectly placed to take advantage of village facilities including the highly regarded All Saints Primary school which feeds into the John Taylor High school in Barton-Under-Needwood, this truly represents an excellent opportunity.

Alrewas village boasts a good range of local shops including hairdressers, take-aways, choice of pubs and restaurants, and is well placed for the A38 with links to Lichfield, Burton upon Trent, Tamworth and the M5.

Viewing essential to appreciate the space and quality of accommodation on offer. Enquire 24/7 via our EweMove website.

Floorplans

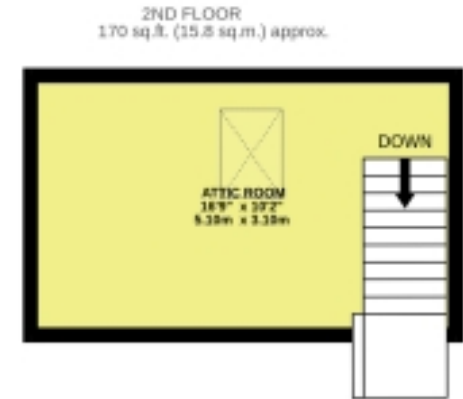
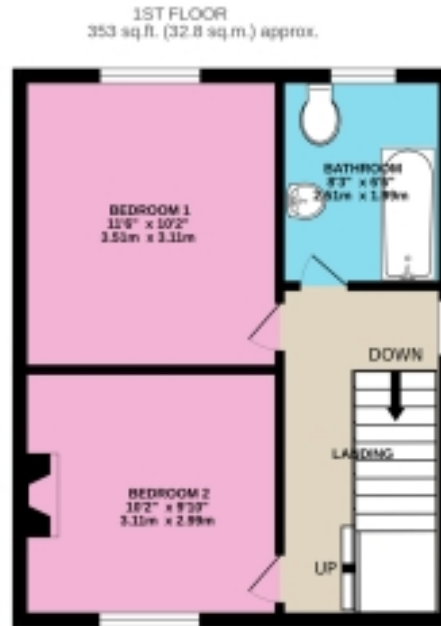

TOTAL FLOOR AREA : 906 sq.ft. (84.1 sq.m.) approx.

Whilst every attempt has been made to ensure the accuracy of the floorplan contained here, measurements of doors, windows, rooms and any other items are approximate and no responsibility is taken for any error, omission or mis-statement. This plan is for illustrative purposes only and should be used as such by any prospective purchaser. The services, systems and appliances shown have not been tested and no guarantee as to their operability or efficiency can be given.
Made with Metroix ©2024

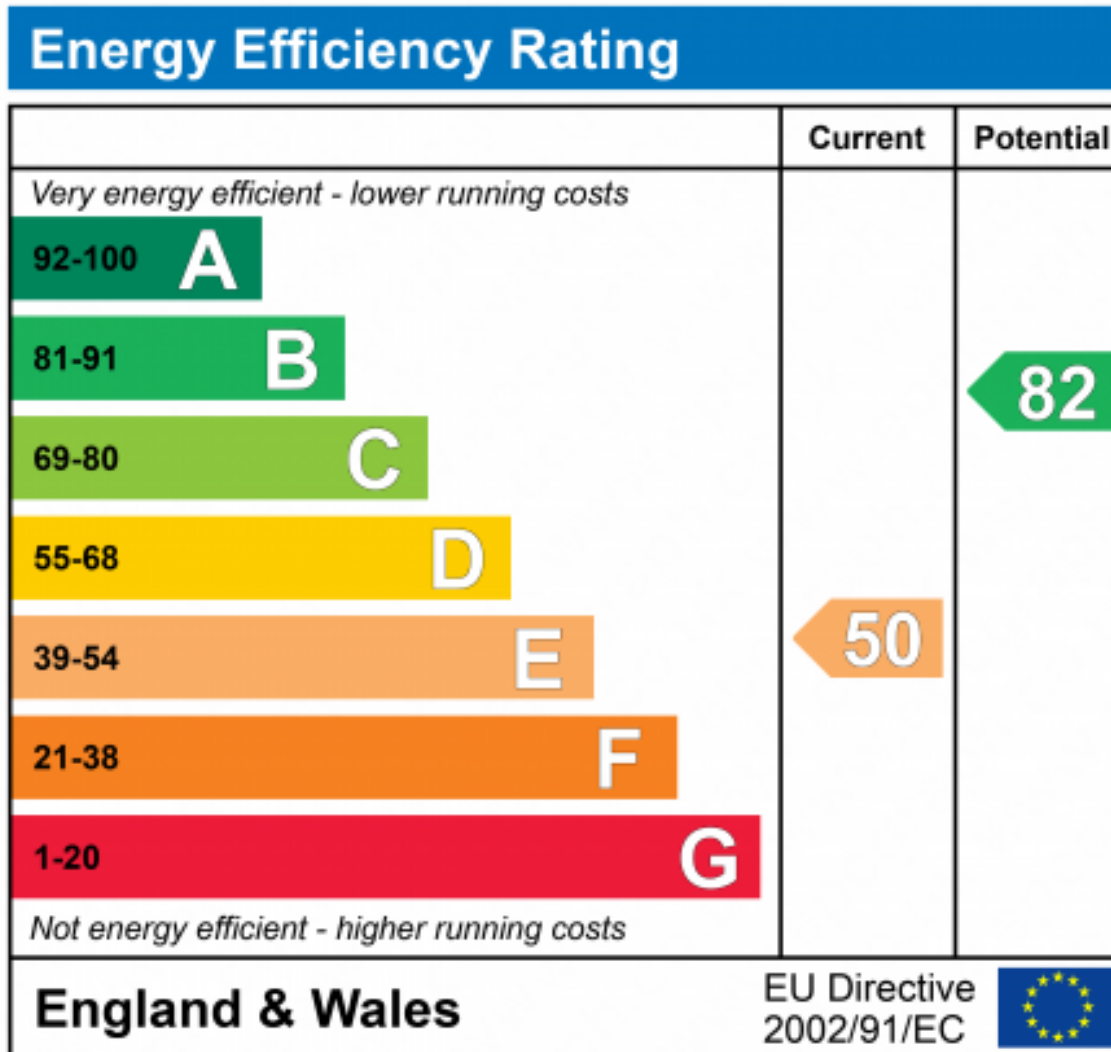

Marketed by EweMove Barton-Under-Needwood

01283 247076 (24/7)
barton@ewemove.com

