



1 Beds, Flat, Leasehold, £79,950

Milton Close

3EA - Three Estate Agents are delighted to offer this, one bedroom, ground floor flat with a long term tenant located in the popular location of Beddau.

Features

- INVESTMENT OPPORTUNITY
- FRONT GARDEN & REAR GARDENS
- OPEN PLAN LOUNGE/KITCHEN/DINER
- OFF ROAD PARKING
- TENANT IN SITU

3EA â Three Estate Agents are delighted to offer this, one bedroom, ground floor flat with a long term tenant located in the popular location of Beddau.

The property benefits form an open plan, lounge/kitchen/diner with laminate flooring, modern flitted kitchen with white goods.

There is a large double bedroom and a separate bathroom with shower over bath.

There are also front and rear gardens and off road parking with this property.

This is an ideal investment as there is already a tenant in situ who wishes to remain long term.

If you are interested then please call today to arrange a suitable day and time to view.



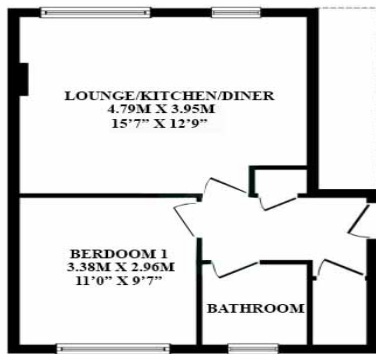

GROUND FLOOR

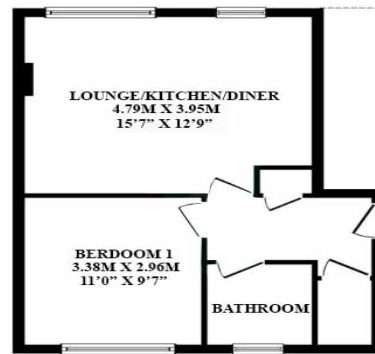

GROUND FLOOR